

NO. 10
 DATE CHECKED
 SURVEY
 ORIGINAL

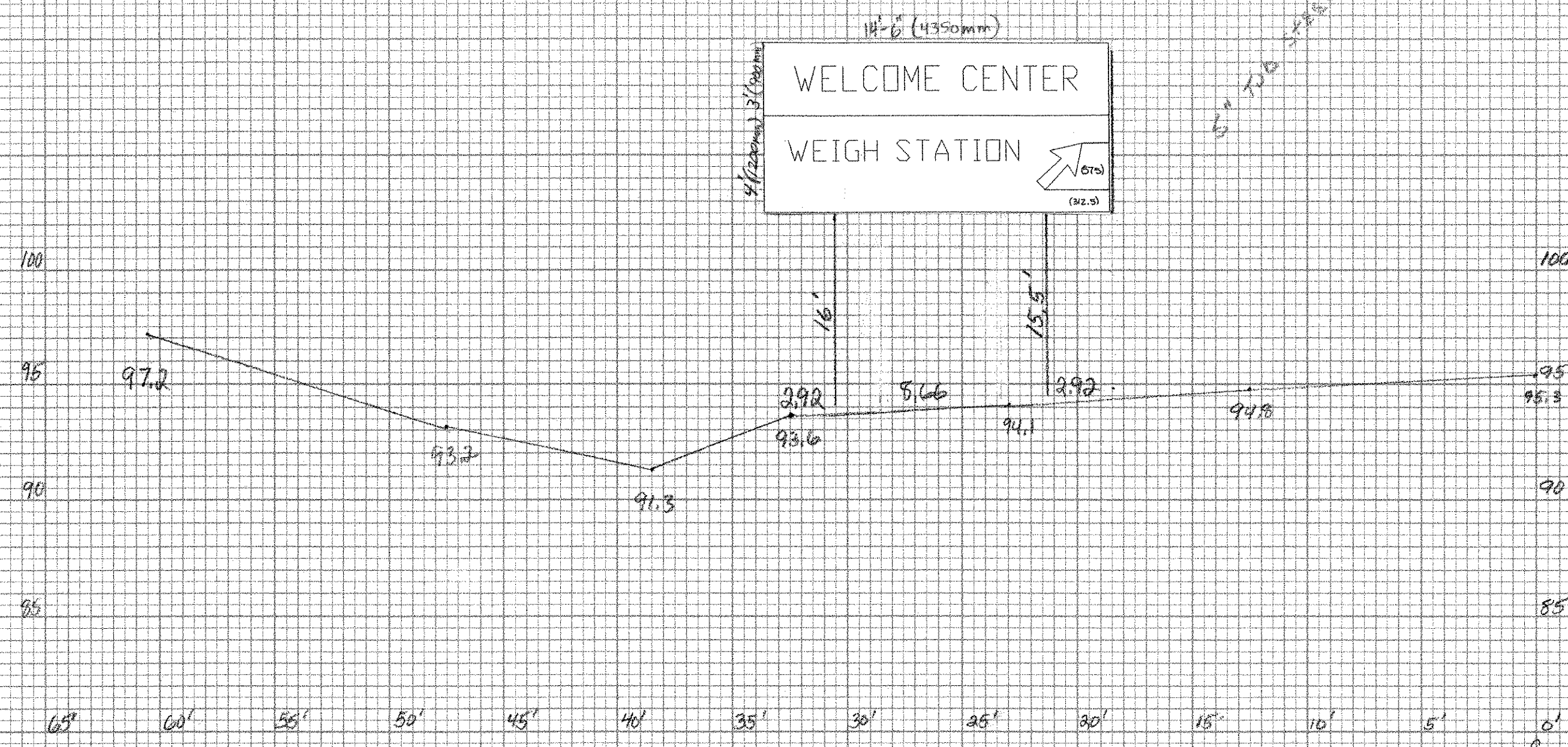

53'-0" (16154mm)
 18" DIA
 5" DIA
 WELCOME CTR
 WEIGH STA

NO. 10
 DATE CHECKED
 SURVEY
 ORIGINAL

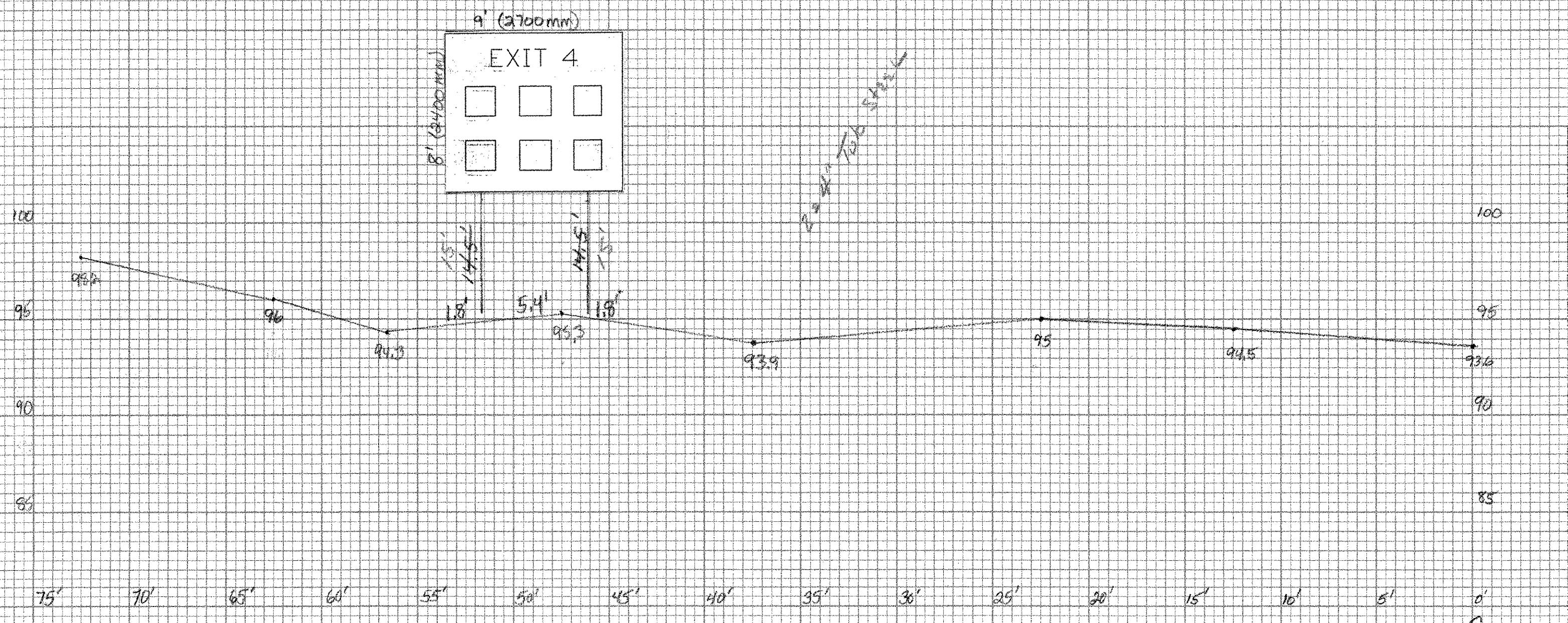

53'-0" (16154mm)
 18" DIA
 5" DIA
 Signs for Road
 EXIT

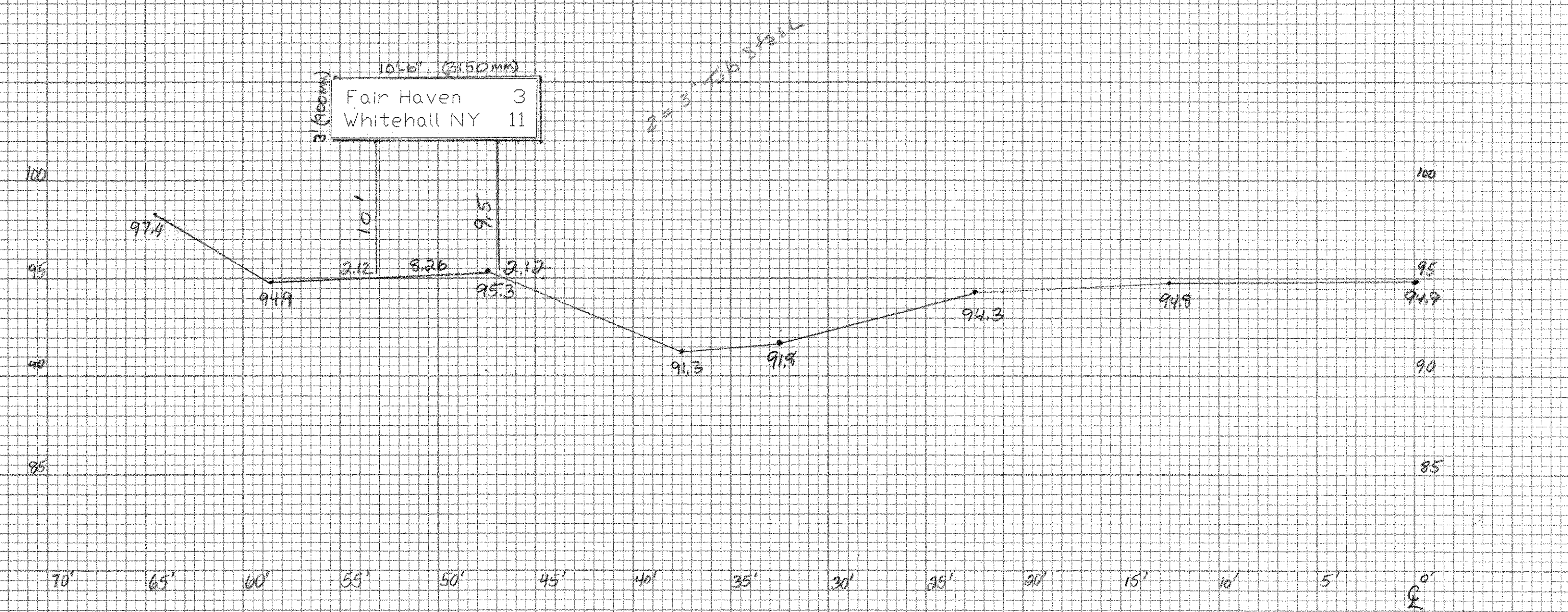

NEW STA 7+602 LT
 18" DIA
 3" DIA GREN