

- 646.415 DURABLE 150 mm YELLOW LINE
- STA. 30+060.000 - STA. 30+287.854 SOLID LINE 3.6 m RT
- STA. 30+200.000 - STA. 30+287.854 SOLID LINE (ON-RAMP)
- 646.615 TEMPORARY 150 mm YELLOW LINE
- STA. 30+060.000 - STA. 30+287.854 SOLID LINE 3.6 m RT
- STA. 30+200.000 - STA. 30+287.854 SOLID LINE (ON-RAMP)
- 676.10 DELINEATOR WITH STEEL POSTS
- STA. 30+200.000 - STA. 30+280.000 LT (7 EA)
- 676.12 REMOVAL OF EXISTING DELINEATORS
- STA. 30+200.000 - STA. 30+280.000 LT (7 EA)
- 646.42 DURABLE 200 mm WHITE LINE
- STA. 30+124.000 - STA. 30+184.000 C (GORE STRIPING)
- STA. 30+184.000 - STA. 30+200.000 C & LT (GORE STRIPING)
- 646.62 TEMPORARY 200 mm WHITE LINE
- STA. 30+124.000 - STA. 30+184.000 C (GORE STRIPING)
- STA. 30+184.000 - STA. 30+200.000 C & LT (GORE STRIPING)

- 646.414 DURABLE 150 mm WHITE LINE
- S=SOLID, D=DASHED
- STA. 30+060.000 - STA. 30+124.000 LT - C - RT
- STA. 30+060.000 - STA. 30+184.000 S - D -
- STA. 30+184.000 - STA. 30+287.854 SOLID LINE (ON-RAMP) S - S -
- STA. 30+200.000 - STA. 30+287.854 - S -
- 646.614 TEMPORARY 150 mm WHITE LINE
- S=SOLID, D=DASHED
- STA. 30+060.000 - STA. 30+124.000 LT - C - RT
- STA. 30+060.000 - STA. 30+184.000 S - D -
- STA. 30+184.000 - STA. 30+287.854 SOLID LINE (ON-RAMP) S - S -
- STA. 30+200.000 - STA. 30+287.854 - S -

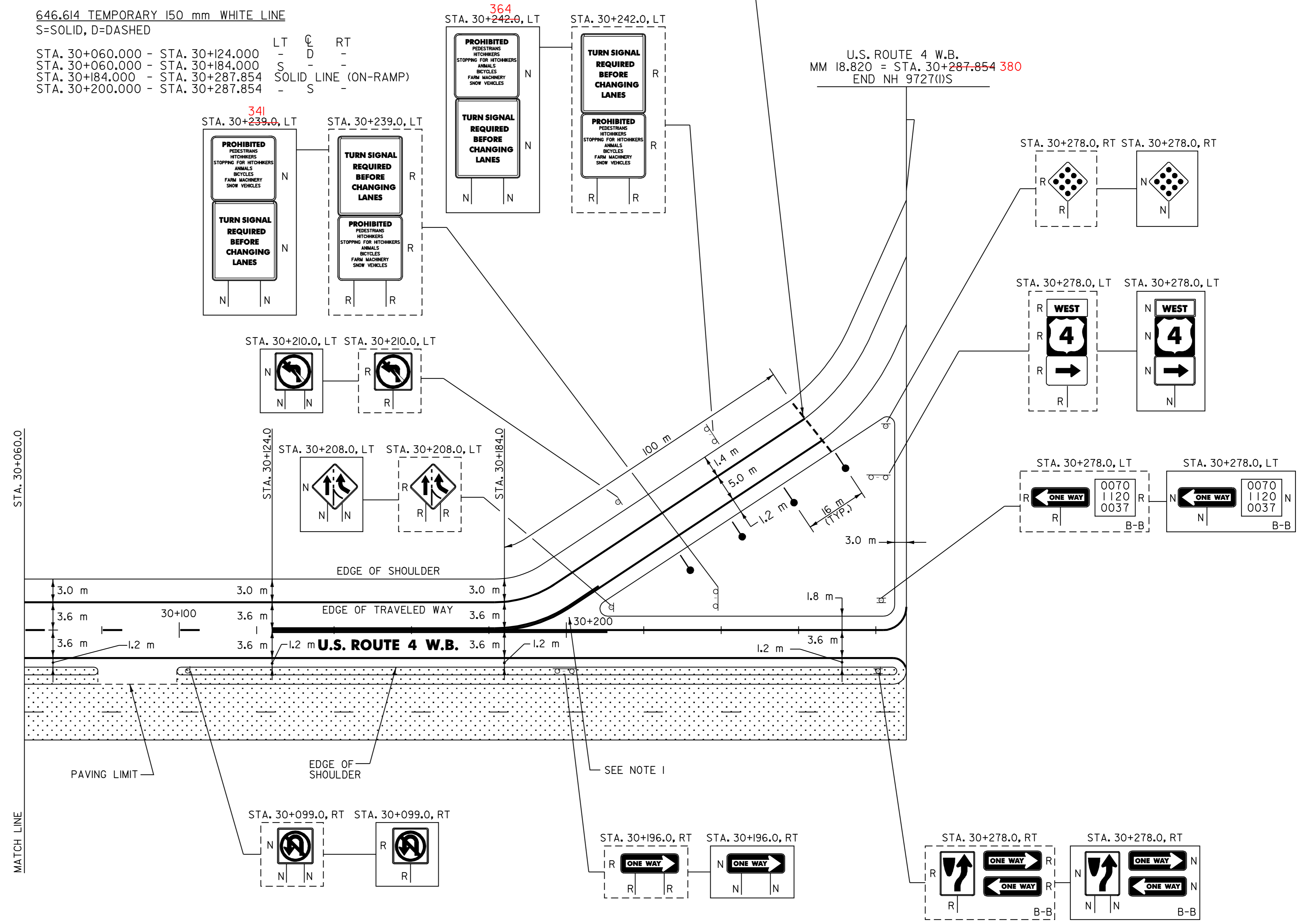

- LEGEND**
- TYPE I (AMBER)
  - TYPE I (WHITE)
  - TYPE II
  - TYPE III (AMBER)
  - TYPE III (WHITE)

NOTE:  
I. REFER TO STANDARD SHEETS E-197M TO E-199M FOR DELINEATOR DETAILS.

- SIGN LEGEND**
- R= REMOVE
  - S= SALVAGE
  - N= NEW
  - RET= RETAIN
  - B-B= BACK TO BACK
  - EXISTING= - - - - -
  - NEW= \_\_\_\_\_

SHADED AREA IS NOT PAVED AS PART OF THIS PROJECT

DATUM	
VERTICAL	N/A
HORIZONTAL	N/A

**INTERSECTION WITH U.S. ROUTE 7 DETAIL SHEET**

SURVEYED BY	N/A	DATE	N/A
DRAWN BY	T.J.B.	DATE	8/98
SQUAD LEADER	T.P.K.		
DESIGN FILE NO.	/pave/96bl54/pbl54.dgn		
IPARM FILE	pbl54d09.i	DATE PLOTTED	N/A
PROJ. NAME	FAIR HAVEN - RUTLAND		
PROJ. NO.	NH 9727(I)S		
SHEET	37 OF 119	SHEETS	