

646.415 DURABLE 150 mm YELLOW LINE

STA. 6+400.000 - STA. 8+000.000 SOLID LINE 3.6 m RT

646.414 DURABLE 150 mm WHITE LINE

S=SOLID, D=DASHED

STA. 6+400.000 - STA. 8+000.000 LT
 STA. 6+400.000 - STA. 8+000.000 SOLID LINE 3.6 m LT

675.50 REMOVING SIGNS

AS SHOWN - 10

646.615 TEMPORARY 150 mm YELLOW LINE

STA. 6+400.000 - STA. 8+000.000 SOLID LINE 3.6 m RT

646.614 TEMPORARY 150 mm WHITE LINE

S=SOLID, D=DASHED

STA. 6+400.000 - STA. 8+000.000 LT
 STA. 6+400.000 - STA. 8+000.000 SOLID LINE 3.6 m LT

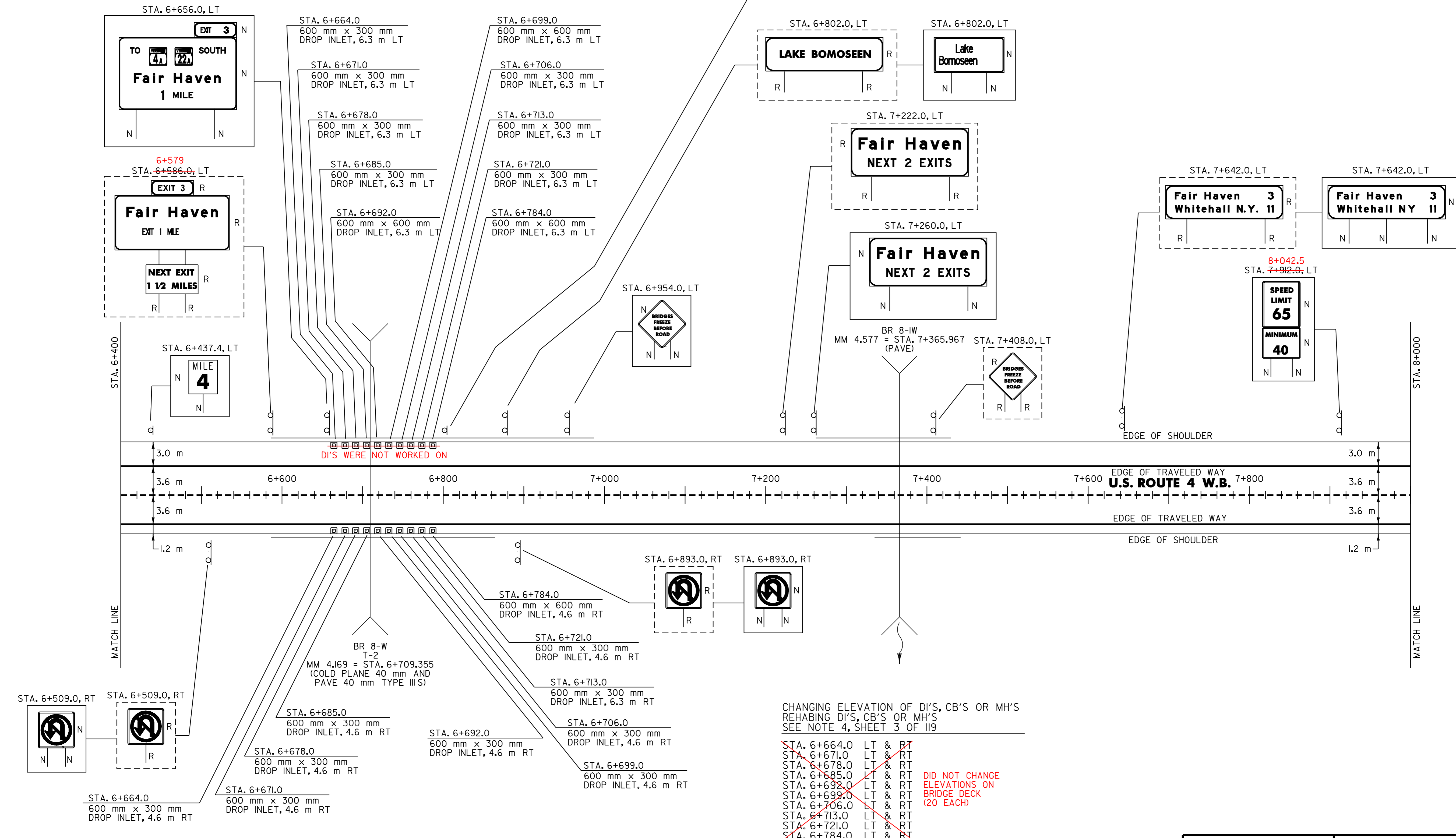

CHANGING ELEVATION OF DI'S, CB'S OR MH'S
 REHABING DI'S, CB'S OR MH'S
 SEE NOTE 4, SHEET 3 OF 119

- ~~STA. 6+664.0 LT & RT~~
 - ~~STA. 6+671.0 LT & RT~~
 - ~~STA. 6+678.0 LT & RT~~
 - ~~STA. 6+685.0 LT & RT~~
 - ~~STA. 6+692.0 LT & RT~~
 - ~~STA. 6+699.0 LT & RT~~
 - ~~STA. 6+706.0 LT & RT~~
 - ~~STA. 6+713.0 LT & RT~~
 - ~~STA. 6+721.0 LT & RT~~
 - ~~STA. 6+784.0 LT & RT~~
- DID NOT CHANGE ELEVATIONS ON BRIDGE DECK (20 EACH)

621.20 STEEL BEAM GUARDRAIL

7+306.5 STA. 7+262.1 - STA. 7+418.5 LT (156.4 m) 7+420.5
 7+330.7 STA. 7+334.9 - STA. 7+430.5 RT (95.6 m) 7+441.2

621.54 MODIFIED ECCENTRIC LOADER TERMINAL

420 STA. 7+418.5 - STA. 7+429.9 LT 7+431.9
 441 STA. 7+430.5 - STA. 7+441.9 RT 7+452.2

621.60 ANCHOR FOR STEEL BEAM RAIL

STA. 7+262.7 LT 7+302
 STA. 7+335.5 RT 7+326

621.80 REMOVAL AND DISPOSAL OF GUARDRAIL

7+312 STA. 7+328.0 - STA. 7+426.0 LT (98.0 m) 7+422
 7+328 STA. 7+342.0 - STA. 7+438.0 RT (96.0 m) 7+451

SIGN LEGEND
 R= REMOVE
 S= SALVAGE
 N= NEW
 RET= RETAIN
 B-B= BACK TO BACK
 EXISTING= - - - - -
 NEW= _____

PAVING PROJECT LAYOUT

SURVEYED BY N/A DATE N/A
 DRAWN BY J.N. DATE 8/98
 SQUAD LEADER T.P.K.

DESIGN FILE NO. /pave/96bl54/pbl54.dgn
 IPARM FILE pbl54i05.i DATE PLOTTED N/A

PROJ. NAME FAIR HAVEN - RUTLAND
 PROJ. NO. NH 9727(1)S
 SHEET 16 OF 119 SHEETS

DATUM	
VERTICAL	N/A
HORIZONTAL	N/A