

MAINLINE APPROACH AREA DETAIL

U.S. ROUTE 4 STA. 0+016.093 - BEGIN OVERLAY
 U.S. ROUTE 4 W.B. STA. 29+567.096 - STOP OVERLAY
 U.S. ROUTE 4 W.B. STA. 29+576.296 - RESUME OVERLAY
 U.S. ROUTE 4 W.B. STA. 30+287.854 - END OVERLAY

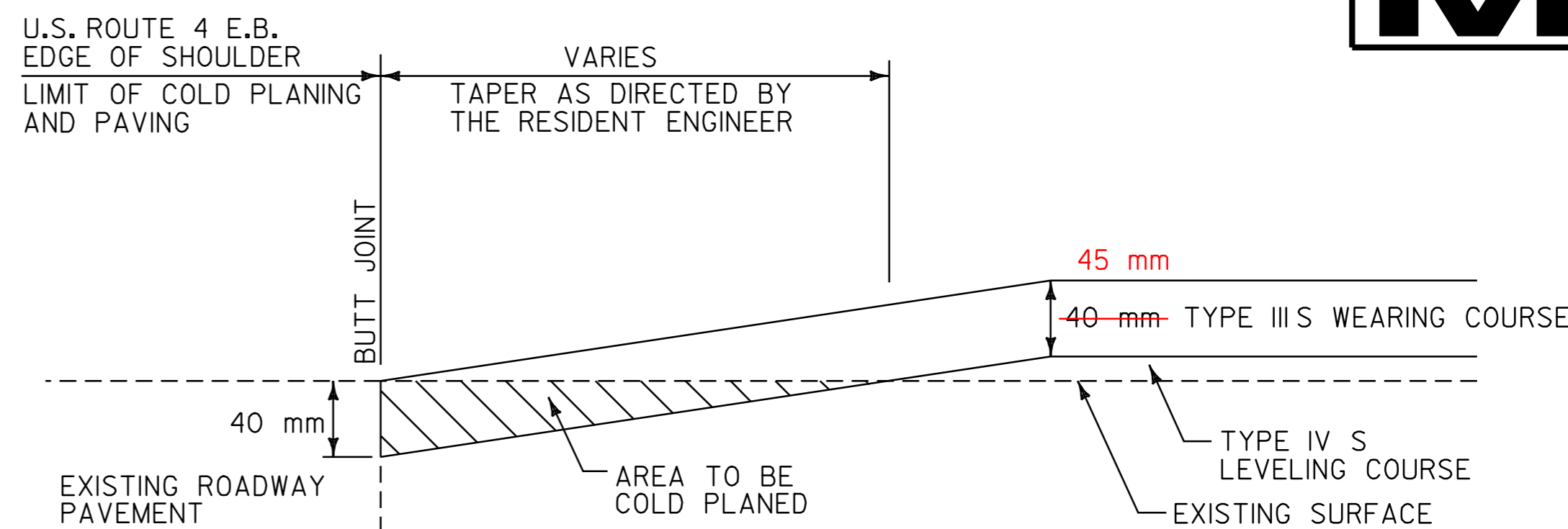

U-TURN APPROACH AREA DETAIL

U-TURN LOCATIONS

STA. 1+941.000	STA. 16+573.000
STA. 3+547.000	STA. 18+477.000
STA. 5+018.000	STA. 20+805.000
STA. 6+497.000	STA. 23+375.000
STA. 6+881.000	STA. 24+367.000
STA. 8+177.000	STA. 26+531.000
STA. 9+397.000	STA. 28+044.000
STA. 12+130.000	STA. 28+602.000
STA. 13+045.000	STA. 29+553.000
STA. 14+519.000	STA. 30+095.000

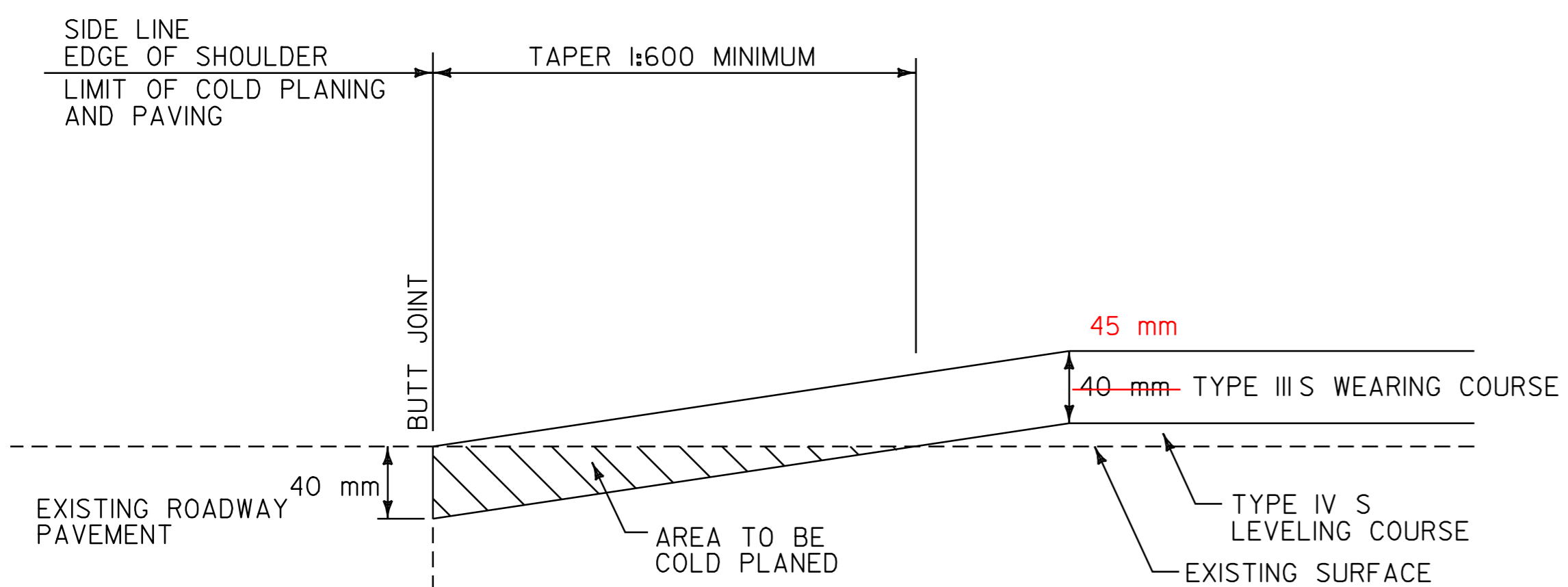

RAMP APPROACH AREA DETAIL

INTERCHANGE 1, VT. ROUTE 4A - STA. 100+015.000
 INTERCHANGE 2, RAMP "G" - STA. 60+483.000
 INTERCHANGE 2, RAMP "H" - STA. 60+000.000
 INTERCHANGE 3, RAMP "L" - STA. 60+375.000
 INTERCHANGE 4, RAMP "Q" - STA. 60+418.000
 INTERCHANGE 4, RAMP "R" - STA. 60+000.000
 INTERCHANGE 5, RAMP "B" - STA. 60+000.000
 INTERCHANGE 5, RAMP "C" - STA. 60+273.500
 INTERCHANGE 6, RAMP "C" - STA. 60+000.000
 INTERCHANGE 6, RAMP "D" - STA. 60+350.000
 INTERCHANGE 6, RAMP "E" - STA. 60+000.000
 INTERCHANGE 6, RAMP "F" - STA. 60+045.000

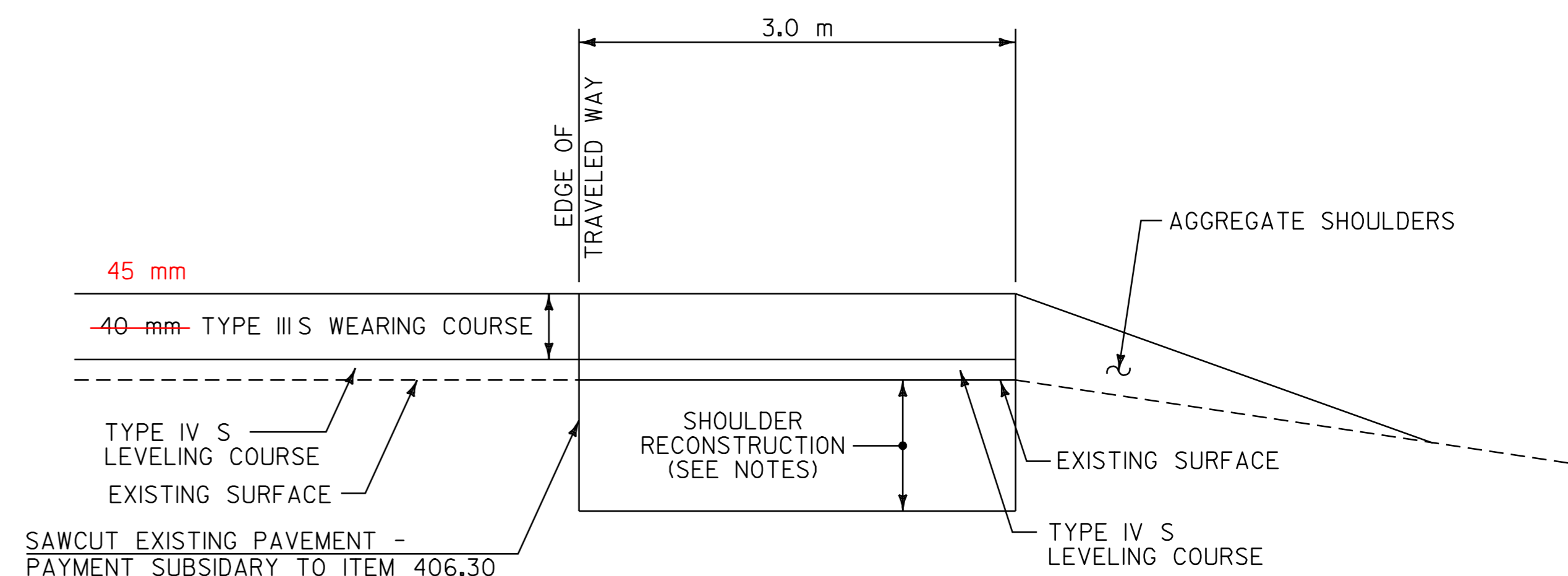

SHOULDER RECONSTRUCTION AREA DETAIL

U.S. ROUTE 4 W.B. STA. 0+380.000 LT - BEGIN SHOULDER RECONSTRUCTION
 U.S. ROUTE 4 W.B. BR 3-W STA. 1+111.000 LT - STOP SHOULDER RECONSTRUCTION
 U.S. ROUTE 4 W.B. BR 3-W STA. 1+185.000 LT - RESUME SHOULDER RECONSTRUCTION
 U.S. ROUTE 4 W.B. STA. 1+275.000 LT - END SHOULDER RECONSTRUCTION

NOTES:

- THE SHOULDER RECONSTRUCTION SHALL BE CONSTRUCTED BY PLACING 2-65 mm TYPE 1S BASE COURSE LIFTS. PAYMENT UNDER 406.30 SUPERPAVE BITUMINOUS CONCRETE PAVEMENT (PG 58-28).
- EXISTING SHOULDER PAVEMENT SHALL BE REMOVED UNDER ITEM 203.28, EXCAVATION OF SURFACES AND PAVEMENTS. ALL OTHER EXCAVATION ASSOCIATED WITH THE SHOULDER EXCAVATION SHALL BE PERFORMED UNDER ITEM 203.15, COMMON EXCAVATION.
- EMULSIFIED ASPHALT SHALL BE APPLIED ON ALL EXISTING PAVEMENT SURFACES, AND BETWEEN ALL COURSES OF PAVEMENT AT THE RATE OF 0.70 L/m² OR AS DIRECTED BY THE RESIDENT ENGINEER.

DATUM	
VERTICAL	N/A
HORIZONTAL	N/A

PAVING DETAILS SHEET

SURVEYED BY	N/A	DATE	N/A
DRAWN BY	E.C.D.	DATE	8/98
SQUAD LEADER	T.P.K.		
DESIGN FILE NO.	/pave/96b154/pb154.dgn		
IPARM FILE	pb154d01.i	DATE PLOTTED	N/A
PROJ. NAME	FAIR HAVEN - RUTLAND		
PROJ. NO.	NH 9727(I)S		
SHEET	5	OF 119	SHEETS