

⑥ STA. 375+54 LT : END 2" PE MAIN W/2" PURGE PT. CAP. LOCATOR BOX W/WIRE OVER END. 9/20/88.

STA. 375+42.5--378+16.5 LT : PROPOSED NEW 2" PE DRISCO 8100 GAS. BUTT FUSION JOINTS.
 STA. 377+82.5 21.5'LT--55'LT : PROPOSED NEW 2" PE DRISCO 8100 GAS. BUTT FUSION JOINTS UNLESS OTHERWISE STATED.
 STA. 375+54--377+81 LT : EXIST. 2" PE DRISCO 8100 GAS TO BE RETIRED. INST. 9/20/88.
 STA. 377+81--377+84 24.5'LT : EXIST. 2" X TRU STEEL SCH. 40 GAS TO BE RETIRED. INST. 1/11/85.
 STA. 377+82.5 22.5'LT--24.5'LT : EXIST. 2" X TRU STEEL SCH. 40 GAS TO BE RETIRED. INST. 1/11/85.
 STA. 377+81.5 0'LT--377+82.5 19.5'LT--22.5'LT : EXIST. 2" X TRU STEEL SCH. 40 GAS TO REMAIN IN PLACE. INST. 1/11/85. WELD JOINTS.

⑦ STA. 377+82.5 24.5'LT : EXIST. 2"x2"x2" WELD STEEL TEE--1/11/85. 1'6" NORTH OF TEE--END EXIST. 2" STEEL MAIN W/3/8" WELD DISC--1/11/85. 1'6" SOUTH OF TEE--TIED-IN TO EXIST. 2" STEEL GAS INST. 1/11/85 W/2" STRAP. POST & 2" STEEL-PE TRANS. FIT.--INST. NEW 2" PE GAS SOUTH ON 9/20/88. LOCATOR BOX W/WIRE OVER TIE-IN.

DIRECTIONAL BORE NEW 2" PE ROAD X-ING OR REUSE EXIST. 2" STEEL. TO BE DETERMINED IN FIELD.

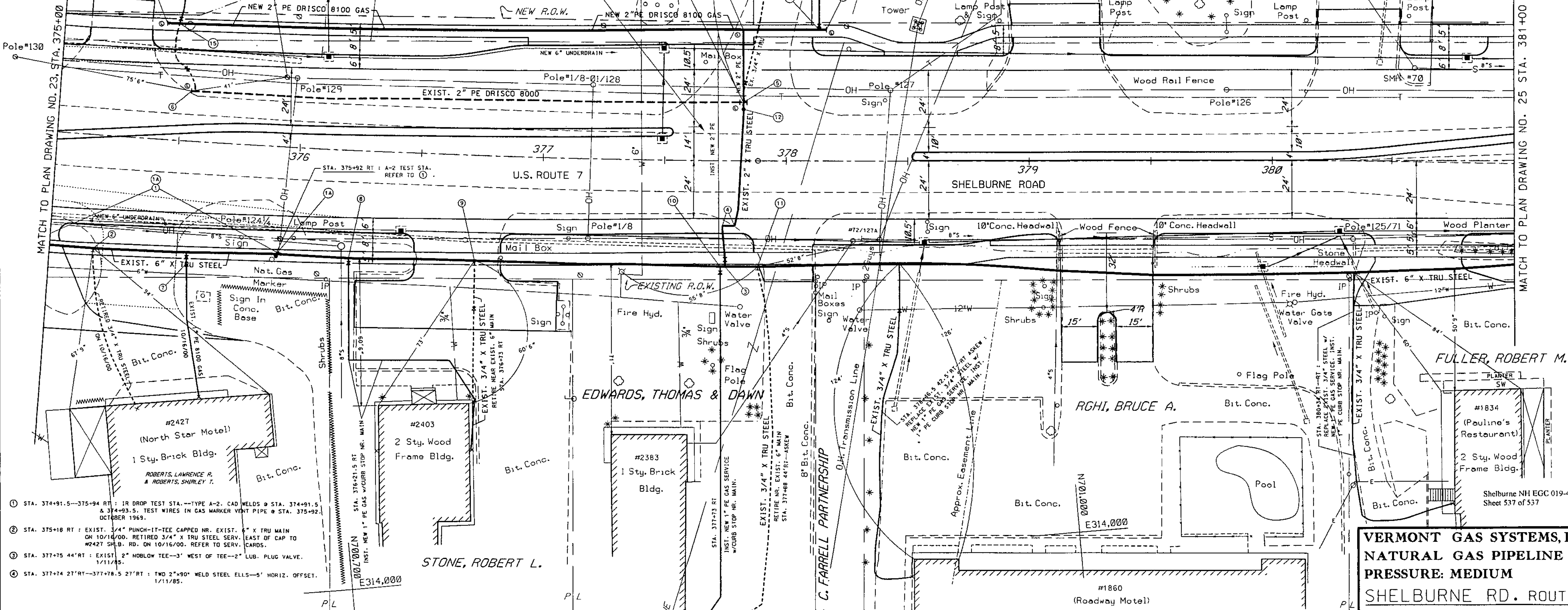

① STA. 374+91.5--375+94 RT : 1/2 DROP TEST STA.--TYPE A-2. CAD WELDS @ STA. 374+91.5 & 374+93.5. TEST WIRES IN GAS MARKER VENT PIPE @ STA. 375+92. OCTOBER 1969.
 ② STA. 375+18 RT : EXIST. 3/4" PUNCH-IT-TEE CAPPED NR. EXIST. 6" X TRU MAIN ON 10/16/00. RETIRED 3/4" X TRU STEEL SERV. EAST OF CAP TO #2427 SHEL. RD. ON 10/16/00. REFER TO SERV. CARDS.
 ③ STA. 377+75 44'RT : EXIST. 2" HOBLOW TEE--3' WEST OF TEE--2" LUB. PLUG VALVE. 1/11/85.
 ④ STA. 377+74 27'RT--377+78.5 27'RT : TWO 2"x90" WELD STEEL ELLS--5' HORIZ. OFFSET. 1/11/85.

STA. 375+00--377+73 RT : EXIST. 6" X TRU STEEL .188 W.T. GAS TO BE LOWERED. INST. 10/69 W/WELD JOINTS.
 STA. 377+73--377+75 RT : EXIST. 6" X TRU STEEL .188 W.T. GAS TO REMAIN IN PLACE. INST. 10/69 W/WELD JOINTS.
 STA. 377+75--378+30 RT : EXIST. 6" X TRU STEEL .188 W.T. GAS TO BE LOWERED. INST. 10/69 W/WELD JOINTS.
 STA. 378+30--381+00 RT : EXIST. 6" X TRU STEEL .188 W.T. GAS TO REMAIN IN PLACE. INST. 10/69 W/WELD JOINTS.
 STA. 377+75 44'RT--377+74 27'RT--377+78.5 27'RT--377+80 20'RT--377+81.5 0'RT : EXIST. 2" X TRU STEEL SCH. 40 GAS TO REMAIN IN PLACE. INST. 1/11/85 W/WELDS & POS'IS.

EXIST. GAS TO BE LOWERED
 PROPOSED NEW GAS
 EXIST. GAS TO BE RETIRED IN PLACE

VAOT PROJ. # NH-EGC-019-4(27-28)
 GAS DESIGN & ASBUILT BY M.A. OF VGS.

VERMONT GAS SYSTEMS, INC.
NATURAL GAS PIPELINE
PRESSURE: MEDIUM
SHELBURNE RD. ROUTE 7
SHELBURNE & SO. BURL.
 DWN. BY: ERDMAN ANTHONY
DATE: FEBRUARY, 1996
SCALE: 1"=20' **SHEET: 24**

MATCH TO PLAN DRAWING NO. 23, STA. 375+00

MATCH TO PLAN DRAWING NO. 25, STA. 381+00

5" PAPER BY INSTRUMENTAL PLAN 3/19/88 BY M.A.