

CATAMOUNT/SHELBURNE LLC

SHELBURNE COMMONS
#4066--4076 SHLB. RD.

TO SHLB. COMMONS #4066--4076 SHLB. RD.
SEE SHLB. RD. SH. 10A FOR CONT. WEST

- STA. 296+65 48'RT--49'LT RTE. 7 : PROPOSED NEW 2" PE DRISCO 8100 GAS
- STA. 296+60--296+80 49'LT RTE. 7 : PROPOSED NEW 2" PE DRISCO 8100 GAS
- - - STA. 296+74 24.5'RT--296+72 27.5'LT RTE. 7 : EXIST. 2" X TRU STEEL GAS TO BE RETIRED
- - - STA. 296+67--296+76.5 27.5'LT RTE. 7 : EXIST. 2" X TRU STEEL GAS TO BE RETIRED
- - - STA. 296+76.5--297+00 LT RTE. 7 : EXIST. 2" PE DRISCO 8000 GAS TO BE RETIRED

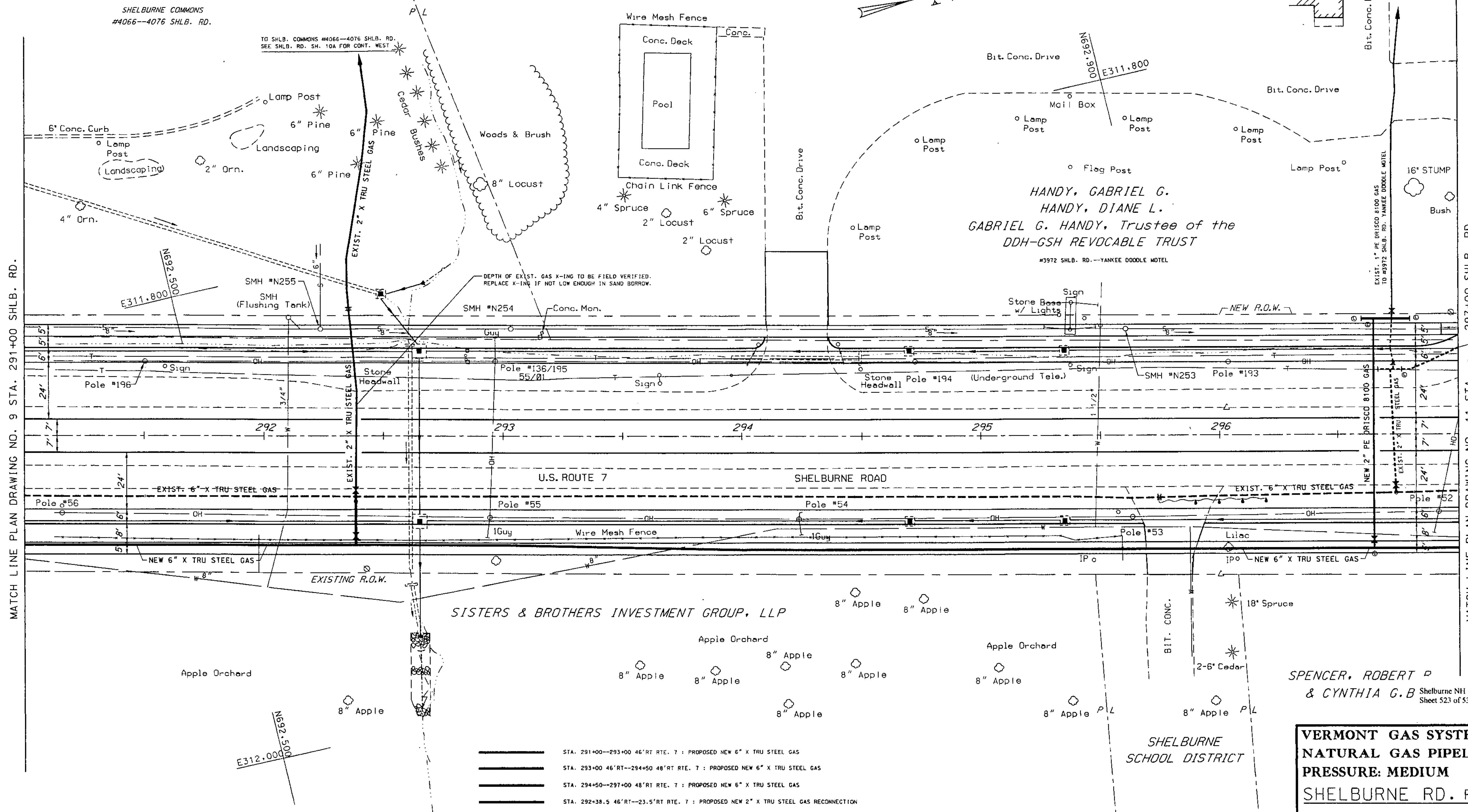
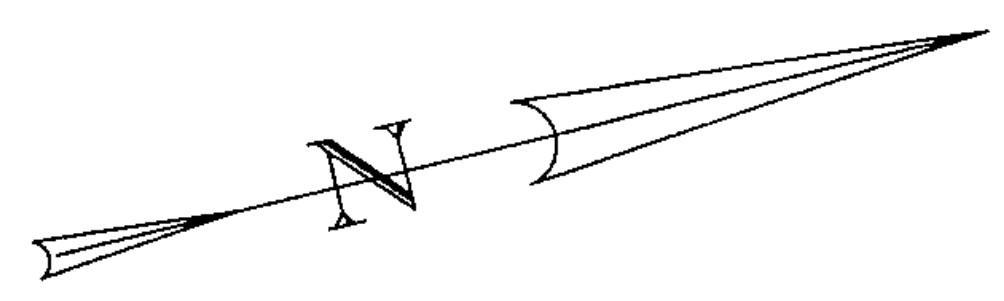

MATCH LINE PLAN DRAWING NO. 9 STA. 291+00 SHLB. RD.

MATCH LINE PLAN DRAWING NO. 11 STA. 297+00 SHLB. RD.

SISTERS & BROTHERS INVESTMENT GROUP, LLP

SISTERS & BROTHERS INVESTMENT GROUP, LLP

SHELBURNE
SCHOOL DISTRICT

SPENCER, ROBERT D
& CYNTHIA G.B
Shelburne NH EGC 019-4 (27)
Sheet 523 of 537

- STA. 291+00--293+00 46'RT RTE. 7 : PROPOSED NEW 6" X TRU STEEL GAS
- STA. 293+00 46'RT--294+50 48'RT RTE. 7 : PROPOSED NEW 6" X TRU STEEL GAS
- STA. 294+50--297+00 48'RT RTE. 7 : PROPOSED NEW 6" X TRU STEEL GAS
- STA. 292+38.5 46'RT--23.5'RT RTE. 7 : PROPOSED NEW 2" X TRU STEEL GAS RECONNECTION
- STA. 292+38.5 24.5'RT--292+39 19'LT--292+35.5 54'LT--LT ASKEW RTE. 7 : EXIST. 2" X TRU STEEL GAS TO BE RETAINED
- - - STA. 291+00--297+00 RT RTE. 7 : EXIST. 6" X TRU STEEL GAS TO BE RETIRED IN PLACE

VERMONT GAS SYSTEMS, INC.
NATURAL GAS PIPELINE
PRESSURE: MEDIUM
SHELBURNE RD. ROUTE 7
SHELBURNE
 DWN. BY: ERDMAN ANTHONY
DATE: FEBRUARY, 1996
SCALE: 1"= 20' **SHEET: 10**

VAOT PROJ. # NH-EGC-019-4(27)
GAS DESIGN & ASBUILT BY M.A. OF VGS.

S:\V001\EGC\ASBUILT\019-4(27)\EGC-019-4(27).DWG 2/19/96 4:08:04 PM