

RICE REALTY CORPORATION

RICE LUMBER CO., INC.

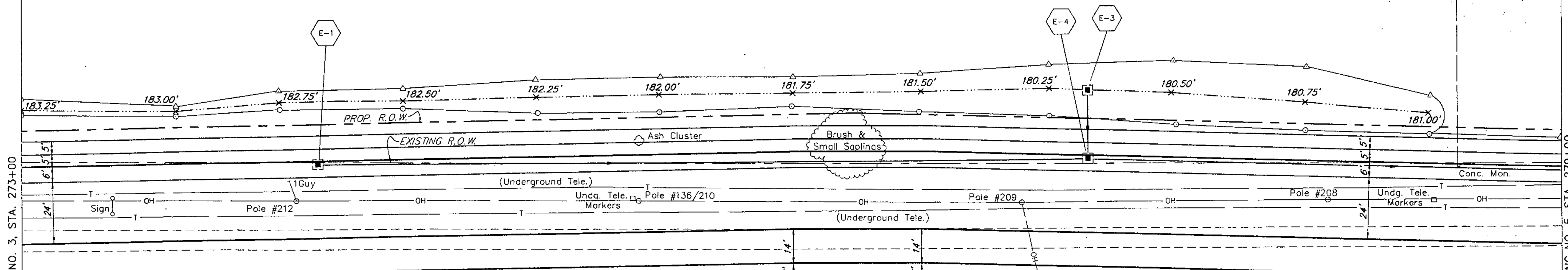

MATCH TO PLAN DRAWING NO. 3, STA. 273+00

MATCH TO PLAN DRAWING NO. 5, STA. 279+00

274 N. 131° 44' E 275 Bit. Conc. 276 SHELBURNE ROAD 277 U.S. ROUTE 7 278

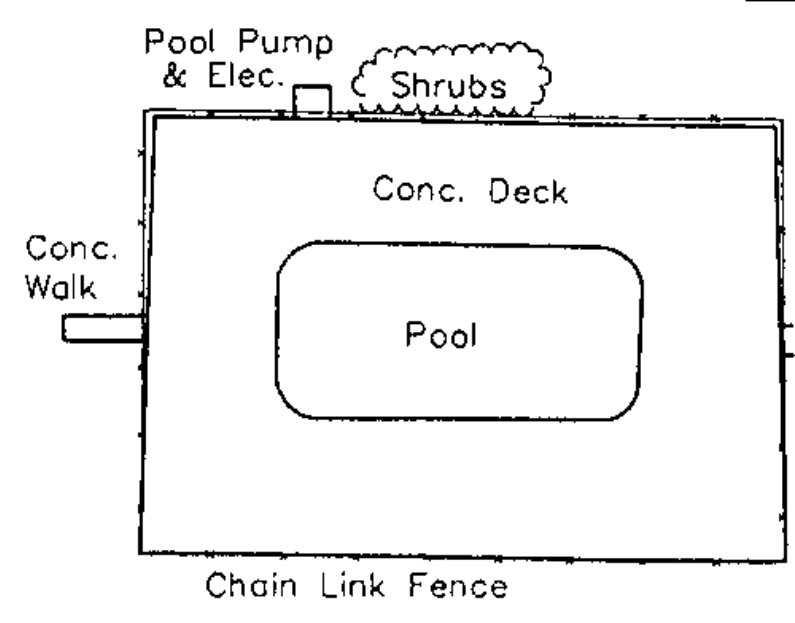

REMOVE EXIST. ASPHALT MATERIAL, REGRADE, PLACE 4" TOPSOIL & SEED

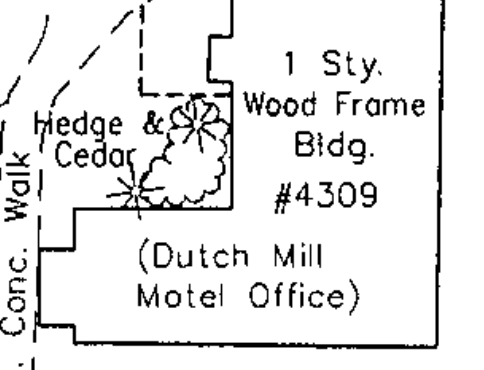

REMOVE EXIST. ASPHALT MATERIAL, REGRADE, PLACE 4" TOPSOIL & SEED

UNB SECONDARY & PEDESTAL

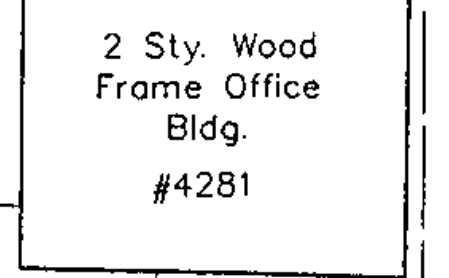

CSJ CORPORATION

SMALL, JEFFREY C.

ANDRUS, WILLIAM N. & SUSAN

GREEN MOUNTAIN POWER CORPORATION SOUTH BURLINGTON, VERMONT			
12470Y 4W 3PH FEEDER			
<h2>32G4 & 53G2 OVERHEAD</h2>			
SHELBURNE ROAD RECONSTRUCTION			
DATE:	CHECKED:	APPROVED:	SCALE: 1"=20'
	DRAWING NO. GMP-07_3_04		SHEET: 3

Shelburne NH EGC 019-4 (27)
Sheet 497 of 537