

**PLAN**  
1" = 20'

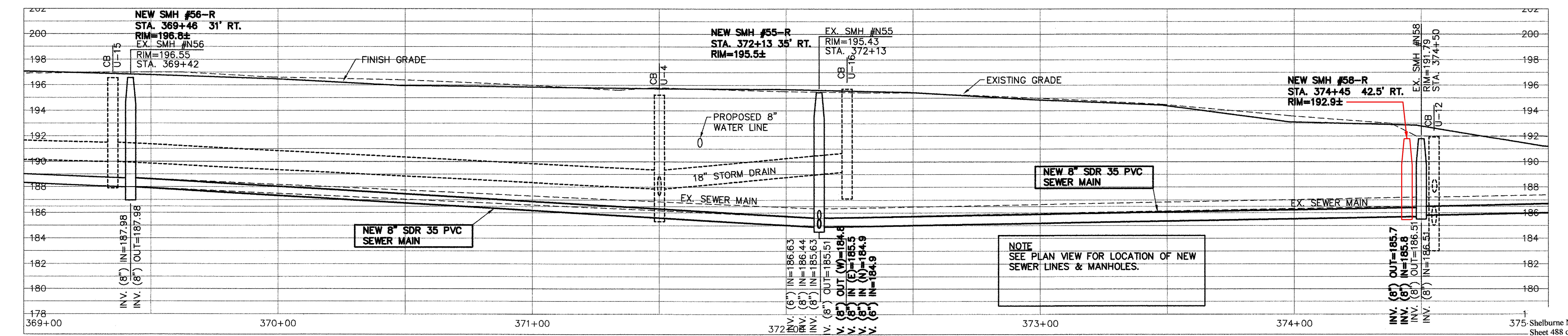
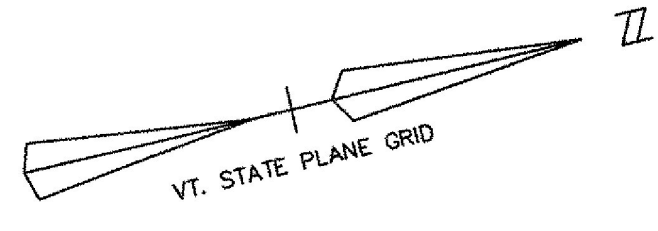

**PROFILE**  
1" = 4' VERTICAL  
1" = 20' HORIZONTAL

**RECORD DRAWING REVISIONS**

NO.	DATE	DESCRIPTION
1.	11/10/09	FIELD MARK UPS ADDED TO THE PLANS



Date	Ch'kd	Revision
2-17-04	SAV/ACL	REVISED PROFILE
1-5-04	SAV/ACL	REV'D WATER SYSTEM AS PER "AS BUILT" INFORMATION
10-21-03	SAV/ACL	REV'D SEWER & WATER AS PER AOT REVIEW COMMENTS
9-3-03	SAV/ACL	REVISED PER REVIEW COMMENTS
7-21-03	SAV/ACL	REVISED

**TOWN OF SHELBURNE**  
**SEWER/WATER RELOCATION (AOT WORK)**  
**PLAN AND PROFILE**  
**STA. 369+00 TO 375+00**

Drawn by: SAV  
Checked by: SAV  
Approved by: SAV

Date: DEC., 2000  
Scale: AS NOTED  
Project No.: 96111

**CIVIL ENGINEERING ASSOCIATES, INC.**  
SHELBURNE, VERMONT

SHEET **C-23**

P:\AutoCAD\Projects\1986\9611\ROUTE-7-SEWER.dwg, 02/17/2004 11:41:34 AM