

**PLAN**  
1" = 20'

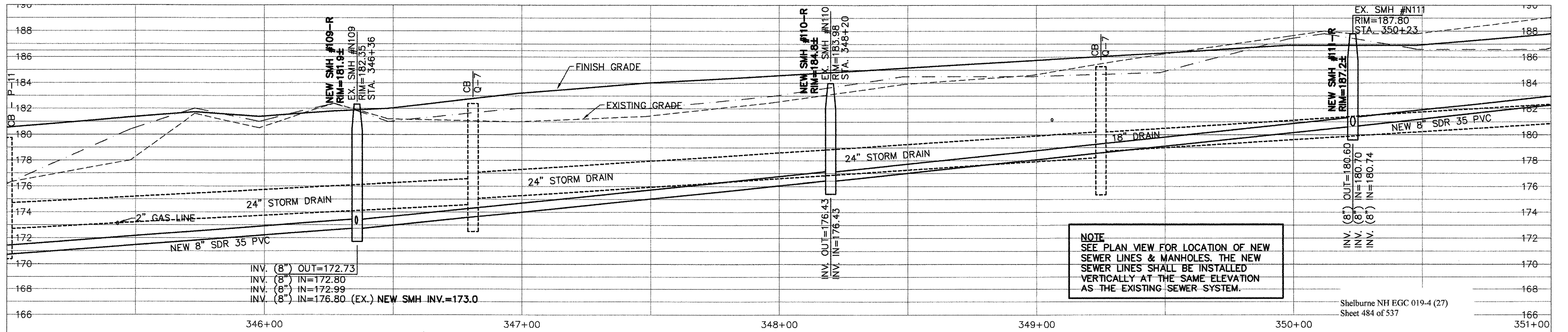
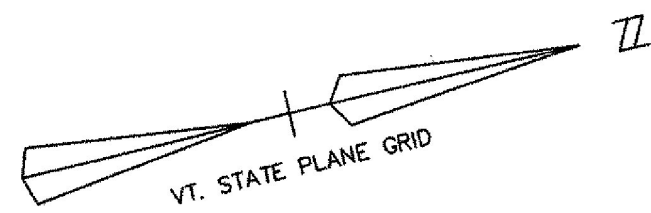

**PROFILE**  
1" = 4' VERTICAL  
1" = 20' HORIZONTAL

**RECORD DRAWING REVISIONS**

NO.	DATE	DESCRIPTION
1.	11/10/09	FIELD MARK UPS ADDED TO THE PLANS



Date	Ch'kd	Revision
2-17-04	SAV/AQL	REV'D WATER SYSTEM AS PER "AS BUILT" INFORMATION
10-21-03	SAV/AQL	REV'D SEWER & WATER AS PER AOT REVIEW COMMENTS
9-3-03	SAV/AQL	REVISED RIM ELEV. TO ±
7-21-03	SAV/AQL	REVISED

**TOWN OF SHELburne**  
**SEWER/WATER RELOCATION (AOT WORK)**  
**PLAN AND PROFILE**  
**STA. 345+00 TO 351+00**

Drawn by: ACL Date: DEC. 2000  
 Checked by: SAV Scale: AS NOTED  
 Approved by: SAV Project No.: 96111

CIVIL ENGINEERING ASSOCIATES, INC.  
SHELburne, VERMONT

**C-19**

MATCH TO PLAN DRAWING NO. 18, STA. 345+00

MATCH TO PLAN DRAWING NO. 20, STA. 351+00

P:\AutoCAD Projects\1996\96111\ROUTE-7-SEWER.dwg, 02/17/2004 11:39:01 AM