

**PLAN**  
1" = 20'

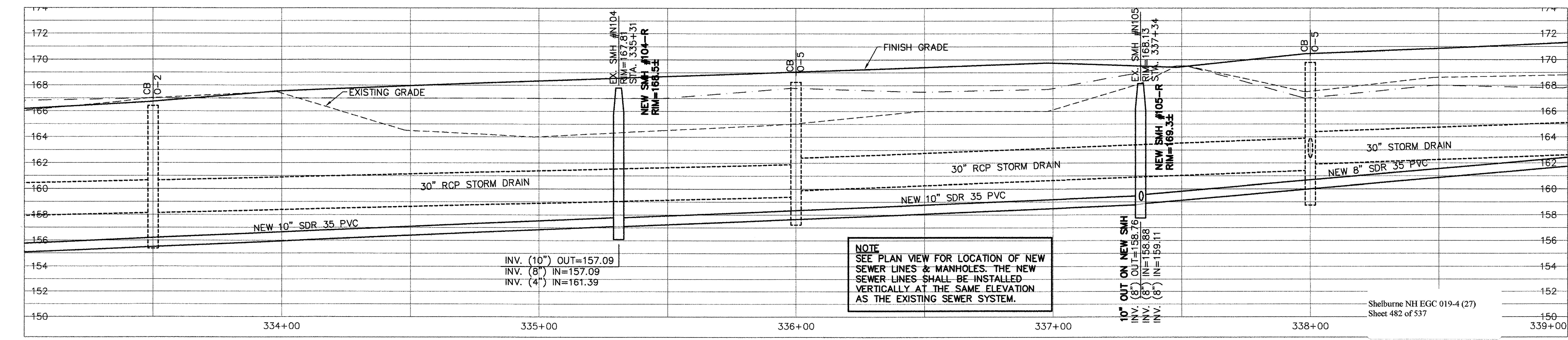
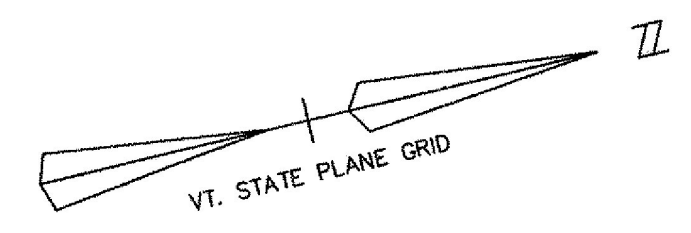

**PROFILE**  
1" = 4' VERTICAL  
1" = 20' HORIZONTAL

**NOTE**  
SEE PLAN VIEW FOR LOCATION OF NEW SEWER LINES & MANHOLES. THE NEW SEWER LINES SHALL BE INSTALLED VERTICALLY AT THE SAME ELEVATION AS THE EXISTING SEWER SYSTEM.

**RECORD DRAWING REVISIONS**

NO.	DATE	DESCRIPTION
1.	11/10/09	FIELD MARK UPS ADDED TO THE PLANS



Date	Ch'kd	Revision
2-17-04	SAV/AQL	REV'D WATER SYSTEM AS PER "AS BUILT" INFORMATION
10-21-03	SAV/AQL	REV'D SEWER & WATER AS PER AOT REVIEW COMMENTS
9-3-03	SAV/AQL	REVISED RIM ELEV. TO ±
7-21-03	SAV/AQL	REVISED

Date	ACL	Date	DEC., 2000
Drawn by	SAV	Scale	AS NOTED
Checked by	SAV	Project No.	96111
Approved by	SAV		

**TOWN OF SHELBURNE**  
**SEWER/WATER RELOCATION (AOT WORK)**  
**PLAN AND PROFILE**  
**STA. 333+00 TO 339+00**

SHELBURNE VERMONT

CIVIL ENGINEERING ASSOCIATES, INC.  
SHELBURNE, VERMONT

SHEET **C-17**

P:\AutoCAD Projects\1996\96111\ROUTE-7-SEWER.dwg, 02/17/2004 11:35:44 AM