

PLAN
1" = 20'

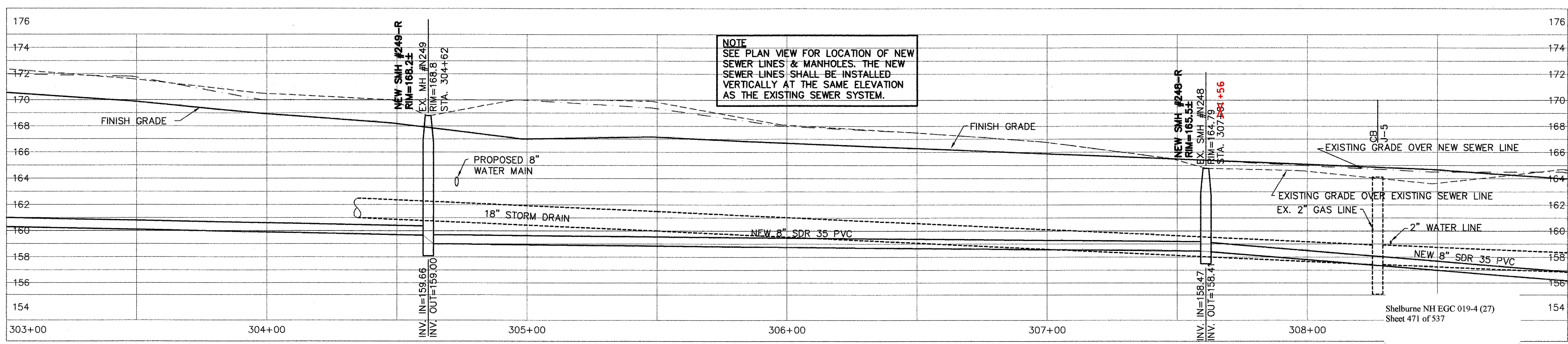
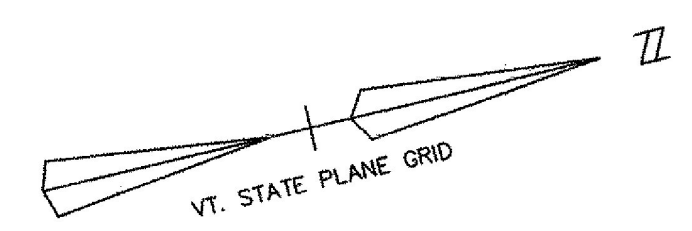

PROFILE
1" = 4' VERTICAL
1" = 20' HORIZONTAL

NOTE
SEE PLAN VIEW FOR LOCATION OF NEW SEWER LINES & MANHOLES. THE NEW SEWER LINES SHALL BE INSTALLED VERTICALLY AT THE SAME ELEVATION AS THE EXISTING SEWER SYSTEM.

RECORD DRAWING REVISIONS

NO.	DATE	DESCRIPTION
1.	11/10/09	FIELD MARK UPS ADDED TO THE PLANS

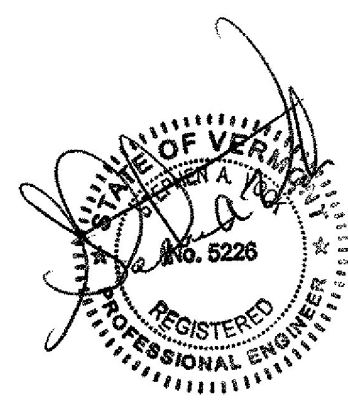

Date	Ch'kd	Revision
10-21-03	SAV/ACL	REV'D SEWER & WATER AS PER AOT REVIEW COMMENTS
9-3-03	SAV/ACL	REVISED RIM ELEV. TO ±
7-21-03	SAV/ACL	REVISED

Drawn by	ACL	Date	DEC., 2000
Checked by	SAV	Scale	AS NOTED
Approved by	SAV	Project No.	96111

TOWN OF SHELBURNE
SEWER/WATER RELOCATION (AOT WORK)
PLAN AND PROFILE
STA. 303+00 TO 309+00

SHELBURNE VERMONT

CIVIL ENGINEERING ASSOCIATES, INC.
SHELBURNE, VERMONT

C-12

P:\AutoCAD Projects\1996\96111\ROUTE-7-SEWER.dwg, 10/23/2003 02:27:32 PM