

PLAN
1" = 20'

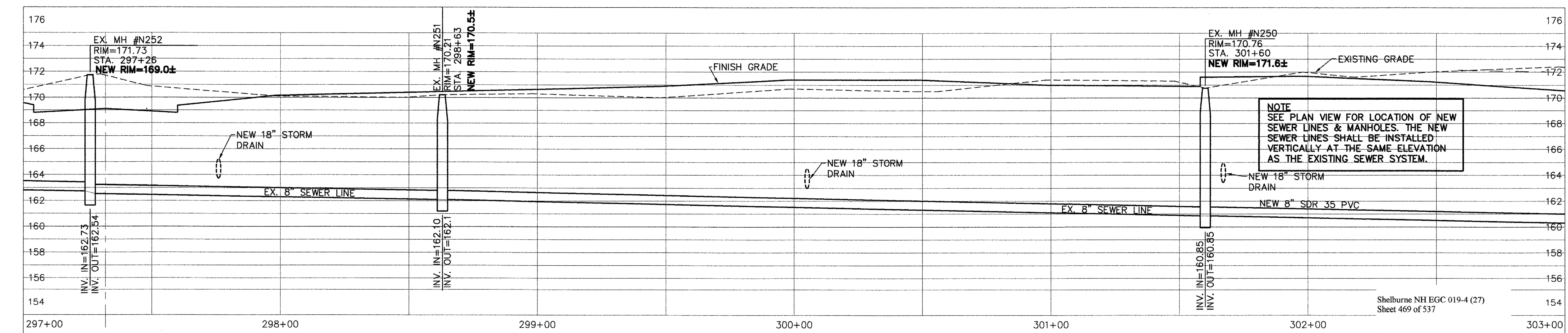
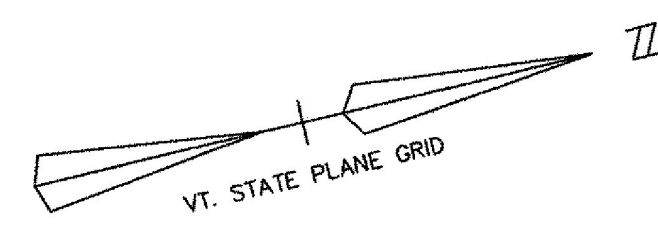

PROFILE
1" = 4' VERTICAL
1" = 20' HORIZONTAL

RECORD DRAWING REVISIONS

NO	DATE	DESCRIPTION
1.	11/10/09	FIELD MARK UPS ADDED TO THE PLANS

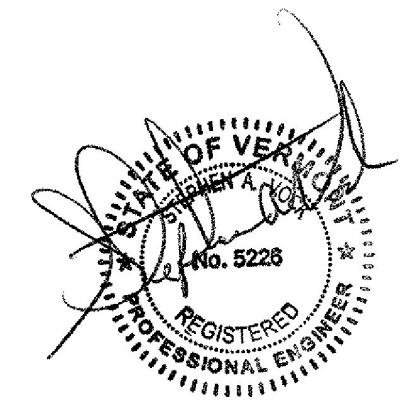

Date	Ch'k'd	Revision
1-5-04	SAV/ACL	REV'D WATER SYSTEM AS PER "AS BUILT" INFORMATION
10-21-03	SAV/ACL	REV'D SEWER & WATER AS PER AOT REVIEW COMMENTS
9-3-03	SAV/ACL	REVISED RIM ELEV. TO ±
7-21-03	SAV/ACL	REVISED

TOWN OF SHELburne
SEWER/WATER RELOCATION (AOT WORK)
PLAN AND PROFILE
STA. 297+00 TO 303+00

Drawn by: SAV/ACL Date: DEC., 2000
Checked by: SAV Scale: AS NOTED
Approved by: SAV Project No.: 96111

CIVIL ENGINEERING ASSOCIATES, INC.
SHELburne, VERMONT

SHEET C-11

P:\AutoCAD Projects\1996\96111\ROUTE-7-SEWER.dwg, 01/07/2004 12:48:19 PM