

**LIGHTING ITEMS**

**ITEM 678.21 - ELECTRICAL CONDUIT (2" PVC SCHEDULE 40)**

375+00 LT. - 376+93 LT. (L-85), 193 LF  
 375+00 RT - 375+83 RT (L-44), 86 LF

**ITEM 678.26 - JUNCTION BOX**

376+93, 49' LT. (L-85)

**ITEM 678.30 - ELECTRICAL CONDUIT SLEEVE**

375+00 RT. - 375+05 RT., 5 LF (8")  
 375+09 LT. - 375+37 LT., 28 LF (8")

**INTERCONNECT ITEMS**

**ITEM 678.20 (MOD.) - INTERCONNECTING CABLE (3" PVC SCHEDULE 40)**

375+00 RT. - 375+78 RT. (I-44), 80 LF

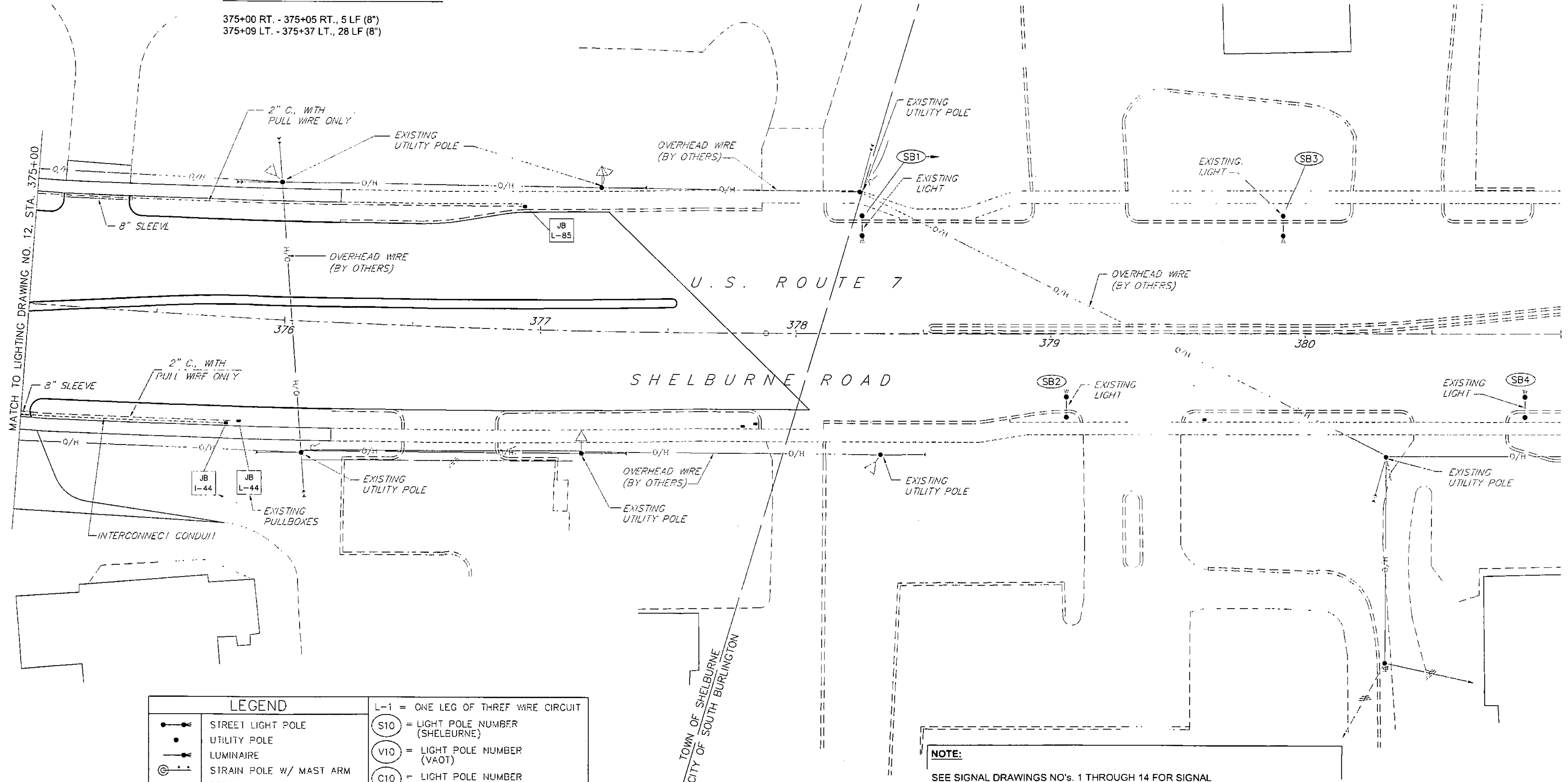
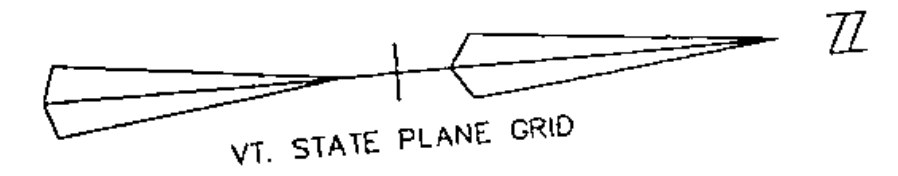

LEGEND	
	STREET LIGHT POLE
	UTILITY POLE
	LUMINAIRE
	STRAIN POLE W/ MAST ARM
	PEDESTRIAN POLE
	PULL BOX OR JUNCTION BOX
	SIGNAL CONDUIT
	INTERCONNECT CABLE CONDUIT
	LIGHTING CONDUIT
	SLEEVE
	POWER DROP STANCHION
	PE S-1 = SIGNAL PULLBOX NUMBER
	JB I-1 = INTERCONNECT JUNCTION BOX NUMBER
	JB L-1 = LIGHTING JUNCTION BOX NUMBER
	PE P-1 = POWER SOURCE PULLBOX NUMBER
	S10 = LIGHT POLE NUMBER (SHELBURNE)
	V10 = LIGHT POLE NUMBER (VAOT)
	C10 = LIGHT POLE NUMBER (CANTILEVER - VAOT)
	L-1 = ONE LEG OF THREE WIRE CIRCUIT

ABBREVIATIONS	
C.	= CONDUIT
CU.	= COPPER
GRD.	= GROUND

**NOTE:**  
 SEE SIGNAL DRAWINGS NO'S. 1 THROUGH 14 FOR SIGNAL CONDUITS, PULLBOXES, WIRING, POLES AND SLEEVES.  
 SEE TYPICAL SECTION DRAWING NO. 7 FOR TYPICAL CONDUIT PLACEMENT DETAIL.  
 STREET LIGHTS #SB1, SB2, SB3 AND SB4 ARE OWNED BY CITY OF SOUTH BURLINGTON. SEE CONTRACT 4 PLANS.  
 JUNCTION BOXES I-44 AND L-44 ARE EXISTING. SEE CONTRACT 4 PLANS.

DATUM  
 VERTICAL NCVD 1929  
 HORIZONTAL NAD 1927

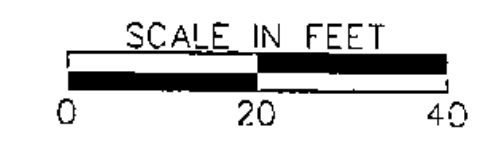

SHELBURNE  
 SURVEYED BY V.S.C. INC. DATE \_\_\_\_\_  
 DRAWN BY E.A.A. INC. DATE \_\_\_\_\_  
 TRACED BY E.A.A. INC. DATE \_\_\_\_\_  
 PROJECT NH-EGC-019-4(27)  
 LIGHTING DRAWING NO. 21  
 SHEET NO. 260 OF 537

4/13/04