

LIGHTING ITEMS

ITEM 678.21 - ELECTRICAL CONDUIT (2" PVC SCHEDULE 40)

369+00 RT. - 370+80 RT. (L-42), 183 LF
 369+00 LT. - 370+23 LT. (L-82), 123 LF
 372+45 LT. (L-83) - 374+25 LT. (L-84), 180 LF
 373+08 RT. (L-43) - 375+00 RT., 195 LF
 374+25 LT. (L-84) - 375+00 LT., 75 LF

ITEM 678.26 - JUNCTION BOX

370+23, 41' LT. (L-82)
 370+80, 43' RT. (L-42)
 372+45, 41' LT. (L-83)
 373+08, 43' RT. (L-43)
 374+25, 41' LT. (L-84)

ITEM 679.21 - LIGHT POLE BASE

POLE V6, 1 EA.

ITEM 679.23 - BREAKAWAY FEATURE FOR LIGHT POLE

POLE V6, 1 EA.

ITEM 678.30 - ELECTRICAL CONDUIT SLEEVE

369+39 RT. - 369+76 RT., 37 LF (8")
 369+85 LT. - 370+11 LT., 26 LF (8")
 373+84 RT. - 374.22 RT., 38 LF (8")
 374+66 RT. - 375+00 RT., 34 LF (8")

ITEM 679.45 - LIGHT POLE

POLE V6, 1 EA.

ITEM 679.47 - BRACKET ARM

POLE V6, 1 EA.

ITEM 679.50 - LUMINAIRE

POLE V6, 1 EA.

INTERCONNECT ITEMS

ITEM 678.20 (MOD.) - INTERCONNECTING CABLE (3" PVC SCHEDULE 40)

369+00 RT. - 370+85 RT. (I-42), 185 LF
 373+03 RT. (I-43) - 375+00 RT., 199 LF

POLE NO.	STATION	OFFSET	SIDE	LENGTH OF POLE	ARM	WALL THICK	BRK-WAY	LUMINAIRE WATTS	TYPE	MOUNT HEIGHT	CONC. BASE	REMARKS
V6	371+44	44'	LT.	33'	8'	.156	YES	250	III	35'	30"x72"	TRUSS-TYPE SUPPORT ARM
C21	371+65	51'	RT.	12'		.156		250	III	35'		MOUNT TRUSS-TYPE SUPPORT ARM ON CANTILEVER # 21
C22	372+18	56'	LT.	12'		.156		250	III	35'		MOUNT TRUSS-TYPE SUPPORT ARM ON CANTILEVER # 22
C23	372+32	51'	RT.	12'				250	III	35'		MOUNT TRUSS-TYPE SUPPORT ARM ON CANTILEVER # 23

ABBREVIATIONS

C. = CONDUIT
 CU. = COPPER
 GRD. = GROUND

NOTE:

STREET LIGHTS #C21, #C22 AND #C23 SHALL BE MOUNTED ON CANTILEVER POLES AND SHALL RECEIVE THEIR POWER FROM THE SAME METERED POWER SOURCE AS THE TRAFFIC SIGNAL.

STREET LIGHT #V6 SHALL BE AN INDEPENDENT LIGHT POLE AND SHALL RECEIVE POWER FROM THE SAME METERED POWER SOURCE AS THE TRAFFIC SIGNAL.

SEE SIGNAL DRAWINGS NO'S. 1 THROUGH 14 FOR SIGNAL CONDUITS, PULLBOXES, WIRING, POLES AND SLEEVES.

SEE TYPICAL SECTION DRAWING NO. 7 FOR TYPICAL CONDUIT PLACEMENT DETAIL.

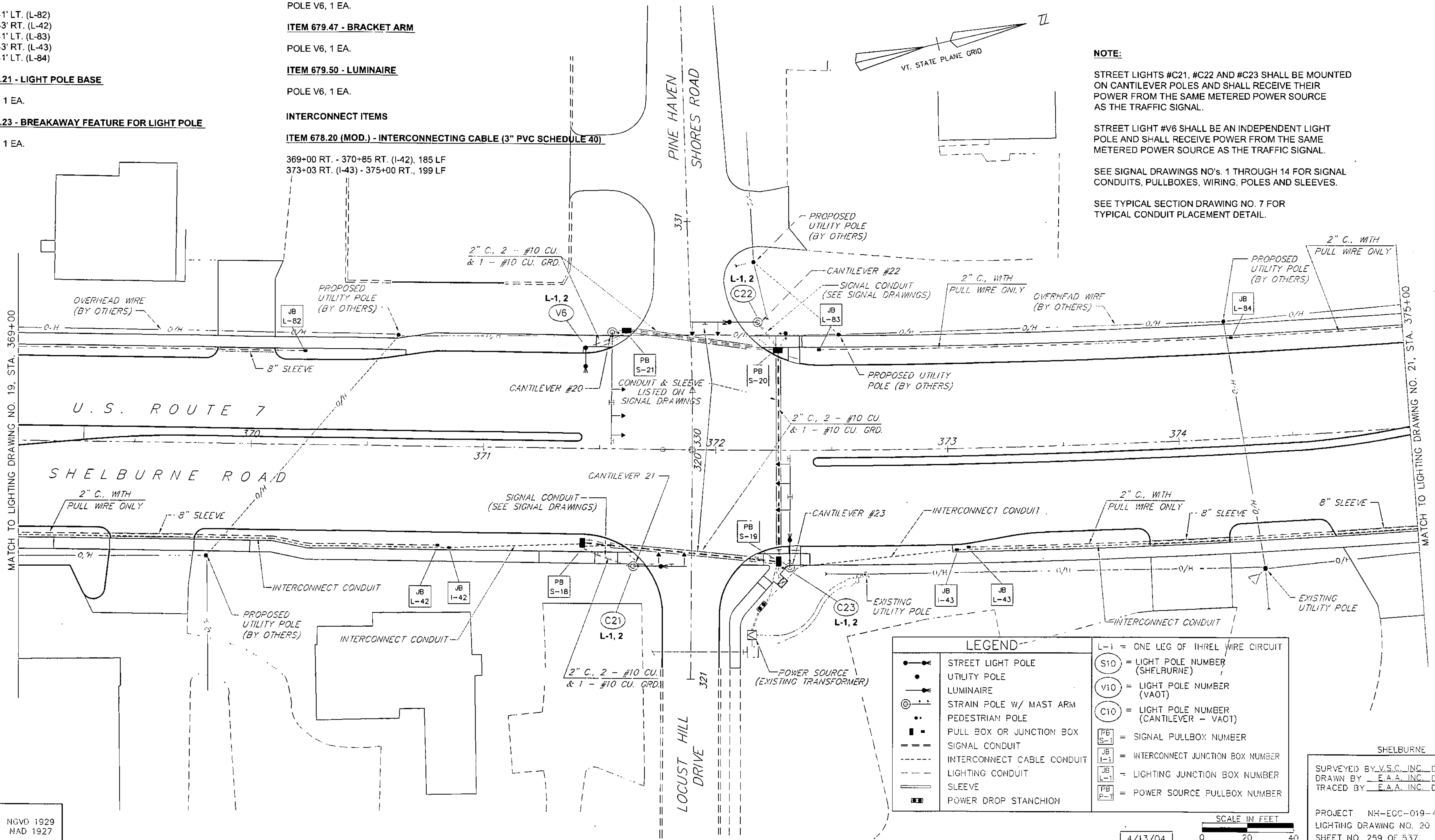

LEGEND

	STREET LIGHT POLE		S10 = LIGHT POLE NUMBER (SHELBURNE)
	UTILITY POLE		V10 = LIGHT POLE NUMBER (VAOT)
	LUMINAIRE		C10 = LIGHT POLE NUMBER (CANTILEVER - VAOT)
	STRAIN POLE W/ MAST ARM		PB S-1 = SIGNAL PULLBOX NUMBER
	PEDESTRIAN POLE		JB I-1 = INTERCONNECT JUNCTION BOX NUMBER
	PULL BOX OR JUNCTION BOX		JB L-1 = LIGHTING JUNCTION BOX NUMBER
	SIGNAL CONDUIT		PB P-1 = POWER SOURCE PULLBOX NUMBER
	INTERCONNECT CABLE CONDUIT		
	LIGHTING CONDUIT		
	SLEEVE		
	POWER DROP STANCHION		

SHELBURNE

SURVEYED BY V.S.C. INC. DATE _____
 DRAWN BY E.A.A. INC. DATE _____
 TRACED BY E.A.A. INC. DATE _____

PROJECT NH-ECC-019-4(27)
 LIGHTING DRAWING NO. 20
 SHEET NO. 259 OF 537

DATUM
 VERTICAL NGVD 1929
 HORIZONTAL NAD 1927

SCALE IN FEET
 0 20 40
 4/13/04