

LIGHTING ITEMS

ITEM 678.21 - ELECTRICAL CONDUIT (2" PVC SCHEDULE 40)

357+00 RT. - 358+45 RT. (L-37), 148 LF
 357+00 LT. - 358+19 LT. (L-77), 119 LF
 358+19 LT. (L-77) - 360+94 LT. (L-78), 275 LF
 358+45 RT. (L-37) - 361+20 RT. (L-38), 281 LF
 360+94 LT. (L-78) - 362+70 LT. (L-79), 176 LF
 361+20 RT. (L-38) - 363+00 RT., 183 LF

ITEM 678.26 - JUNCTION BOX

358+19, 41' LT. (L-77)
 358+45, 40' RT. (L-37)
 360+94, 41' LT. (L-78)
 361+20, 40' RT. (L-38)
 362+70, 41' LT. (L-79)

ITEM 678.30 - ELECTRICAL CONDUIT SLEEVE

357+00 RT. - 357+10 RT., 10 LF (8")
 359+44 LT. - 359+86 LT., 72 LF (8")
 359+49 RT. - 359+87 RT., 38 LF (8")
 361+54 LT. - 361+80 LT., 26 LF (8")
 361+71 RT. - 361+89 RT., 18 LF (8")
 362+80 RT. - 363+00 RT., 20 LF (8")

INTERCONNECT ITEMS

ITEM 678.20 (MOD.) - INTERCONNECTING CABLE (3" PVC SCHEDULE 40)

357+00 RT. - 358+40 RT. (I-37), 140 LF
 358+40 RT. (I-37) - 361+15 RT. (I-38), 275 LF
 361+15 RT. (I-38) - 363+00 RT., 185 LF

ITEM 678.26 - JUNCTION BOX

358+40, 41' RT. (I-37)
 361+15, 41' RT. (I-38)

LEGEND	
	STREET LIGHT POLE
	UTILITY POLE
	LUMINAIRE
	STRAIN POLE W/ MAST ARM
	PEDESTRIAN POLE
	PULL BOX OR JUNCTION BOX
	SIGNAL CONDUIT
	INTERCONNECT CABLE CONDUIT
	LIGHTING CONDUIT
	SIFFVE
	POWER DROP STANCHION

L-1	= ONE LEG OF THREE WIRE CIRCUIT
S10	= LIGHT POLE NUMBER (SHELBURNE)
V10	= LIGHT POLE NUMBER (VAOT)
C10	= LIGHT POLE NUMBER (CANTILEVER - VAOT)
PB S-1	= SIGNAL PULLBOX NUMBER
JB I-1	= INTERCONNECT JUNCTION BOX NUMBER
JB L-1	= LIGHTING JUNCTION BOX NUMBER
PB P-1	= POWER SOURCE PULLBOX NUMBER

ABBREVIATIONS	
C.	= CONDUIT
CU.	= COPPER
GRD.	= GROUND

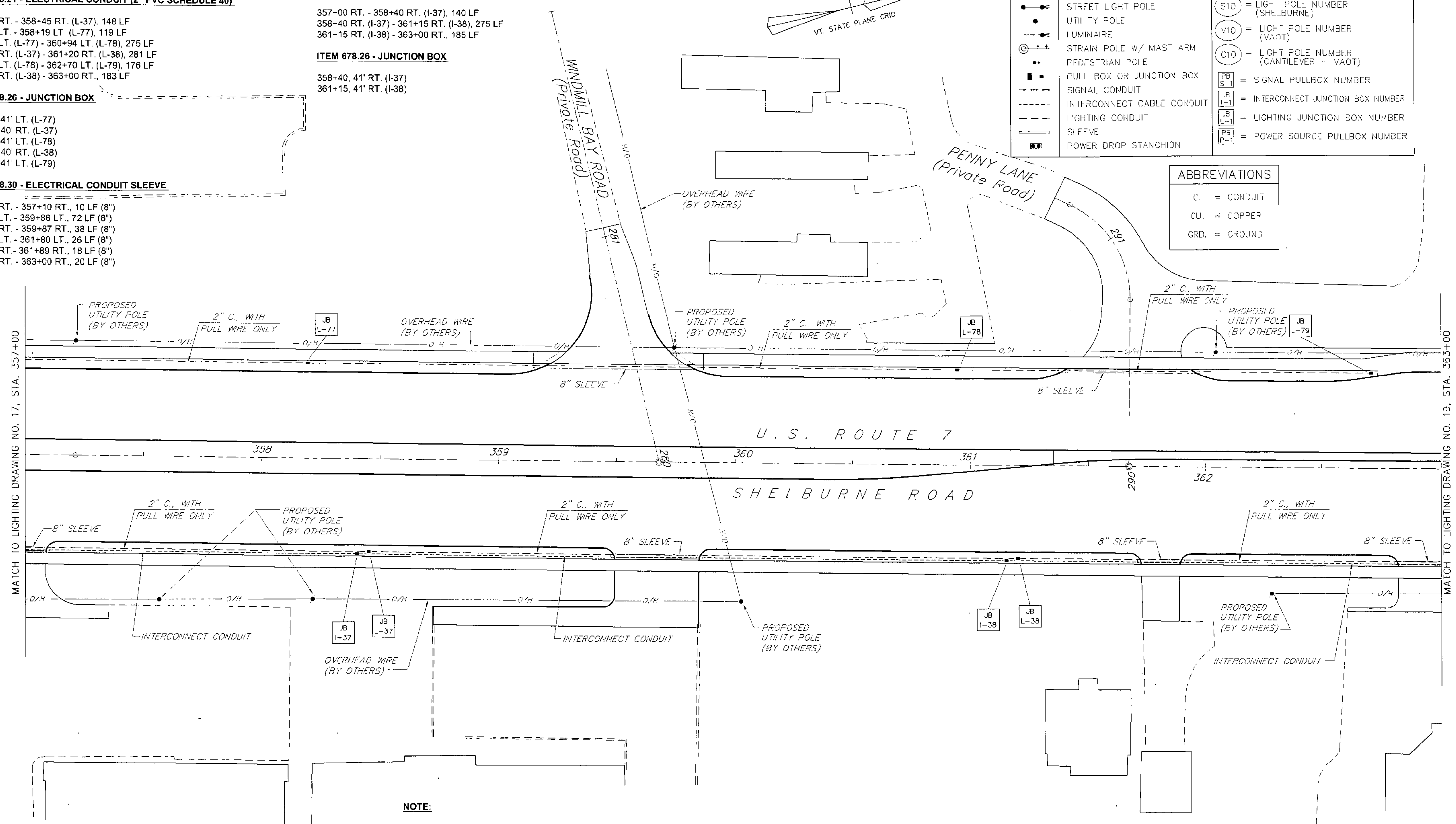
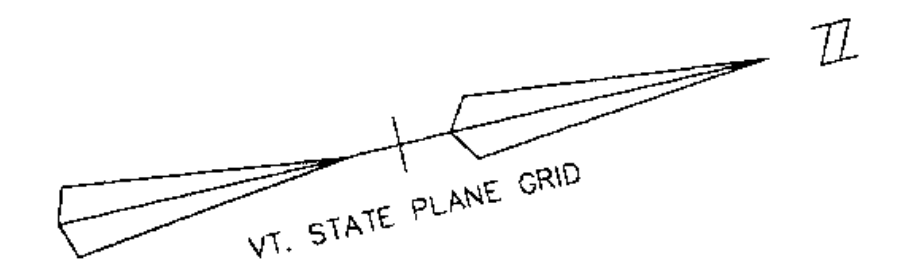

NOTE:
 SEE SIGNAL DRAWINGS NO's. 1 THROUGH 14 FOR SIGNAL CONDUITS, PULLBOXES, WIRING, POLES AND SLEEVES.
 SEE TYPICAL SECTION DRAWING NO. 7 FOR TYPICAL CONDUIT PLACEMENT DETAIL.

DATUM
 VERTICAL NCVD 1929
 HORIZONTAL NAD 1927

4/13/04
 SCALE IN FEET
 0 20 40

SHELBURNE
 SURVEYED BY V.S.C. INC. DATE _____
 DRAWN BY E.A.A. INC. DATE _____
 TRACED BY E.A.A. INC. DATE _____
 PROJECT NH-EGC-019-4(27)
 LIGHTING DRAWING NO. 18
 SHEET NO. 257 OF 537