

**LIGHTING ITEMS**

**ITEM 678.21 - ELECTRICAL CONDUIT (2" PVC SCHEDULE 40)**

351+00 LT. - 352+95 LT. (L-75), 200 LF  
 351+25 RT. (POLE NO. S14) - 352+95 RT. (L-35), 179 LF  
 352+95 LT. (L-75) - 355+44 LT. (L-76), 249 LF  
 352+95 RT. (L-35) - 355+70 RT. (L-36), 281 LF  
 355+44 LT. (L-76) - 357+00 LT., 156 LF  
 355+70 RT. (L-36) - 357+00 RT., 133 LF

**ITEM 678.23 - WIRED CONDUIT (2" PVC SCHEDULE 40)**

351+00 RT. - 351+25 RT. (POLE NO. S14), 31 LF

**ITEM 678.26 - JUNCTION BOX**

352+95, 41' LT. (L-75)  
 352+95, 40' RT. (L-35)  
 355+44, 41' LT. (L-76)  
 355+70, 40' RT. (L-36)

**ITEM 678.30 - ELECTRICAL CONDUIT SLEEVE**

351+00 RT. - 351+19 RT., 19 LF (12")  
 352+26 LT. - 352+44 LT., 18 LF (8")  
 353+32 LT. - 353+68 LT., 36 LF (8")  
 354+89 LT. - 355+09 LT., 20 LF (8")  
 355+48 LT. - 356+23 LT., 75 LF (8")  
 356+08 RT. - 356+26 RT., 18 LF (8")  
 356+72 RT. - 357+00 RT., 28 (8")

**ITEM 679.21 - LIGHT POLE BASE**

POLE S14, 1 EA

**ITEM 679.23 - BREAKAWAY FEATURE FOR LIGHT POLE**

POLE S14, 1 EA

**ITEM 679.45 - LIGHT POLE POLE**

S14, 1 EA

**ITEM 679.47 - BRACKET ARM**

POLE S14, 1 EA

**ITEM 679.50 - LUMINAIRE**

POLE S14, 1 EA

**INTERCONNECT ITEMS**

**ITEM 678.20 (MOD.) - INTERCONNECTING CABLE (3" PVC SCHEDULE 40)**

351+00 RT. - 352+90 RT. (I-35), 190 LF  
 352+90 RT. (I-35) - 355+65 RT. (I-36), 275 LF  
 355+65 RT. (I-36) - 357+00 RT., 135 LF

**ITEM 678.26 - JUNCTION BOX**

352+90, 41' RT. (I-35)  
 355+65, 41' RT. (I-36)

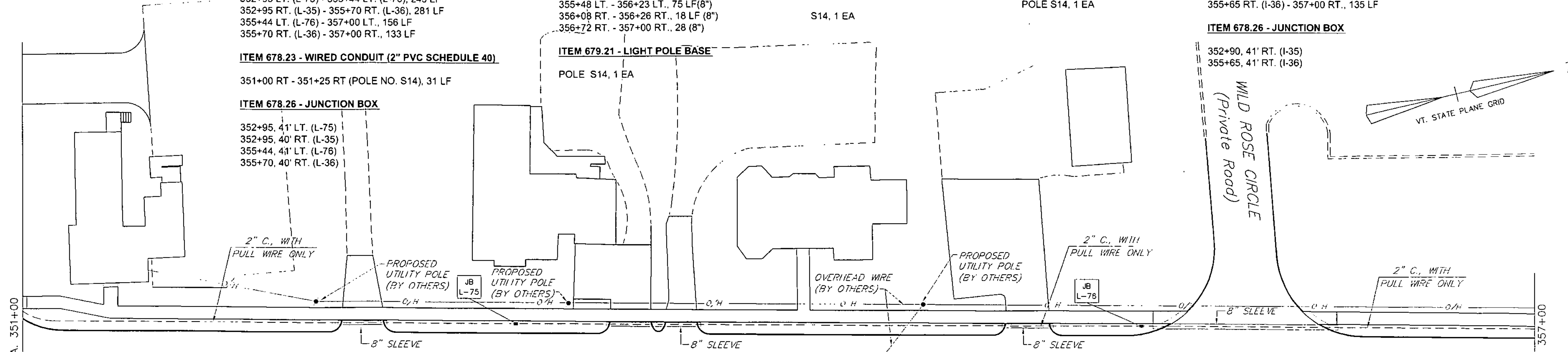

MATCH TO LIGHTING DRAWING NO. 16, STA. 351+00

MATCH TO LIGHTING DRAWING NO. 18, STA. 357+00

U.S. ROUTE 7

SHELBURNE ROAD

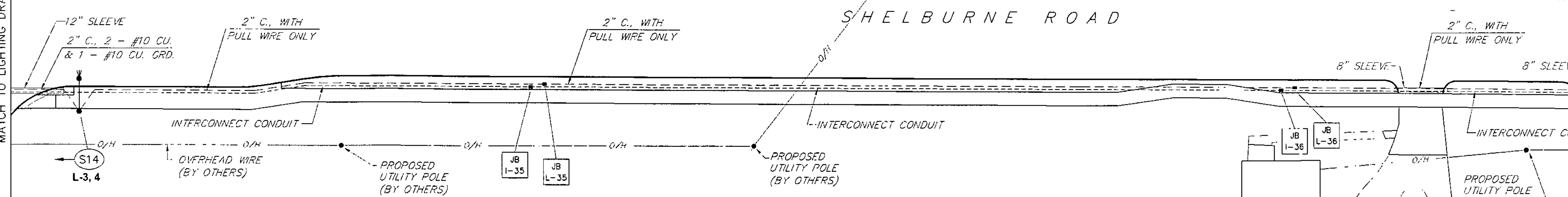
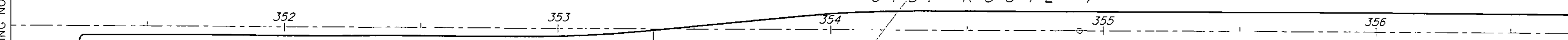

POLE NO.	STATION	OFFSET	SIDE	LENGTH OF POLE	WALL THICK	BRK WAY	LUMINAIRE WATTS	LUMINAIRE TYPE	MOUNT HEIGHT	CONC. BASE	REMARKS
S14	351+25	51'	RT.	33'	12"	.156	YES	250	III	30"x96"	TRUSS-TYPE SUPPORT ARM

**LEGEND**

	STREET LIGHT POLE
	UTILITY POLE
	LUMINAIRE
	STRAIN POLE W/ MAST ARM
	PEDESTRIAN POLE
	PULL BOX OR JUNCTION BOX
	SIGNAL CONDUIT
	INTERCONNECT CABLE CONDUIT
	LIGHTING CONDUIT
	SLEEVE
	POWER DROP STANCHION

**LEGEND**

L-1 = ONE LEG OF THREE WIRE CIRCUIT

S10 = LIGHT POLE NUMBER (SHELBURNE)

V10 = LIGHT POLE NUMBER (VAOT)

C10 = LIGHT POLE NUMBER (CANTILEVER - VAOT)

PB S-1 = SIGNAL PULLBOX NUMBER

JB I-1 = INTERCONNECT JUNCTION BOX NUMBER

JB L-1 = LIGHTING JUNCTION BOX NUMBER

PB P-1 = POWER SOURCE PULLBOX NUMBER

**ABBREVIATIONS**

C. = CONDUIT

CU. = COPPER

GRD. = GROUND

**NOTE:**

SEE SIGNAL DRAWINGS NO's. 1 THROUGH 14 FOR SIGNAL CONDUITS, PULLBOXES, WIRING, POLES AND SLEEVES.

SEE TYPICAL SECTION DRAWING NO. 7 FOR TYPICAL CONDUIT PLACEMENT DETAIL.

DATUM  
 VERTICAL NGVD 1929  
 HORIZONTAL NAD 1927

DATE 4/13/04

SCALE IN FEET  
 0 20 40

SHELBURNE

SURVEYED BY V.S.C. INC. DATE \_\_\_\_\_  
 DRAWN BY E.A.A. INC. DATE \_\_\_\_\_  
 TRACED BY E.A.A. INC. DATE \_\_\_\_\_

PROJECT NH-EGC-019-4(27)  
 LIGHTING DRAWING NO. 17  
 SHEET NO. 256 OF 537