

POLE NO.	STATION	OFFSET	SIDE	LENGTH OF POLE ARM	WALL THICK	BRK-WAY	LUMINAIRE WATTS	LUMINAIRE TYPE	MOUNT HEIGHT	CONC. BASE	REMARKS
C9	322+39	51'	LT.	12'			250	III	35'		MOUNT TRUSS-TYPE SUPPORT ARM ON CANTILEVER # 9
C10	322+66	51'	RT.	12'			250	III	35'		MOUNT TRUSS-TYPE SUPPORT ARM ON CANTILEVER # 10
C11	323+18	51'	LT.	12'			250	III	35'		MOUNT TRUSS-TYPE SUPPORT ARM ON CANTILEVER # 11
C12	323+39	51'	RT.	12'			250	III	35'		MOUNT TRUSS-TYPE SUPPORT ARM ON CANTILEVER # 12
V2	324+00	80'	LT.	33'	8"	.156	YES	250	III	35'	TRUSS-TYPE SUPPORT ARM

**LIGHTING ITEMS**

**ITEM 678.21 - ELECTRICAL CONDUIT (2" PVC SCHEDULE 40)**

321+00 LT. - 321+32 LT. (L-65), 32 LF  
 321+00 RT - 322+29 RT (L-23), 129 LF  
 324+15 RT (L-24) - 326+95 RT (L-25), 280 LF  
 326+95 RT (L-25) - 327+00 RT, 5 LF

**ITEM 678.26 - JUNCTION BOX**

321+52, 41' LT. (L-65)  
 322+29, 40' RT. (L-23)  
 324+20, 43' RT. (L-24)  
 326+95, 43' RT. (L-25)

**ITEM 679.21 - LIGHT POLE BASE**

POLE V2, 1 EA.

**ITEM 679.23 - BREAKAWAY FEATURE FOR LIGHT POLE**

POLE V2, 1 EA.

**ITEM 678.30 - ELECTRICAL CONDUIT SLEEVE**

321+39 RT. - 321+57 RT., 18 LF (8")

**ITEM 679.45 - LIGHT POLE**

POLE V2, 1 EA.

**ITEM 679.47 - BRACKET ARM**

POLE V2, 1 EA.

**ITEM 679.50 - LUMINAIRE**

POLE V2, 1 EA.

**INTERCONNECT ITEMS**

**ITEM 678.20 (MOD.) - INTERCONNECTING CABLE (3" PVC SCHEDULE 40)**

324+20 RT. (I-24) - 326+90 RT. (I-25), 270 LF  
 326+90 RT. (I-25) - 327+00 RT., 10 LF

**ITEM 678.21 - ELECTRICAL CONDUIT (3" PVC SCHEDULE 40)**

321+00 RT. - 322 RT. (I-23), 124 LF

**ITEM 678.26 - JUNCTION BOX**

326+90, 44' RT. (I-25)

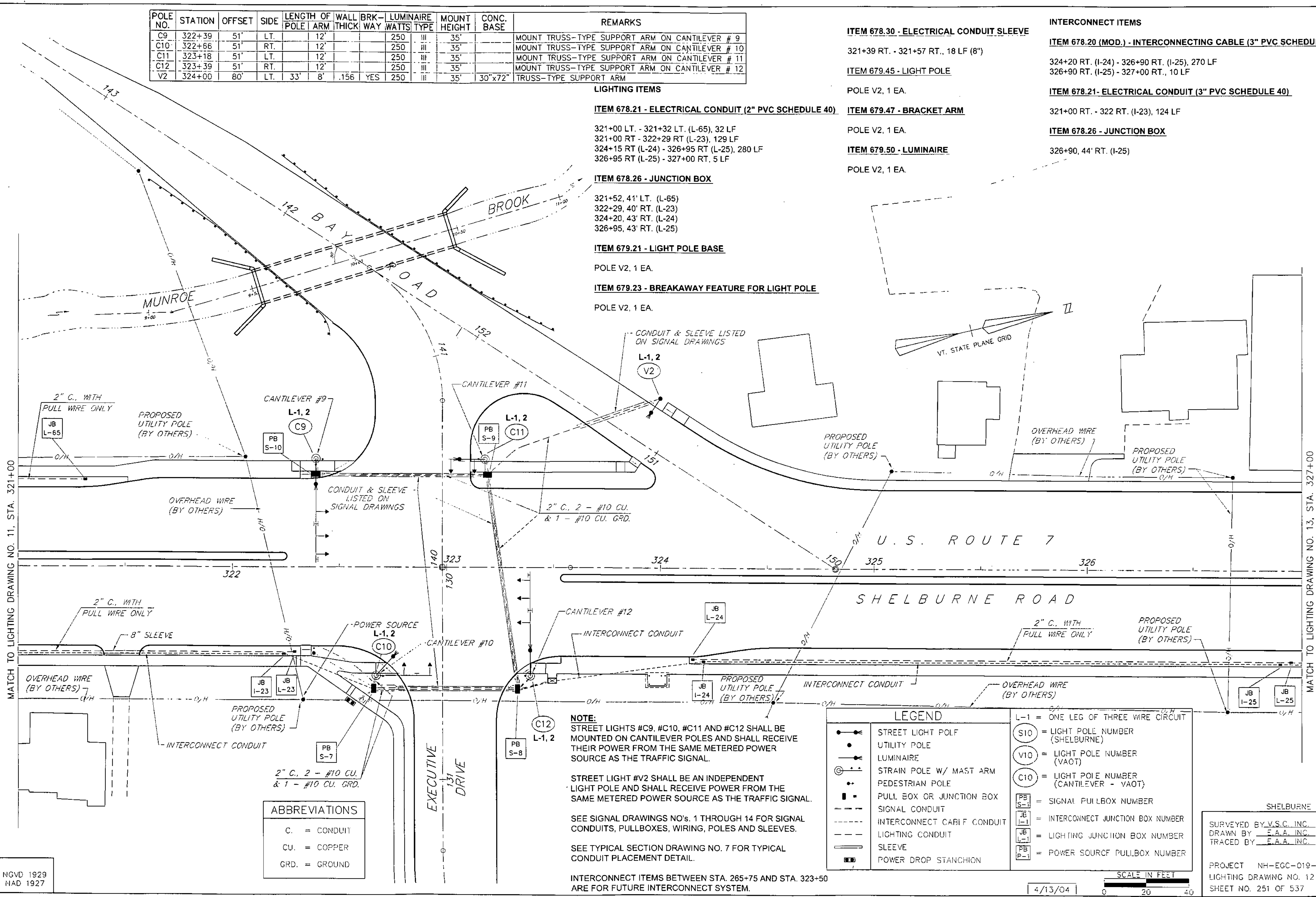

**NOTE:**  
 STREET LIGHTS #C9, #C10, #C11 AND #C12 SHALL BE MOUNTED ON CANTILEVER POLES AND SHALL RECEIVE THEIR POWER FROM THE SAME METERED POWER SOURCE AS THE TRAFFIC SIGNAL.  
 STREET LIGHT #V2 SHALL BE AN INDEPENDENT LIGHT POLE AND SHALL RECEIVE POWER FROM THE SAME METERED POWER SOURCE AS THE TRAFFIC SIGNAL.  
 SEE SIGNAL DRAWINGS NO'S. 1 THROUGH 14 FOR SIGNAL CONDUITS, PULLBOXES, WIRING, POLES AND SLEEVES.  
 SEE TYPICAL SECTION DRAWING NO. 7 FOR TYPICAL CONDUIT PLACEMENT DETAIL.  
 INTERCONNECT ITEMS BETWEEN STA. 285+75 AND STA. 323+50 ARE FOR FUTURE INTERCONNECT SYSTEM.

LEGEND	
	STREET LIGHT POLE
	UTILITY POLE
	LUMINAIRE
	STRAIN POLE W/ MAST ARM
	PEDESTRIAN POLE
	PULL BOX OR JUNCTION BOX
	SIGNAL CONDUIT
	INTERCONNECT CABLE CONDUIT
	LIGHTING CONDUIT
	SLEEVE
	POWER DROP STANCHION
	L-1 = ONE LEG OF THREE WIRE CIRCUIT
	S10 = LIGHT POLE NUMBER (SHELBURNE)
	V10 = LIGHT POLE NUMBER (VAOT)
	C10 = LIGHT POLE NUMBER (CANTILEVER - VAOT)
	PB S-1 = SIGNAL PULLBOX NUMBER
	JB I-1 = INTERCONNECT JUNCTION BOX NUMBER
	JB L-1 = LIGHTING JUNCTION BOX NUMBER
	PB P-1 = POWER SOURCE PULLBOX NUMBER

ABBREVIATIONS	
C.	= CONDUIT
CU.	= COPPER
GRD.	= GROUND

DATUM  
 VERTICAL NGVD 1929  
 HORIZONTAL HAD 1927

SHELBURNE  
 SURVEYED BY V.S.C. INC. DATE \_\_\_\_\_  
 DRAWN BY E.A.A. INC. DATE \_\_\_\_\_  
 TRACED BY E.A.A. INC. DATE \_\_\_\_\_  
 PROJECT NH-EGC-019-4(27)  
 LIGHTING DRAWING NO. 12  
 SHEET NO. 251 OF 537

SCALE IN FEET  
 0 20 40  
 4/13/04