

LIGHTING ITEMS

ITEM 678.21 - ELECTRICAL CONDUIT (2" PVC SCHEDULE 40)

279+00 LT. - 280+08 LT. (L-51), 108 LF
 279+00 RT. - 280+05 RT. (L-7), 105 LF
 280+05 RT. (L-7) - 282+80 RT. (L-8), 275 LF
 280+08 LT. (L-51) - 282+60 LT. (L-52), 252 LF
 282+60 LT. (L-52) - 284+64 LT. (L-53), 204 LF
 282+80 RT. (L-8) - 285+00 RT., 220 LF

ITEM 678.26 - JUNCTION BOX

280+05, 38' RT. (L-7)
 280+08, 45' LT. (L-51)
 282+60, 41' LT. (L-52)
 282+80, 42' RT. (L-8)
 284+64, 41' LT. (L-53)

ITEM 678.30 - ELECTRICAL CONDUIT SLEEVE

282+40 RT. - 282+66 RT., 26 LF (8")
 282+76 LT. - 283+36 LT., 60 LF (8")

INTERCONNECT ITEMS

ITEM 678.21- ELECTRICAL CONDUIT (3" PVC SCHEDULE 40)

279+00 RT. - 280+00 RT. (I-7), 100 LF
 280+00 RT. (I-7) - 282+75 RT. (I-8), 275 LF
 282+75 RT. (I-8) - 285+00 RT., 225 LF

ITEM 678.26 - JUNCTION BOX

280+00, 39' RT. (I-7)
 282+75, 43' RT. (I-8)

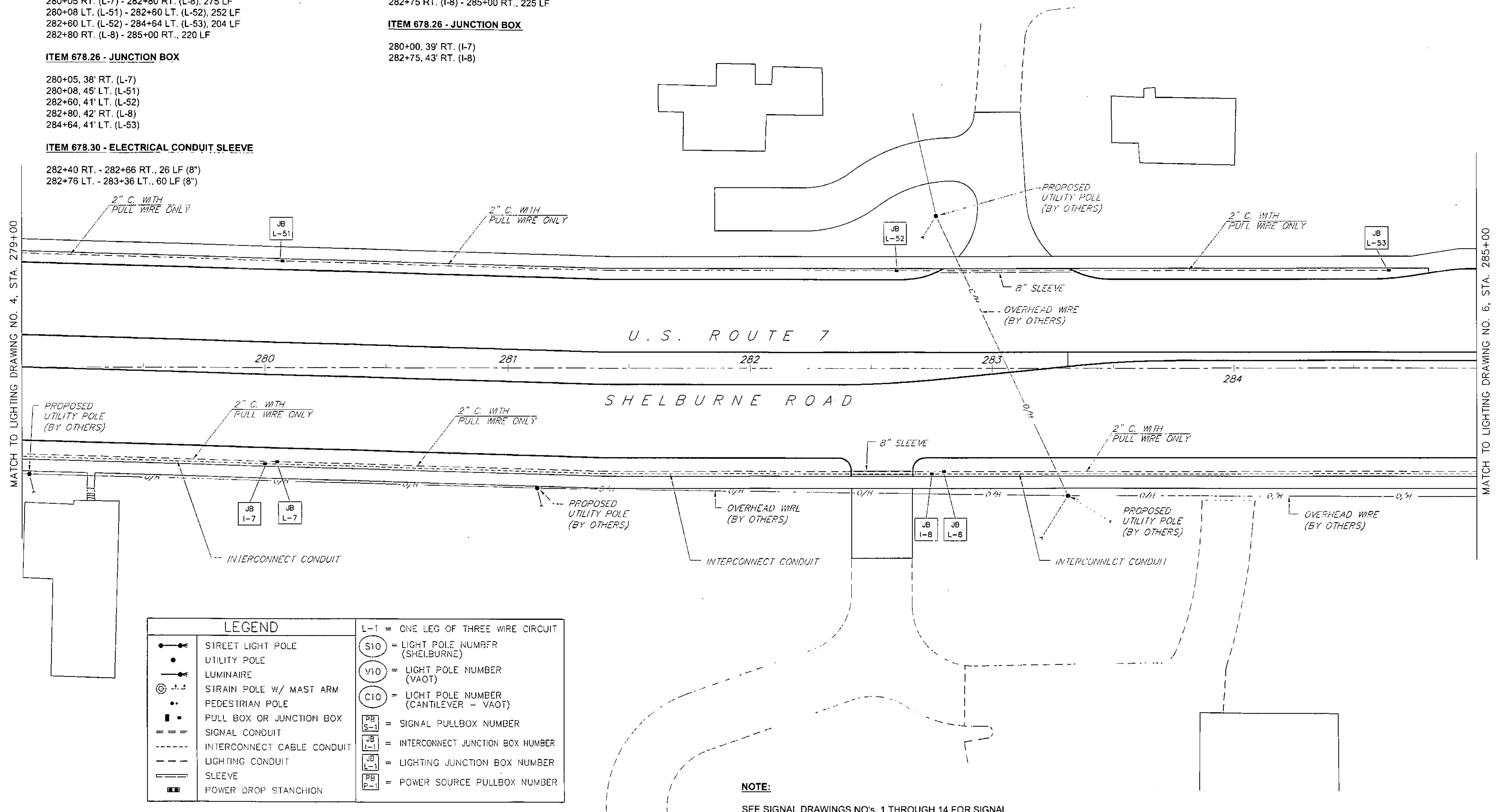
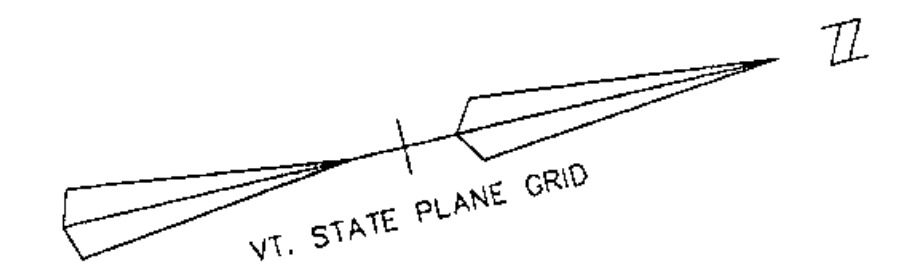

| LEGEND | |
|--------|---|
| | STREET LIGHT POLE |
| | UTILITY POLE |
| | LUMINAIRE |
| | STRAIN POLE W/ MAST ARM |
| | PEDESTRIAN POLE |
| | PULL BOX OR JUNCTION BOX |
| | SIGNAL CONDUIT |
| | INTERCONNECT CABLE CONDUIT |
| | LIGHTING CONDUIT |
| | SLEEVE |
| | POWER DROP STANCHION |
| | L-1 = ONE LEG OF THREE WIRE CIRCUIT |
| | S10 = LIGHT POLE NUMBER (SHELBURNE) |
| | V10 = LIGHT POLE NUMBER (VAOT) |
| | C10 = LIGHT POLE NUMBER (CANTILEVER - VAOT) |
| | PB S-1 = SIGNAL PULLBOX NUMBER |
| | JB L-1 = INTERCONNECT JUNCTION BOX NUMBER |
| | JB I-1 = LIGHTING JUNCTION BOX NUMBER |
| | PB P-1 = POWER SOURCE PULLBOX NUMBER |

| ABBREVIATIONS | |
|---------------|-----------|
| C. | = CONDUIT |
| CU. | = COPPER |
| GRD. | = GROUND |

NOTE:
 SEE SIGNAL DRAWINGS NO's. 1 THROUGH 14 FOR SIGNAL CONDUITS, PULLBOXES, WIRING, POLES AND SLEEVES.
 SEE TYPICAL SECTION DRAWING NO. 7 FOR TYPICAL CONDUIT PLACEMENT DETAIL.
 INTERCONNECT ITEMS BETWEEN STA. 265+75 AND STA. 323+50 ARE FOR FUTURE INTERCONNECT SYSTEM.

DATUM
 VERTICAL NCGVD 1929
 HORIZONTAL NAD 1927

SHELBURNE
 SURVEYED BY V.S.C. INC. DATE _____
 DRAWN BY E.A.A. INC. DATE _____
 TRACED BY E.A.A. INC. DATE _____
 PROJECT NH-EGC-019-4(27)
 LIGHTING DRAWING NO. 5
 SHEET NO. 244 OF 537

