

MATCH LINE TO SHEET - 21A

HOLMES ROAD

PL

LAKWOOD ASSOCIATES
(JOHN C. GIBBINK)

MATCH TO PLAN DRAWING NO. 22, STA. 429+00

MATCH TO PLAN DRAWING NO. 20, STA. 423+00

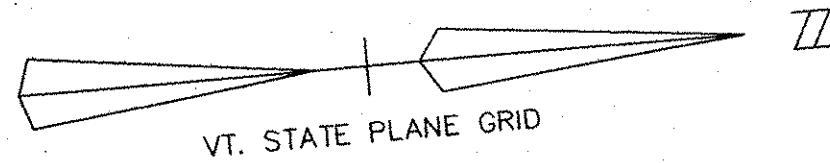

Install (N)P5/VZ2
50' #2 POLE
1-TRI X-ARM
DBL D.E. W/JUMP
1-(SO-GMP)
ANCH & 3-GUY
1-(SO-VZ) ANCH
2-NEUT DE

Remove (N)P5/VZ2

Transfer 3# 336 PRI & 4/0 NEUT

NOTE: FRONT ANCH FOR PHONE ONLY

Install (N&E)P34/VZ91
55' #1 POLE
1-DBL ALLEY
X-ARM
1-TRI X-ARM
D.E.
45' OF 3# 477 PRI & 4/0 NEUT-WEST
25' OF #6 TRI SEC
1-25KVA XFMR +CO
1-NEUT D.E.
1-NEUT BKT

Remove (N&E)P34/VZ91
TOP 45' POLE
1-DBL X-ARM
D.E.
1-DBL X-ARM
TANG
68' OF 3# 336 NEUT OFF BACK SPAN FOR P4
2-NEUT BKT

Transfer 3# PRI & NEUT SWING OH SERV FOR TRAFFIC CONTROLLER OFF (E)P4/VZ1

NOTE: SEE (E)P4/VZ1

Install (N&R)P33/VZ90
50' #2 POLE
1-SGL X-ARM
1-DBL X-ARMS
D.E.
3-CO @ 12K
193' OF 3# 477 PRI & 4/0 NEUT
193' OF #4 TRI SEC
1-(JO) ANCH & GUY W/BUMPER POSTS
1-NEUT BKT
1-NEUT DE
2-SEC D.E.

Remove (N&R)P33/VZ90
45' POLE
1-SGL X-ARM
1-50KVA XFMR + CO
1-1# PRI D.E.
190' OF 3# 336 PRI & 1/0 NEUT
1-NEUT BKT
1-NEUT D.E.
DISCONNECT UNG SERV & METER

Install (N&R)P32/VZ89
50' #2 POLE
1-DBL X-ARM
D.E.
1-AIR BREAK SW
6-ARR

Remove (N&R)P32/VZ89
45' POLE
1-DBL X-ARM
D.E.
1-AIR BREAK SW
6-ARR

Transfer OR TRANSF AIR BREAK SW

FOR: 3268
133' OF 3# 477 PRI & 4/0 NEUT

FOR: 3264
130' OF 3# 477 PRI & 4/0 NEUT
1-NEUT BKT

Install (N&R)P31/VZ88
50' #2 POLE
1-TRI 10' X-ARM
DBL D.E. W/JUMP
1-3# BANK, W/3-15# + 3-CO @ 120/208
15' OF 3# 477 PRI & 4/0 NEUT
1-(JO) ANCH & GUY
1-(SO-GMP) ANCH & 3-GUYS
1-(SO-VZ) ANCH
2-NEUT DE

Remove (N&R)P31/VZ88
45' POLE
1-SGL X-ARM
1-DBL X-ARM
D.E.
1-3# BANK, W/3-15# + 3-CO

Transfer 2-3# OH SERV FROM (R)P31
1-STREET LIGHT REMOVE & TRANSF TO P30-50

NOTE: FRONT ANCH FOR OTHERS

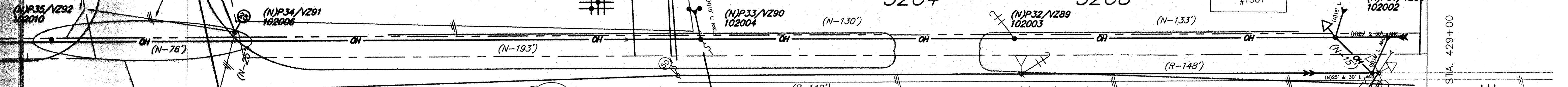

Install (N)P35/VZ92
55' #1 POLE
1-DBL ALLEY
X-ARM
76' OF 3# 477 PRI & 4/0 NEUT
1-NEUT BKT

Remove (N)P35/VZ92
40' POLE
1-SGL X-ARM
112' OF 3# 336 PRI & 1/0 NEUT
1-15KVA XFMR + CO
1-ANCH & GUY
1-NEUT BKT

NOTE: NEUT TO RUN AT 38' ELEV. OR 9' DOWN FROM TOP OF POLES THROUGH INTERSECTION (TYPICAL) TO CLEAR NEW LIGHT STANDARDS

Install (N)P30-50/VZ87
50' #2 POLE
1-TRI 10' X-ARM
DBL D.E. W/JUMP
1-DBL D.E.
X-ARM
3-CO @ 80K FUSES
1-(JO) ANCH & GUY
1-(SO-GMP) ANCH & 3-GUYS
1-(SO-VZ) ANCH
1-SEC D.E.
3-NEUT D.E.

Remove (N)P30-50/VZ87
428

Transfer 3# PRI & NEUT TRI SEC 1-STREET LIGHT FROM P31

NOTE: FRONT ANCH FOR OTHERS

Install (R)P34-01/VZ90A
40' POLE
1-DBL D.E.
X-ARMS
3-C/O & ARR
71' OF 3# 336 PRI & 4/0 NEUT
1-5" PRI UNG RISER
1-ANCH & GUY
1-NEUT D.E.

Remove (R)P34-01/VZ90A

Install (E)PAD 1 #B1080
75' OF 3# 1/0 UNG PRI & NEUT
3-LB ELBOWS
25'-OF TRENCH, INSTALL 5" DUCT & BACKFILL

Remove (E)PAD 1 #B1080
245' OF 3# 1/0 UNG PRI & NEUT
3-LOAD BREAK ELBOWS

NOTE: CORRECT ROTATION IN XFMR

(E)PAD 34-01-1 to 33-02 #B1080 150KVA

Install (N)P33-01/VZ90A
45' #3 POLE
1-DBL X-ARM
D.E.
3-C/O @ 10K FUSES & ARR
1-5" 3 # UNG PRI RISER
107' OF 3# 1/0 PRI & NEUT
1-(JO) ANCH & GUY
1-NEUT D.E.

Remove (N)P33-01/VZ90A

Install (N)P1/VZ1
45' #3 POLE
1-DBL D.E.
X-ARMS W/JUMP
142' OF 3# 1/0 PRI & NEUT
142' OF #6 TRI SEC
2-(JO) ANCH & 2-GUYS
2-NEUT D.E.

Remove (N)P1/VZ1

Transfer 3# 1/0 PRI & NEUT 1-STREET LIGHT, FACE TOWARDS INTERSECTION

Install (E)P2/VZ2
38' OF 1/0 3# PRI & NEUT OFF BACK SPAN OF P2

Remove (E)P2/VZ2

SHEET 282 OF 283

GREEN MOUNTAIN POWER CORPORATION
SOUTH BURLINGTON, VERMONT
12470Y 4W 3PH FEEDER

3264 OVERHEAD

SHELburne ROAD RECONSTRUCTION

DRAWN: LAW	CHECKED: MM	APPROVED: WH	SCALE: 1"=20'
DATE: 6-21-02	DRAWING NO. PL-32_4_21	SHEET: 21	

ROUTE 7 PHASE - 1" JOB ITEM # ARE-00712-86124
DRAWINGS/DISTRB/ROUTE7/RECEIVED 3-4-02/A0054591101