

DATUM ELEV = 155.00

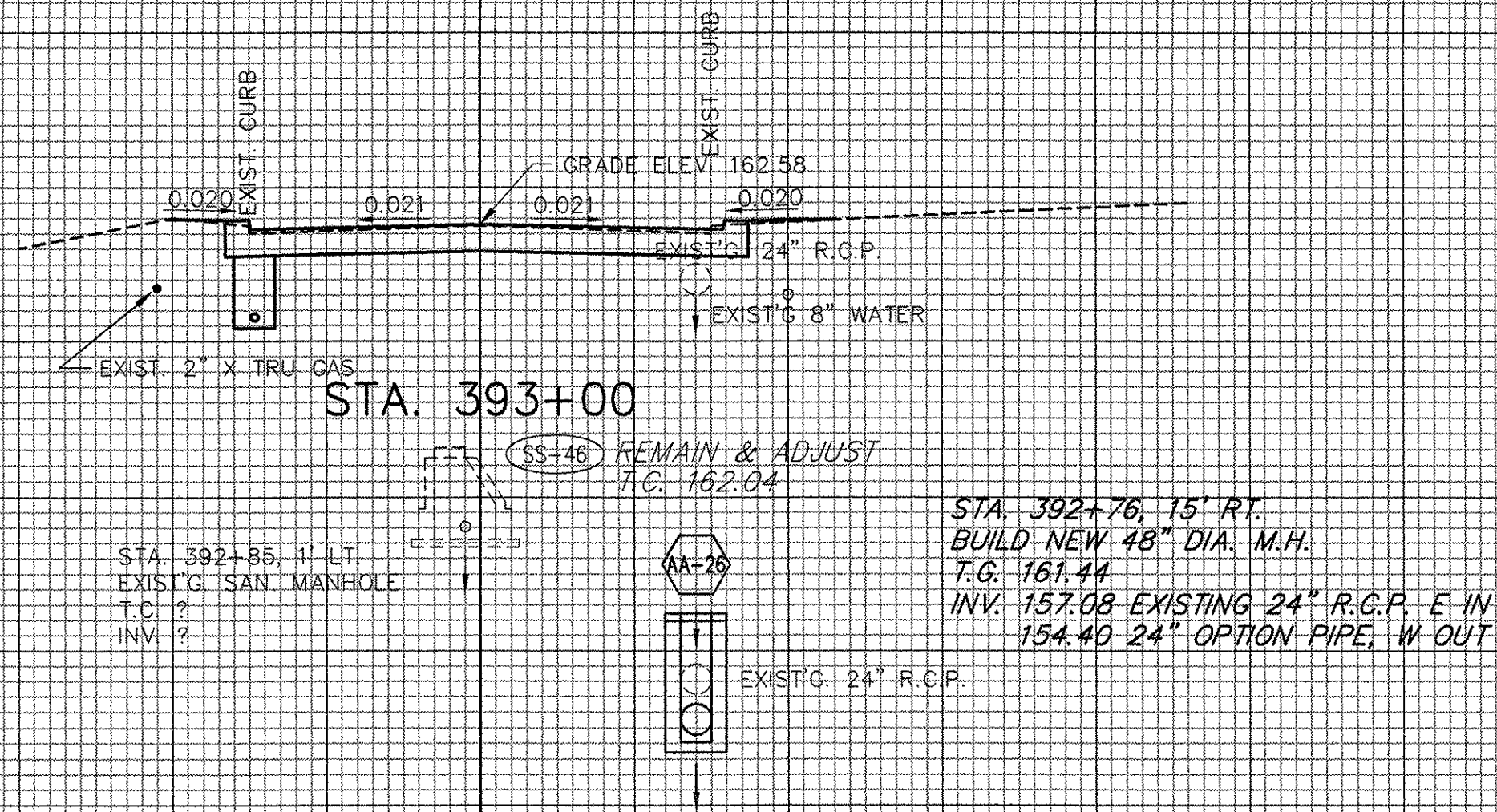

DATUM ELEV = 155.00

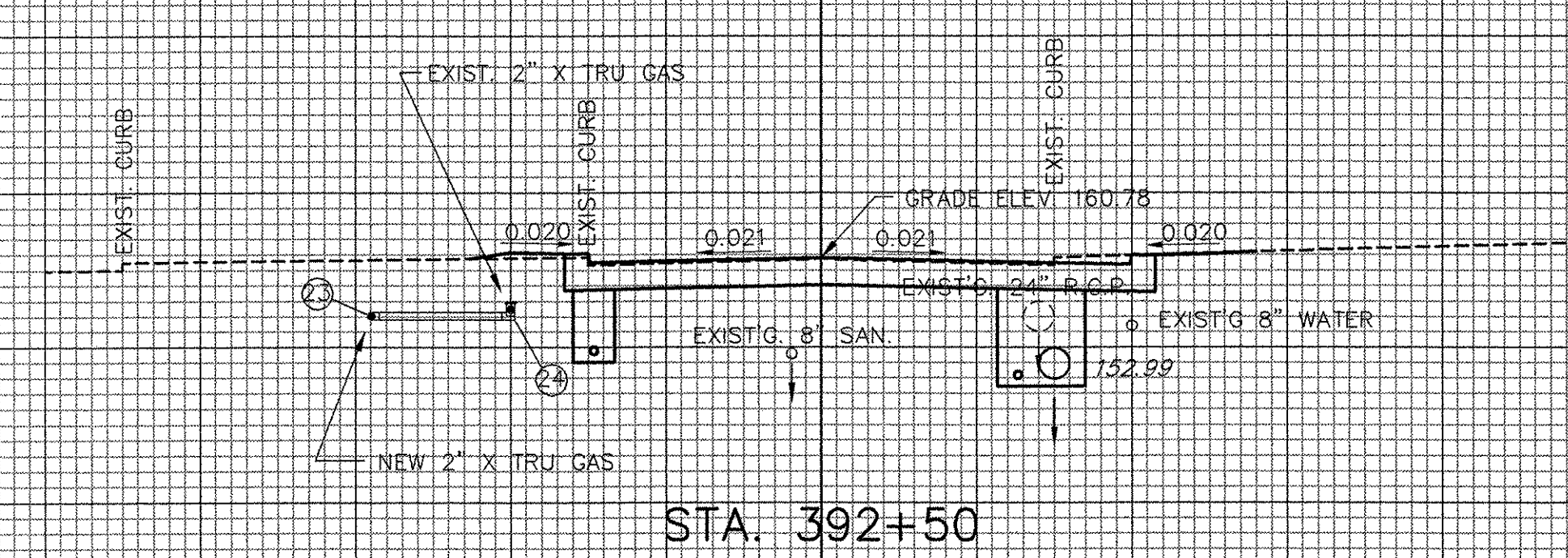

STA. 392+48--393+00 LT GRN MTN : EXIST. 2" X TRU STEEL GAS INST. 9/21/78 TO REMAIN IN PLACE.

DATUM ELEV = 150.00

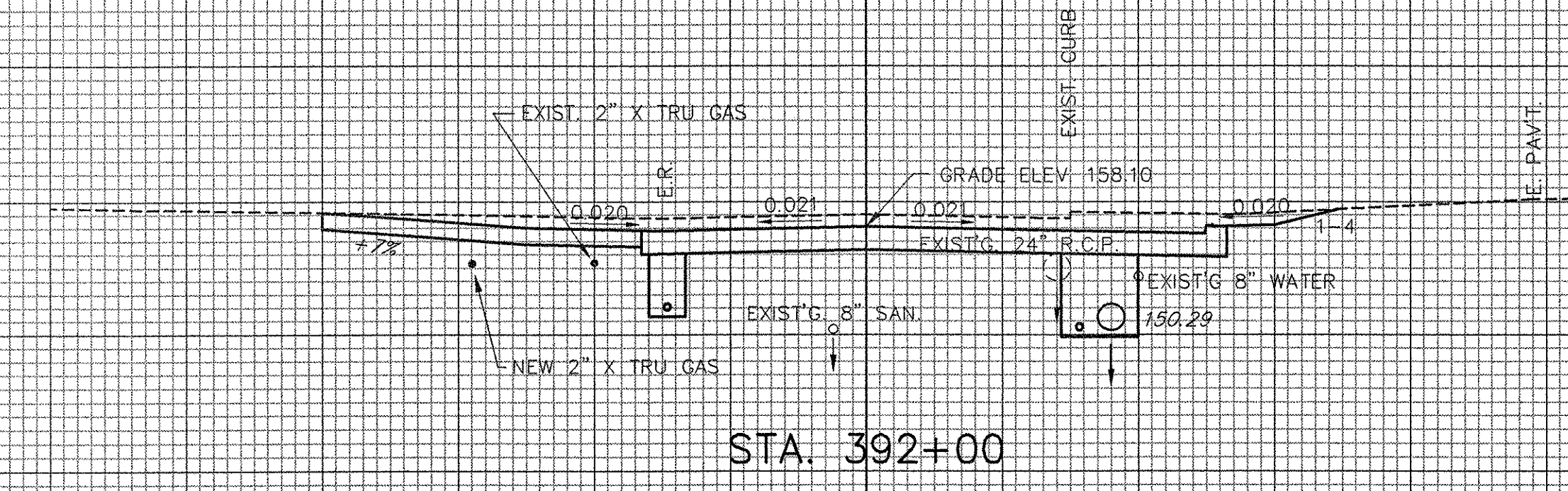

STA. 390+40.52--392+50 LT GRN MTN : INST. NEW 2" X TRU STEEL GAS

STA. 390+34.7--392+48 LT GRN MTN : EXIST. 2" X TRU STEEL GAS TO BE RETIRED IN PLACE. ORIGINALLY INST. 9/21/78.

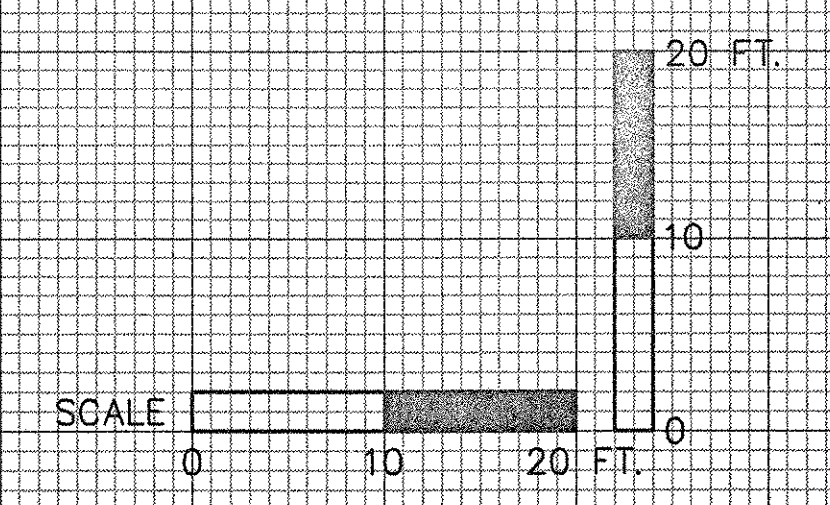

GREEN MOUNTAIN DRIVE

SHELBURNE - SOUTH BURLINGTON

STA. 392+00 TO STA. 393+00

SURVEYED BY V.S.C. INC. DATE _____
 DRAWN BY E.A.A. INC. DATE _____
 TRACED BY E.A.A. INC. DATE _____

PROJECT NH-EGC-019-4(28)
 CROSS-SECTION DWG. NO. 148

SHEET 220 OF 283