

ITEM 641.15 - PORTABLE CHANGEABLE MESSAGE SIGN SHALL BE PLACED ON U.S. ROUTE 7 IN THE NORTHBOUND DIRECTION, AS PER THE ENGINEER.

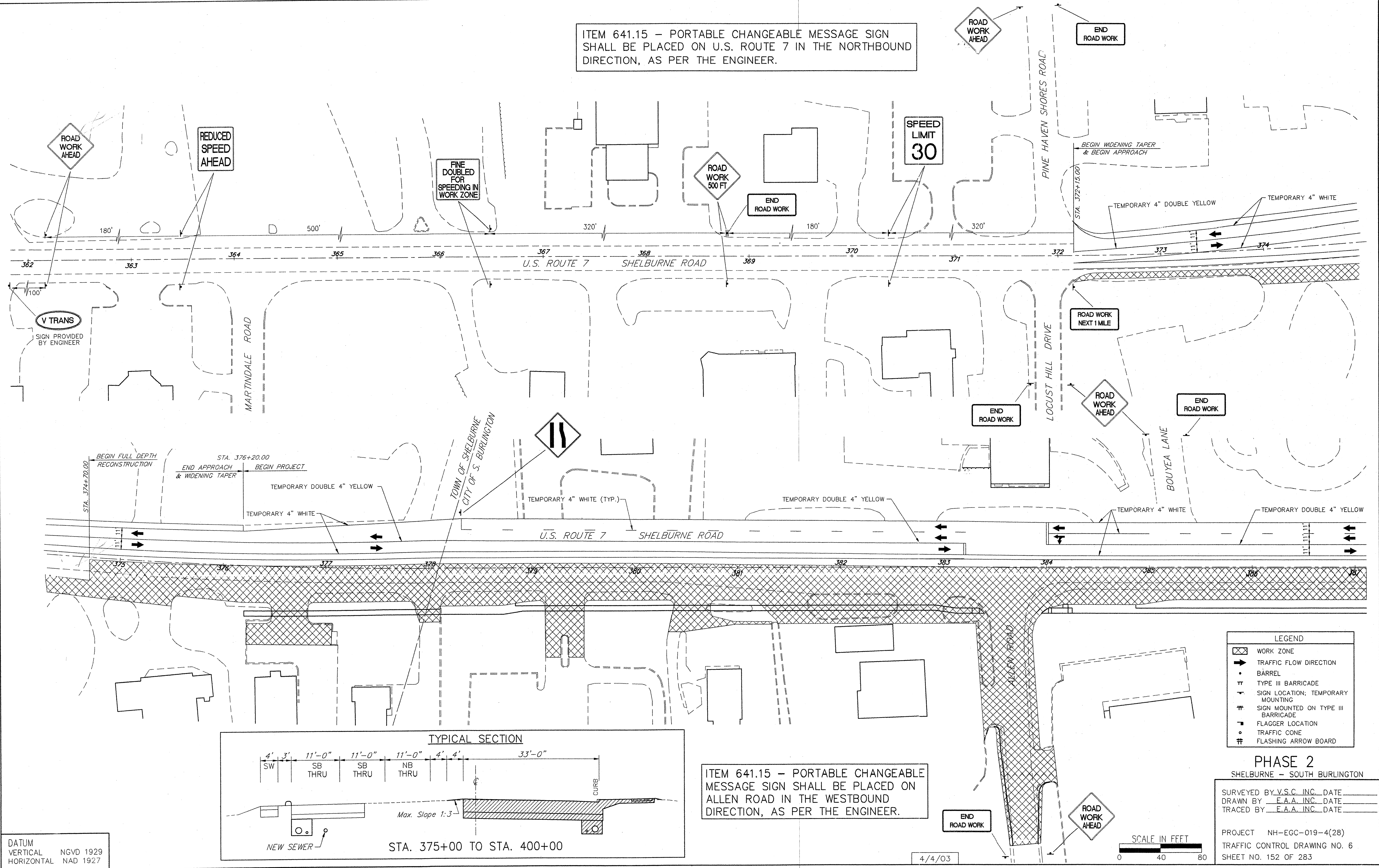

DATUM
 VERTICAL NGVD 1929
 HORIZONTAL NAD 1927

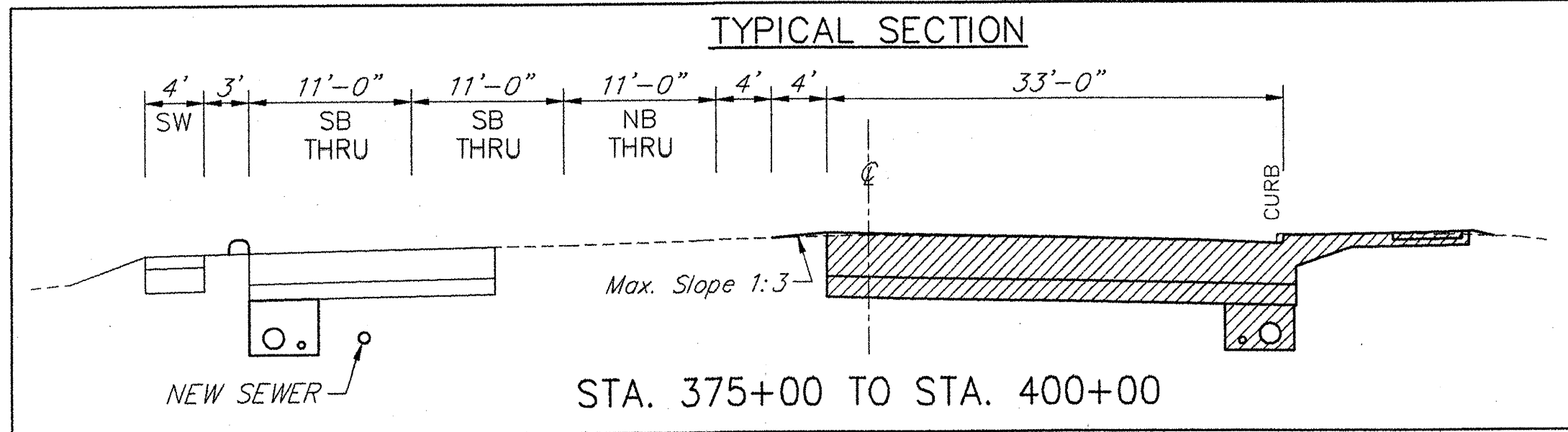

ITEM 641.15 - PORTABLE CHANGEABLE MESSAGE SIGN SHALL BE PLACED ON ALLEN ROAD IN THE WESTBOUND DIRECTION, AS PER THE ENGINEER.

LEGEND

- WORK ZONE
- TRAFFIC FLOW DIRECTION
- BARRREL
- TYPE III BARRICADE
- SIGN LOCATION; TEMPORARY MOUNTING
- SIGN MOUNTED ON TYPE III BARRICADE
- FLAGGER LOCATION
- TRAFFIC CONE
- FLASHING ARROW BOARD

PHASE 2
 SHELburne - SOUTH BURLINGTON

SURVEYED BY V.S.C. INC. DATE _____
 DRAWN BY E.A.A. INC. DATE _____
 TRACED BY E.A.A. INC. DATE _____

PROJECT NH-ECC-019-4(28)
 TRAFFIC CONTROL DRAWING NO. 6
 SHEET NO. 152 OF 283

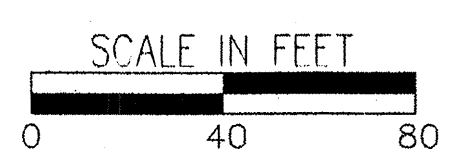

4/4/03