

ITEM 641.15 - PORTABLE CHANGEABLE MESSAGE SIGN SHALL BE PLACED ON U.S. ROUTE 7 IN THE NORTHBOUND DIRECTION, AS PER THE ENGINEER.

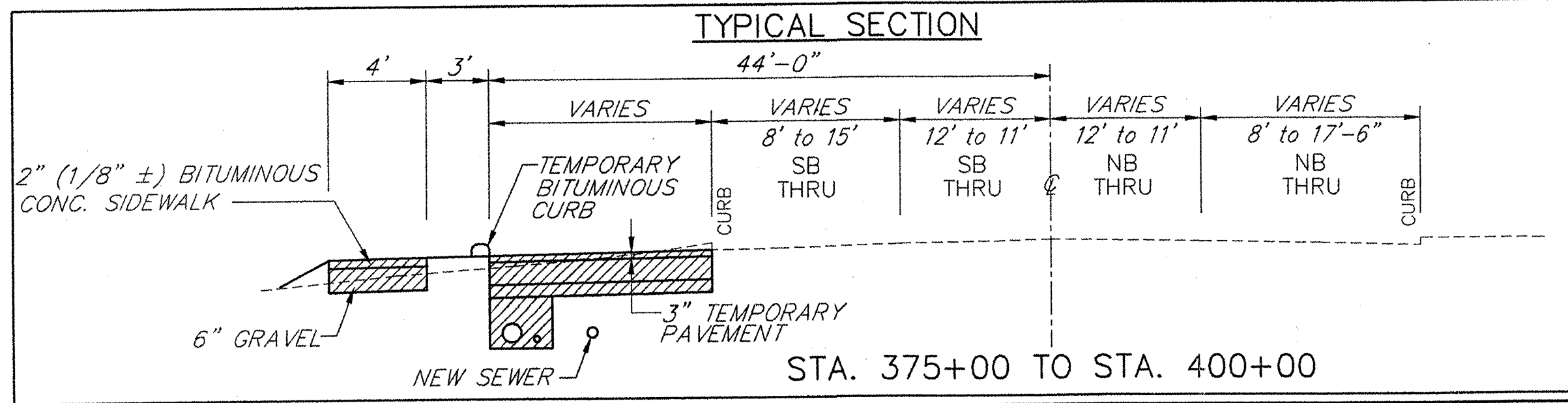
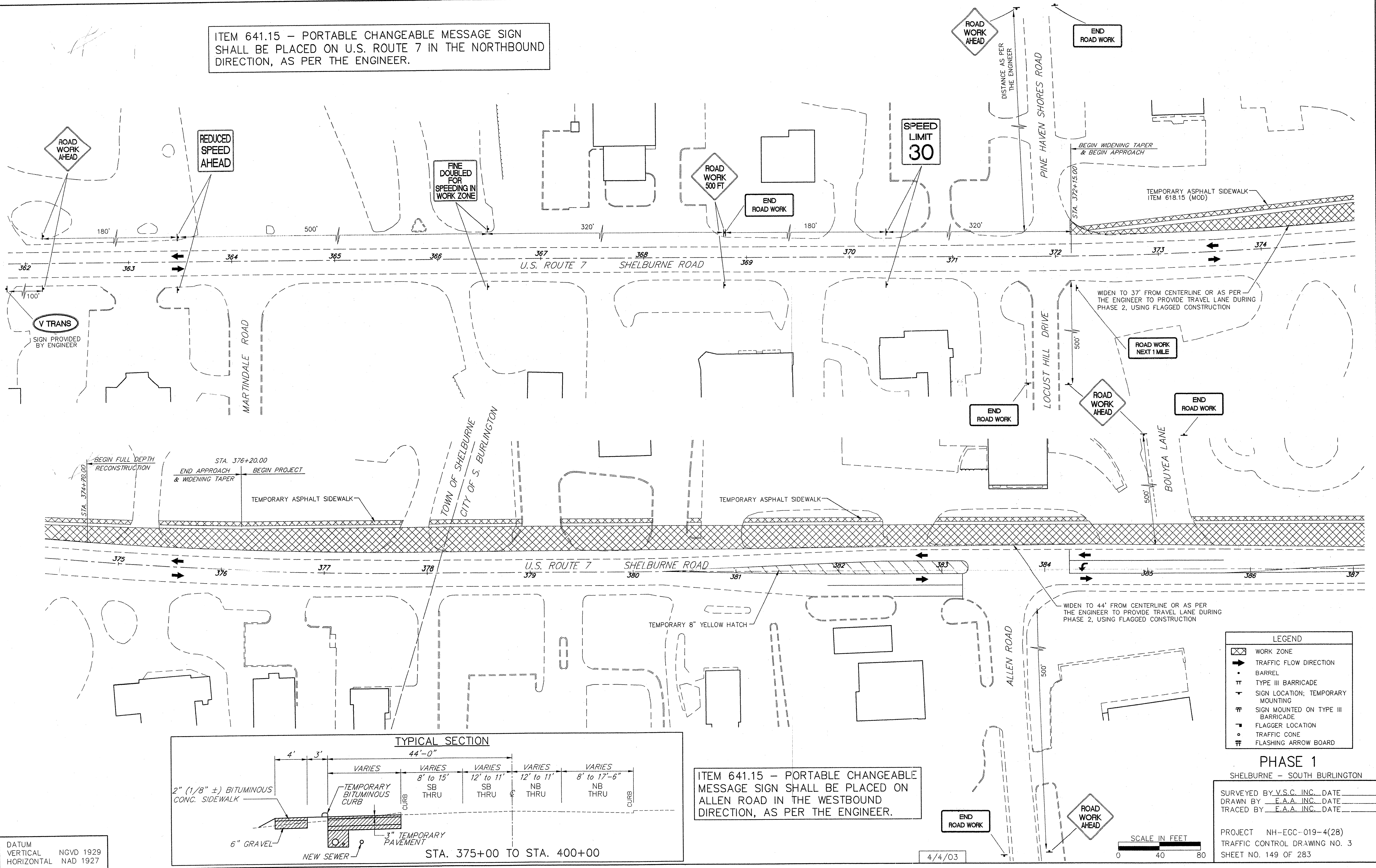

ITEM 641.15 - PORTABLE CHANGEABLE MESSAGE SIGN SHALL BE PLACED ON ALLEN ROAD IN THE WESTBOUND DIRECTION, AS PER THE ENGINEER.

LEGEND	
[Cross-hatched box]	WORK ZONE
[Arrow]	TRAFFIC FLOW DIRECTION
[Barrel symbol]	BARREL
[Barricade symbol]	TYPE III BARRICADE
[Sign symbol]	SIGN LOCATION; TEMPORARY MOUNTING
[Sign on barricade symbol]	SIGN MOUNTED ON TYPE III BARRICADE
[Flagger symbol]	FLAGGER LOCATION
[Cone symbol]	TRAFFIC CONE
[Arrow board symbol]	FLASHING ARROW BOARD

PHASE 1
SHELBURNE - SOUTH BURLINGTON

SURVEYED BY V.S.C. INC. DATE _____
DRAWN BY E.A.A. INC. DATE _____
TRACED BY E.A.A. INC. DATE _____

PROJECT NH-ECC-019-4(28)
TRAFFIC CONTROL DRAWING NO. 3
SHEET NO. 149 OF 283

DATUM
VERTICAL NGVD 1929
HORIZONTAL NAD 1927

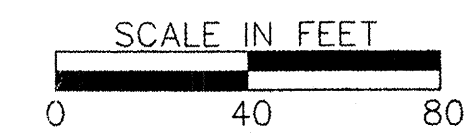

4/4/03