

**LIGHTING ITEMS**

**ITEM 678.21 - ELECTRICAL CONDUIT (2" PVC SCHEDULE 40)**

416+50 LT (POLE NO. SB39) - 417+00 LT, 56 LF

**ITEM 678.23 - WIRED CONDUIT (2" PVC SCHEDULE 40)**

411+00 LT - 411+05 LT (POLE NO. SB33), 11 LF  
 411+00 RT - 411+90 RT (POLE NO. SB34), 96 LF  
 411+05 LT (POLE NO. SB33) - 412+80 LT (POLE NO. SB35), 187 LF  
 411+90 RT (POLE NO. SB34) - 413+60 RT (POLE NO. SB36), 182 LF  
 412+80 LT (POLE NO. SB35) - 414+45 LT (POLE NO. SB37), 177 LF  
 413+60 RT (POLE NO. SB36) - 415+30 RT (POLE NO. SB38), 182 LF  
 414+45 LT (POLE NO. SB37) - 416+50 LT (POLE NO. SB39), 217 LF  
 415+30 RT (POLE NO. SB38) - 417+00 RT (POLE NO. SB40), 182 LF

**ITEM 678.26 - JUNCTION BOX**

412+90, 55' LT (FUTURE USE)  
 412+90, 44' RT (FUTURE USE)

**ITEM 678.30 - ELECTRICAL C...**

412+02 RT - 412+42 RT, 40 LF  
 412+30 LT - 412+71 LT, 41 LF (6")  
 412+90 LT - 412+90 RT, 99 LF (8")  
 414+00 LT - 414+30 LT, 30 LF (6")

**INTERCONNECT ITEMS**

**ITEM 678.20 (MOD.) - INTERCONNECTING CABLE (2" PVC SCHEDULE 40)**

411+00 RT - 412+53 RT (I-41), 153 LF  
 412+53 RT (I-41) - 415+28 RT (I-42), 275 LF  
 415+28 RT (I-42) - 417+00 RT, 172 LF

**ITEM 678.26 - JUNCTION BOX**

412+53, 37' RT. (I-41)  
 415+28, 37' RT. (I-42)

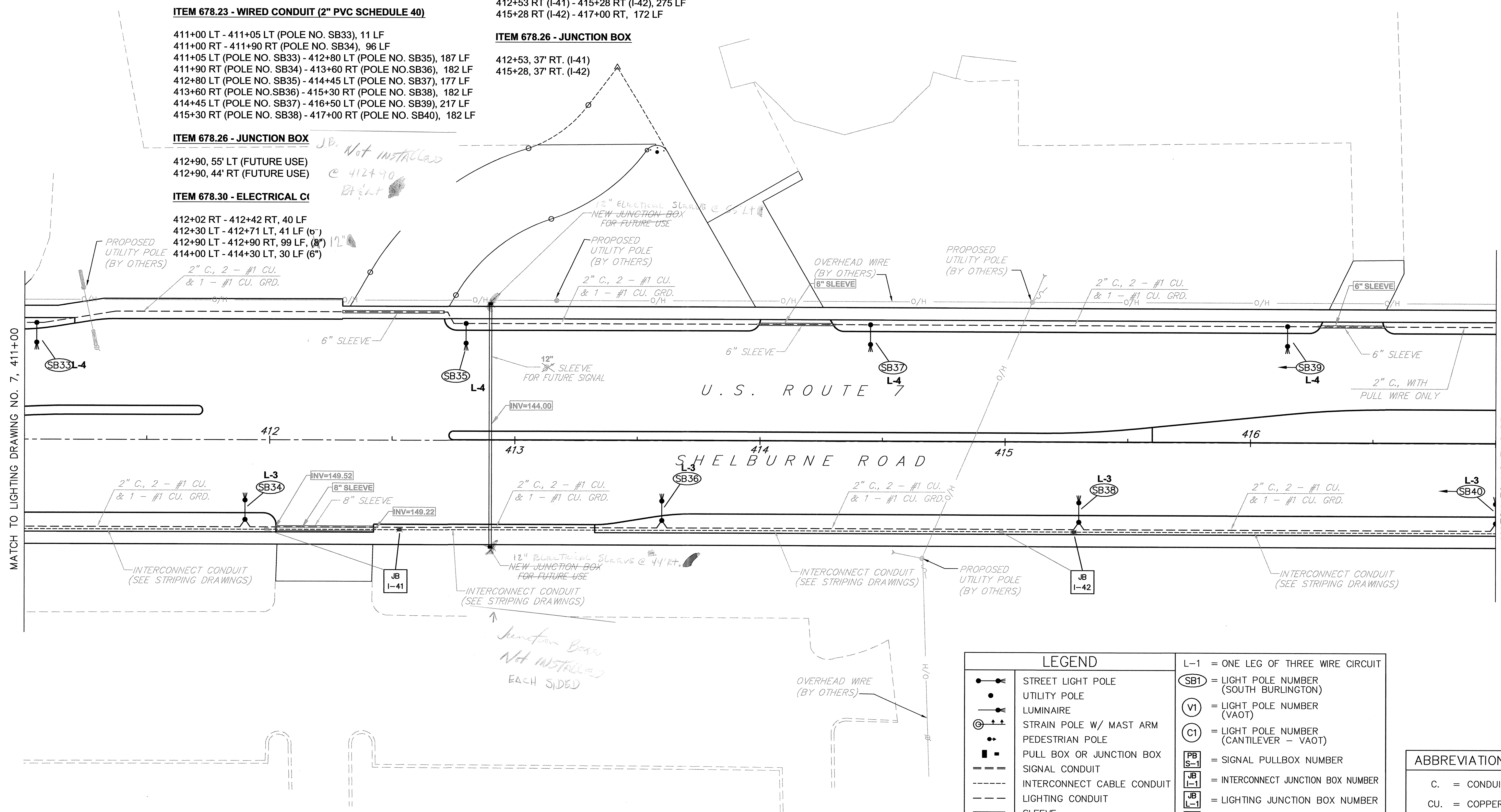
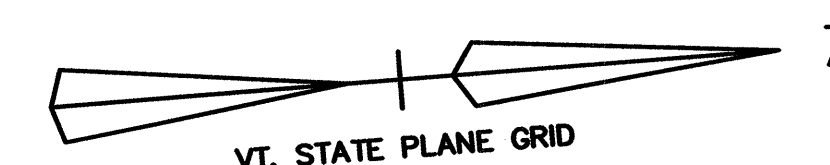

MATCH TO LIGHTING DRAWING NO. 7, 411+00

MATCH TO LIGHTING DRAWING NO. 19, 417+00

DATUM  
 VERTICAL NGVD 1929  
 HORIZONTAL NAD 1927

POLE NO.	STATION	OFFSET	SIDE	LENGTH OF POLE	ARM	WALL THICK	BRK-WAY	LUMINAIRE WATTS	TYPE	MOUNT HEIGHT	CONC. BASE	REMARKS
SB33	411+05	47'	LT.	33'	8'	.156	YES	150	III	35'	80"20"x72"	TRUSS-TYPE SUPPORT ARM
SB34	411+90	33'	RT.	33'	8'	.156	YES	150	III	35'	80"20"x72"	TRUSS-TYPE SUPPORT ARM
SB35	412+80	47'	LT.	33'	8'	.156	YES	150	III	35'	80"20"x72"	TRUSS-TYPE SUPPORT ARM
SB36	413+60	33'	RT.	33'	8'	.156	YES	150	III	35'	80"20"x72"	TRUSS-TYPE SUPPORT ARM
SB37	414+45	47'	LT.	33'	8'	.156	YES	150	III	35'	80"20"x72"	TRUSS-TYPE SUPPORT ARM
SB38	415+30	33'	RT.	33'	8'	.156	YES	150	III	35'	80"20"x72"	TRUSS-TYPE SUPPORT ARM
SB39	416+15	47'	LT.	33'	8'	.156	YES	150	III	35'	80"20"x72"	TRUSS-TYPE SUPPORT ARM
SB40	417+00	33'	RT.	33'	8'	.156	YES	150	III	35'	80"20"x72"	TRUSS-TYPE SUPPORT ARM

**AS-BUILT LEGEND**

- WATER AS-BUILTS
- SEWER AS-BUILTS
- DRAINAGE AS-BUILTS
- ELECTRICAL AS-BUILTS
- PAVEMENT / OTHER AS-BUILTS

**AS-BUILT REVISIONS**

NO.	DATE	DESCRIPTION
1.	3/8/06	ADDED LIGHTING CONDUIT SLEEVES
2.	6/26/06	ADDED LIGHTING CONDUIT INVERTS

**LEGEND**

- STREET LIGHT POLE
- UTILITY POLE
- LUMINAIRE
- ⊕ STRAIN POLE W/ MAST ARM
- ⊙ PEDESTRIAN POLE
- PULL BOX OR JUNCTION BOX
- SIGNAL CONDUIT
- INTERCONNECT CABLE CONDUIT
- - - - LIGHTING CONDUIT
- SLEEVE
- POWER DROP STANCHION

**ABBREVIATIONS**

- L-1 = ONE LEG OF THREE WIRE CIRCUIT
- (SB1) = LIGHT POLE NUMBER (SOUTH BURLINGTON)
- (V1) = LIGHT POLE NUMBER (VAOT)
- (C1) = LIGHT POLE NUMBER (CANTILEVER - VAOT)
- [PB S-1] = SIGNAL PULLBOX NUMBER
- [JB I-1] = INTERCONNECT JUNCTION BOX NUMBER
- [JB L-1] = LIGHTING JUNCTION BOX NUMBER
- [PB P-1] = POWER SOURCE PULLBOX NUMBER

**ABBREVIATIONS**

- C. = CONDUIT
- CU. = COPPER
- GRD. = GROUND

**NOTE:**

SEE SIGNAL DRAWINGS NO's. 1 THROUGH 6 FOR SIGNAL CONDUITS, PULLBOXES, WIRING, POLES AND SLEEVES.

SEE TYPICAL SECTION DRAWING NO. 5 FOR TYPICAL CONDUIT PLACEMENT DETAIL.

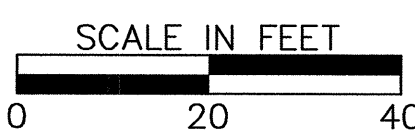

SHELburne - SOUTH BURLINGTON

SURVEYED BY V.S.C. INC. DATE \_\_\_\_\_  
 DRAWN BY E.A.A. INC. DATE \_\_\_\_\_  
 TRACED BY E.A.A. INC. DATE \_\_\_\_\_

PROJECT NH-EGC-019-4(28)  
 LIGHTING DRAWING NO. 8  
 SHEET NO. 144 OF 283

4/4/03