

NOTES:

- Contractor shall exercise extreme care during all work adjacent to the Munroe Brook and the Bartlett Brook. No silt or debris shall be allowed to wash into the brooks or the adjacent wetlands.
- The contractor shall also adhere to the 2001 version of the State of Vermont Standard Specifications for Construction. Particular attention shall be paid to the following sections:
 - 105.22 Environmental Protection
 - 105.23 Control of Erosion and Siltation
 - 105.24 Pollution Control
 - 105.30 Preservation of the Beds of Streams & Bodies of Waters
 - 204.00 Excavation for Structures
 - 204.04 Preservation of Channel
 - 204.07 Cofferdams
- The contractor is directed to the NPDES permit application.
- City of South Burlington - owned retention pond to be cleaned of sediment before and after project.
- The contractor is directed to section 652 of the special provisions.

- 105.22 Environmental Protection
- 105.23 Control of Erosion and Siltation
- 105.24 Pollution Control
- 105.30 Preservation of the Beds of Streams & Bodies of Waters
- 204.00 Excavation for Structures
- 204.04 Preservation of Channel
- 204.07 Cofferdams

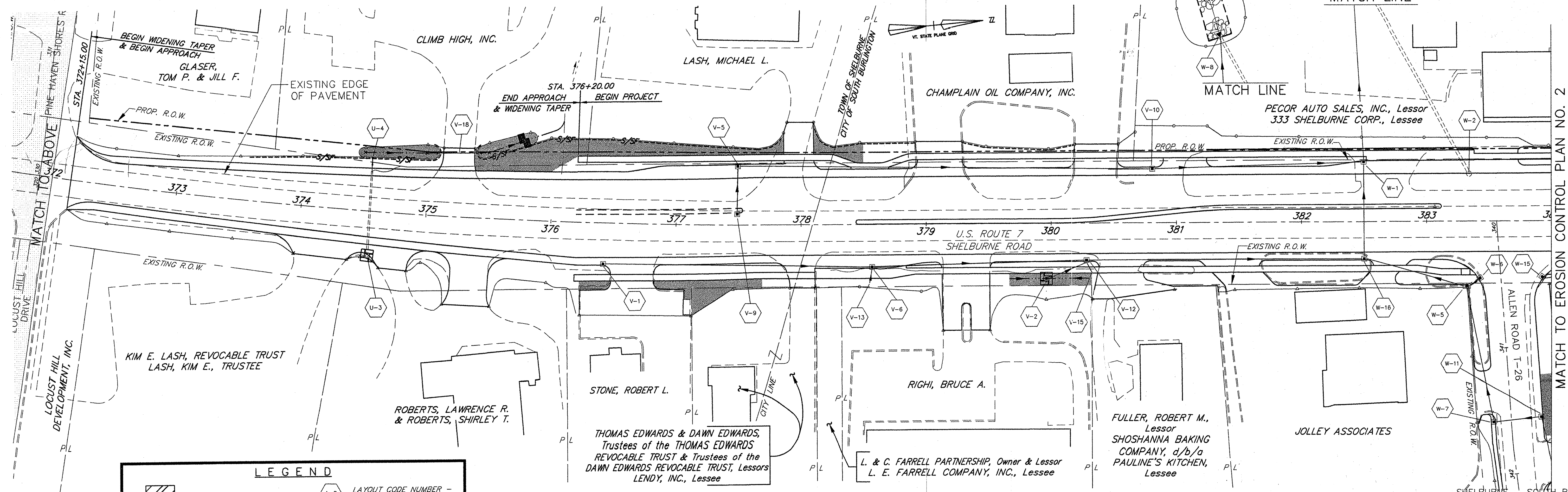

LEGEND

	WETLAND - CLASS II		LAYOUT CODE NUMBER - SEE DRAINAGE DRAWINGS
	WETLAND - CLASS III		STONE CHECK DAM
	COMBINATION SILT/SNOW FENCE		INLET PROTECTION
	SILT FENCE		STONE FILL DITCHES
	TOP OF CUT		EROSION CONTROL MATTING
	TOE OF SLOPE		

	TOTAL PERMANENT IMPACT TO WETLAND	TOTAL TEMPORARY IMPACT TO WETLAND	TOTAL PERMANENT IMPACT TO WETLAND BUFFER	TOTAL TEMPORARY IMPACT TO WETLAND BUFFER	TOTAL PERMANENT FILL IN WATERBODIES BELOW O.H.W. (CY)	TOTAL TEMPORARY FILL IN WATERBODIES BELOW O.H.W. (CY)
WETLAND I	0.06 AC. (CLASS III)	0	0	0	0	0

REFER ALSO TO VERMONT AGENCY OF TRANSPORTATION, DESIGN STANDARDS FOR ROAD AND BRIDGE CONSTRUCTION: TEMPORARY EROSION CONTROL DETAILS, SHEETS T-1 AND T-2.

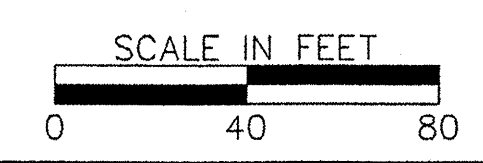

DATUM
VERTICAL NGVD 1929
HORIZONTAL NAD 1927

4/4/03

SURVEYED BY V.S.C. INC. DATE _____
DRAWN BY E.A.A. INC. DATE _____
TRACED BY E.A.A. INC. DATE _____

PROJECT NH-EGC-019-4(28)
EROSION CONTROL PLAN NO. 1
SHEET NO. 55 OF 283

