

JUGHANDLE TO BE CONSTRUCTED PRIOR TO OTHER IMPROVEMENTS ON ROUTE 7. FLAGGING OPERATION TO BE USED.

ITEM 641.15 - PORTABLE CHANGEABLE MESSAGE SIGN SHALL BE PLACED ON U.S. ROUTE 7 IN THE SOUTHBOUND DIRECTION, AS PER THE ENGINEER.

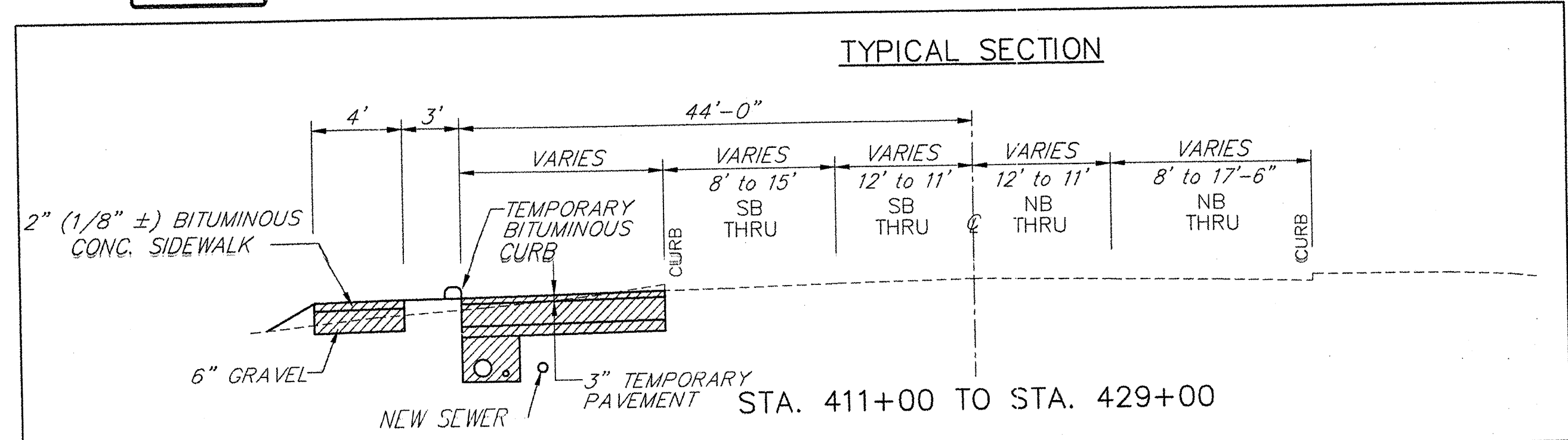
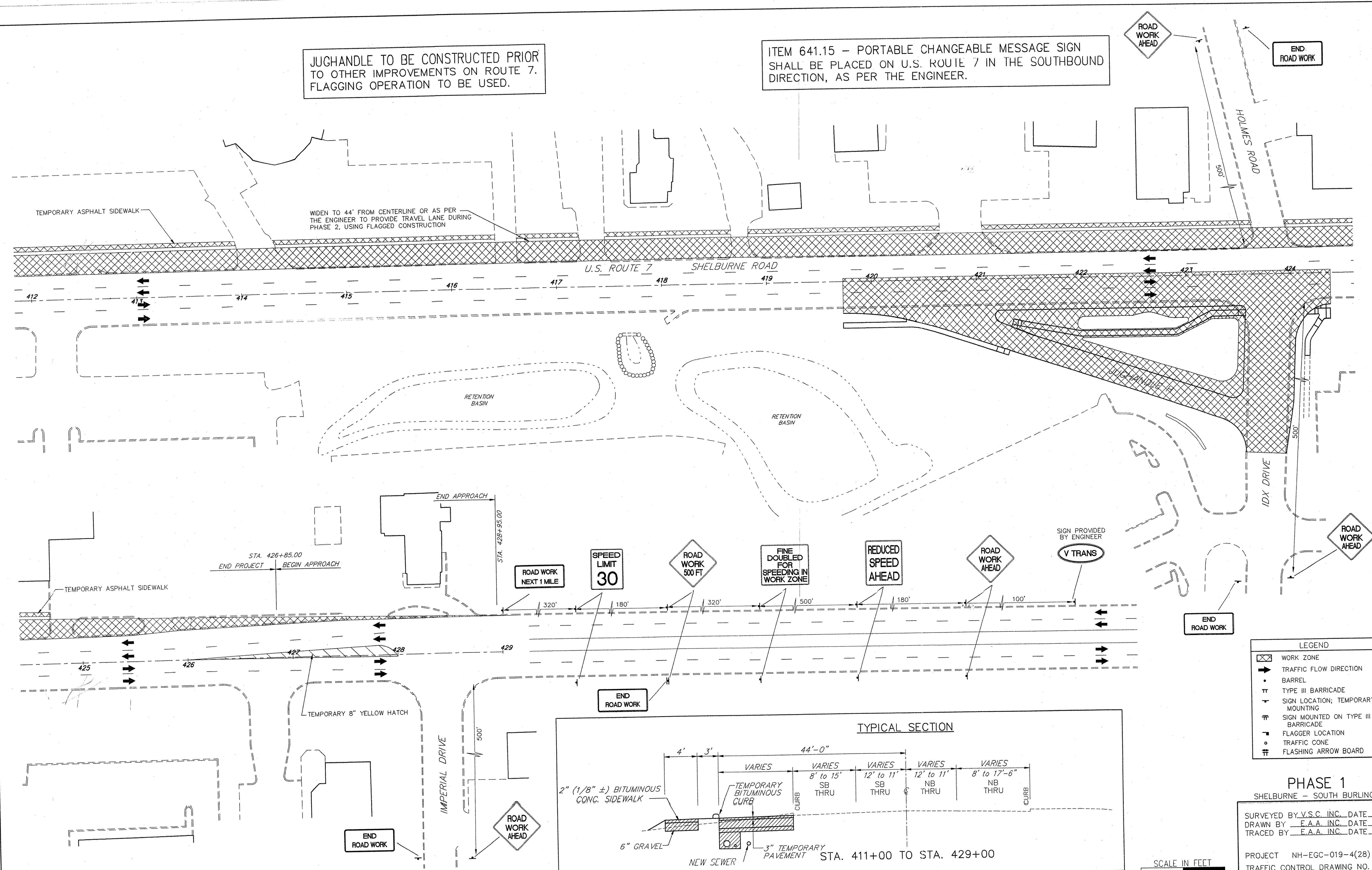

LEGEND	
	WORK ZONE
	TRAFFIC FLOW DIRECTION
	BARREL
	TYPE III BARRICADE
	SIGN LOCATION; TEMPORARY MOUNTING
	SIGN MOUNTED ON TYPE III BARRICADE
	FLAGGER LOCATION
	TRAFFIC CONE
	FLASHING ARROW BOARD

**PHASE 1**  
SHELburne - SOUTH BURLINGTON

SURVEYED BY V.S.C. INC. DATE \_\_\_\_\_  
 DRAWN BY E.A.A. INC. DATE \_\_\_\_\_  
 TRACED BY E.A.A. INC. DATE \_\_\_\_\_

PROJECT NH-EGC-019-4(28)  
 TRAFFIC CONTROL DRAWING NO. 5  
 SHEET NO. 151 OF 283

DATUM  
 VERTICAL NGVD 1929  
 HORIZONTAL NAD 1927

4/4/03

