

LIGHTING ITEMS

ITEM 678.21 - ELECTRICAL CONDUIT (2" PVC SCHEDULE 40)

399+00 LT - 400+05 LT (POLE NO. SB23), 111 LF
 399+00 RT - 399+20 RT (POLE NO. SB22), 26 LF

ITEM 678.23 - WIRED CONDUIT (2" PVC SCHEDULE 40)

399+20 RT (POLE NO. SB22) - 400+90 (POLE NO. SB24), 182 LF
 400+05 LT (POLE NO. SB23) - 401+75 LT (POLE NO. SB25), 182 LF
 400+90 RT (POLE NO. SB24) - 402+60 RT (POLE NO. SB26), 182 LF
 401+75 LT (POLE NO. SB25) - 403+45 LT (POLE NO. SB27), 182 LF
 402+60 RT (POLE NO. SB26) - 404+30 RT (POLE NO. SB28), 182 LF
 403+45 LT (POLE NO. SB27) - 405+00 LT, 164 LF
 404+30 RT (POLE NO. SB28) - 405+00 RT, 76 LF

ITEM 678.30 - ELECTRICAL CONDUIT SLEEVE

399+18 LT - 399+54 LT, 36 LF (6")
 402+62 LT - 402+98 LT, 36 LF (6")
 399+22 RT - 399+42 RT, 20 LF (8")

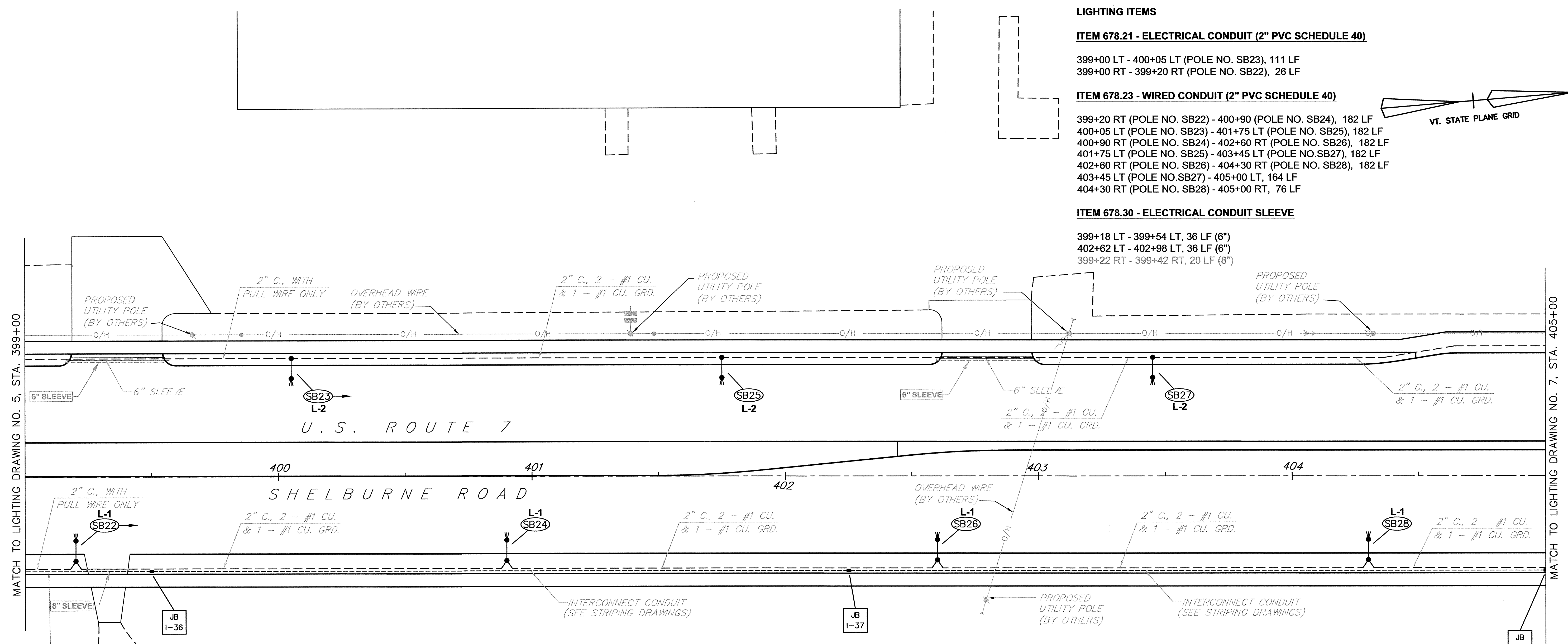

POLE NO.	STATION	OFFSET	SIDE	LENGTH OF POLE	ARM	WALL THICK	BRK-WAY	LUMINAIRE WATTS	TYPE	MOUNT HEIGHT	CONC. BASE	REMARKS
SB22	399+20	33'	RT.	33'	8'	.156	YES	150	III	35'	20"x72"	TRUSS-TYPE SUPPORT ARM
SB23	400+05	47'	LT.	33'	8'	.156	YES	150	III	35'	20"x72"	TRUSS-TYPE SUPPORT ARM
SB24	400+90	33'	RT.	33'	8'	.156	YES	150	III	35'	20"x72"	TRUSS-TYPE SUPPORT ARM
SB25	401+75	47'	LT.	33'	8'	.156	YES	150	III	35'	20"x72"	TRUSS-TYPE SUPPORT ARM
SB26	402+60	33'	RT.	33'	8'	.156	YES	150	III	35'	20"x72"	TRUSS-TYPE SUPPORT ARM
SB27	403+45	47'	LT.	33'	8'	.156	YES	150	III	35'	20"x72"	TRUSS-TYPE SUPPORT ARM
SB28	404+30	33'	RT.	33'	8'	.156	YES	150	III	35'	20"x72"	TRUSS-TYPE SUPPORT ARM

ABBREVIATIONS

C. = CONDUIT
 CU. = COPPER
 GRD. = GROUND

NOTE:
 SEE SIGNAL DRAWINGS NO'S. 1 THROUGH 6 FOR SIGNAL CONDUITS, PULLBOXES, WIRING, POLES AND SLEEVES.
 SEE TYPICAL SECTION DRAWING NO. 5 FOR TYPICAL CONDUIT PLACEMENT DETAIL.

LEGEND

	STREET LIGHT POLE	L-1 = ONE LEG OF THREE WIRE CIRCUIT
	UTILITY POLE	(SB1) = LIGHT POLE NUMBER (SOUTH BURLINGTON)
	LUMINAIRE	(V1) = LIGHT POLE NUMBER (VAOT)
	STRAIN POLE W/ MAST ARM	(C1) = LIGHT POLE NUMBER (CANTILEVER - VAOT)
	PEDESTRIAN POLE	(PB S-1) = SIGNAL PULLBOX NUMBER
	PULL BOX OR JUNCTION BOX	(JB I-1) = INTERCONNECT JUNCTION BOX NUMBER
	SIGNAL CONDUIT	(JB L-1) = LIGHTING JUNCTION BOX NUMBER
	INTERCONNECT CABLE CONDUIT	(PB P-1) = POWER SOURCE PULLBOX NUMBER
	LIGHTING CONDUIT	
	SLEEVE	
	POWER DROP STANCHION	

AS-BUILT LEGEND

WATER AS-BUILTS
 SEWER AS-BUILTS
 DRAINAGE AS-BUILTS
 ELECTRICAL AS-BUILTS
 PAVEMENT OTHER AS-BUILTS

INTERCONNECT ITEMS

ITEM 678.20 (MOD.) - INTERCONNECTING CABLE (2" PVC SCHEDULE 40)

399+00 RT - 399+50 RT (I-36), 50 LF
 399+50 RT (I-36) - 402+25 RT (I-37), 275 LF
 402+25 (I-37) - 405+00 RT (I-38), 275 LF

ITEM 678.26 - JUNCTION BOX

399+50, 37' RT. (I-36)
 402+25, 37' RT. (I-37)
 405+00, 37' RT. (I-38)

AS-BUILT REVISIONS

NO.	DATE	DESCRIPTION
1.	3/2/06	ADDED CONDUIT SLEEVES
2.	6/26/06	ADDED CONDUIT SLEEVE NOTES

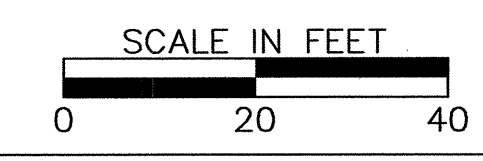

SHELburne - SOUTH BURLINGTON

SURVEYED BY V.S.C. INC. DATE _____
 DRAWN BY E.A.A. INC. DATE _____
 TRACED BY E.A.A. INC. DATE _____

PROJECT NH-EGC-019-4(28)
 LIGHTING DRAWING NO. 6
 SHEET NO. 142 OF 283

DATUM
 VERTICAL NGVD 1929
 HORIZONTAL NAD 1927

4/4/03