

POLE NO.	STATION	OFFSET	SIDE	LENGTH OF POLE	WALL THICK	BRK-WAY	LUMINAIRE WATTS	LUMINAIRE TYPE	MOUNT HEIGHT	CONC. BASE	REMARKS
SB10	387+45	33'	RT.	33'	8"	.156	YES	150	III	35'	80"20"x72" TRUSS-TYPE SUPPORT ARM
SB11	388+30	47'	LT.	33'	8"	.156	YES	150	III	35'	80"20"x72" TRUSS-TYPE SUPPORT ARM
SB12	389+15	33'	RT.	33'	8"	.156	YES	150	III	35'	80"20"x72" TRUSS-TYPE SUPPORT ARM
C6	390+00	58'	LT.	12'							MOUNT TRUSS-TYPE SUPPORT ARM ON CANTILEVER #6
V2	390+10	60'	RT.	33'	8"	.156	YES	150	III	35'	80"20"x72" TRUSS-TYPE SUPPORT ARM
C8	390+70	44'	RT.	12'							MOUNT TRUSS-TYPE SUPPORT ARM ON CANTILEVER #8
SB13	391+55	47'	LT.	33'	8"	.156	YES	150	III	35'	80"20"x72" TRUSS-TYPE SUPPORT ARM
SB14	392+40	33'	RT.	33'	8"	.156	YES	150	III	35'	80"20"x72" TRUSS-TYPE SUPPORT ARM

**LIGHTING ITEMS**

**ITEM 678.21 - ELECTRICAL CONDUIT (2" PVC SCHEDULE 40)**  
 387+00 RT - 387+45 RT (POLE NO. SB10), 51 LF

**ITEM 678.23 - WIRED CONDUIT (2" PVC SCHEDULE 40)**  
 387+00 LT - 388+30 LT (POLE NO. SB11), 136 LF  
 387+45 RT (POLE NO. SB10) - 389+15 RT (POLE NO. 12), 182 LF  
 388+30 LT (POLE NO. 11) - 390+55 LT (L-35), 225 LF  
 389+15 RT (POLE NO. SB12) - 389+82 RT (L-33), 73 LF  
 390+61 RT (L-34) - 392+40 RT (POLE NO. SB14), 179 LF  
 390+55 LT (L-35) - 391+55 LT (POLE NO. SB13), 100 LF  
 391+55 LT (POLE NO. SB13) - 393+00 LT, 151 LF  
 392+40 RT (POLE NO. SB14) - 393+00 RT, 66 LF

**INTERCONNECT ITEMS**

**ITEM 678.20 (MOD.) - INTERCONNECTING CABLE (2" PVC SCHEDULE 40)**  
 387+00 RT - 387+63 RT (I-31), 63 LF  
 387+63 RT (I-31) - 389+70 RT (I-32), 207 LF  
 391+43 RT (I-33) - 393+00 RT, 157 LF

**ITEM 678.26 - JUNCTION BOX**  
 387+63, 37' RT. (I-31)  
 389+70, 37' RT. (I-32)  
 391+43, 37' RT. (I-33)

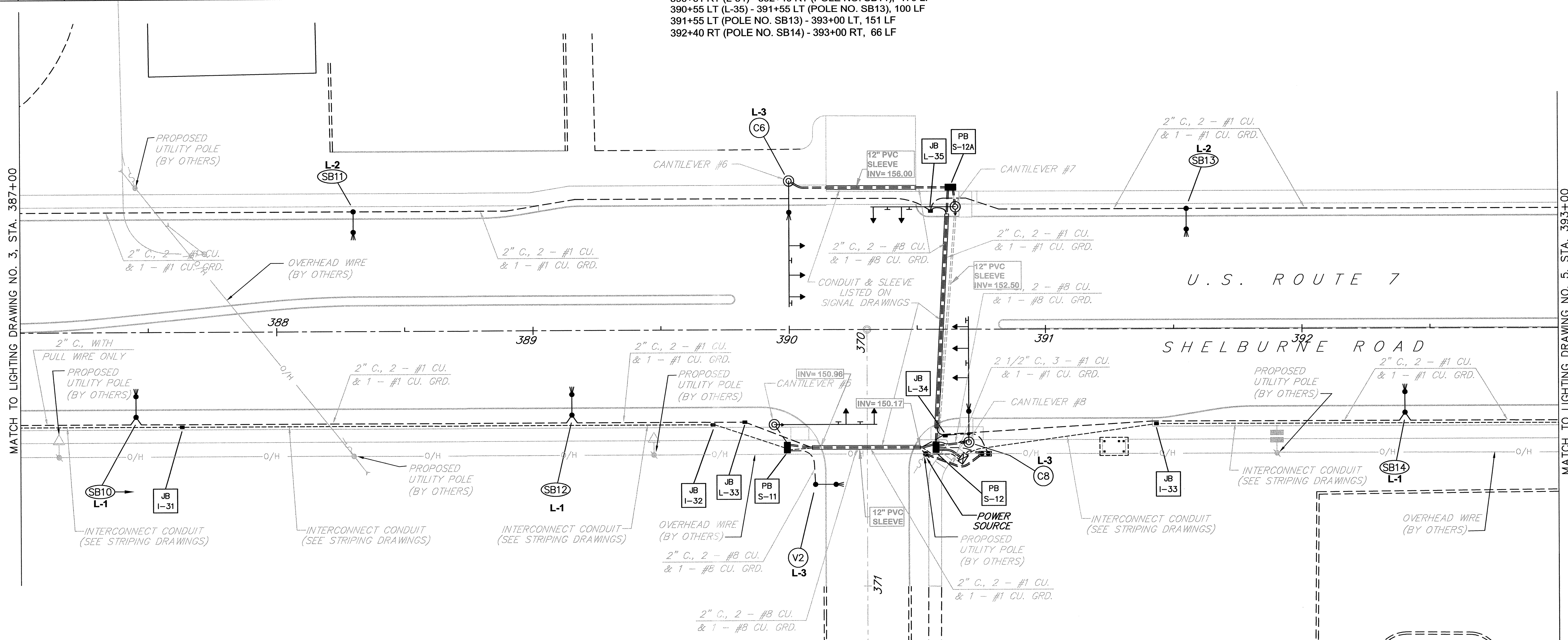
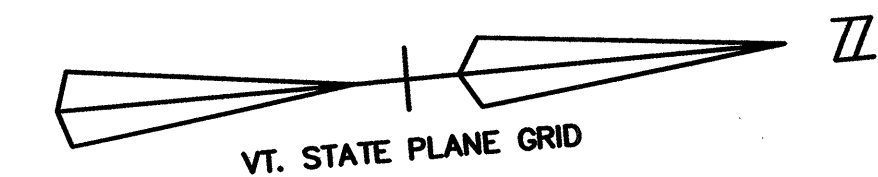

MATCH TO LIGHTING DRAWING NO. 3, STA. 387+00

MATCH TO LIGHTING DRAWING NO. 5, STA. 393+00

LEGEND	
	STREET LIGHT POLE
	UTILITY POLE
	LUMINAIRE
	STRAIN POLE W/ MAST ARM
	PEDESTRIAN POLE
	PULL BOX OR JUNCTION BOX
	SIGNAL CONDUIT
	INTERCONNECT CABLE CONDUIT
	LIGHTING CONDUIT
	SLEEVE
	POWER DROP STANCHION
	L-1 = ONE LEG OF THREE WIRE CIRCUIT
	SB1 = LIGHT POLE NUMBER (SOUTH BURLINGTON)
	V1 = LIGHT POLE NUMBER (VAOT)
	C1 = LIGHT POLE NUMBER (CANTILEVER - VAOT)
	PB S-1 = SIGNAL PULLBOX NUMBER
	JB I-1 = INTERCONNECT JUNCTION BOX NUMBER
	JB L-1 = LIGHTING JUNCTION BOX NUMBER
	PB P-1 = POWER SOURCE PULLBOX NUMBER

ABBREVIATIONS	
C.	= CONDUIT
CU.	= COPPER
GRD.	= GROUND

AS-BUILT LEGEND	
	WATER AS-BUILTS
	SEWER AS-BUILTS
	DRAINAGE AS-BUILTS
	ELECTRICAL AS-BUILTS
	PAVEMENT/OTHER AS-BUILTS

AS-BUILT REVISIONS		
NO.	DATE	DESCRIPTION
1.	3/6/06	ADDED LIGHTING CONDUITS
2.	6/26/06	ADDED LIGHTING SLEEVE NOTES

**NOTE:**  
 STREET LIGHTS #C6 AND #C8 SHALL BE MOUNTED ON CANTILEVER POLES AND SHALL RECEIVE THEIR POWER FROM THE SAME METERED POWER SOURCE AS THE TRAFFIC SIGNAL.  
 STREET LIGHT #V2 SHALL BE AN INDEPENDENT LIGHT POLE AND SHALL RECEIVE POWER FROM THE SAME METERED POWER SOURCE AS THE TRAFFIC SIGNAL.  
 SEE SIGNAL DRAWINGS NO'S 1 THROUGH 6 FOR SIGNAL CONDUITS, PULLBOXES, WIRING, POLES AND SLEEVES.  
 SEE TYPICAL SECTION DRAWING NO. 5 FOR TYPICAL CONDUIT PLACEMENT DETAIL.

DATUM  
 VERTICAL NGVD 1929  
 HORIZONTAL NAD 1927

4/4/03

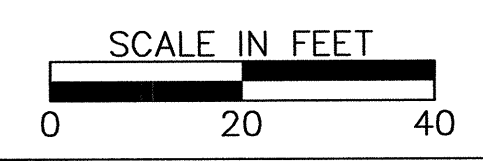

SHELburne - SOUTH BURLINGTON

SURVEYED BY V.S.C. INC. DATE \_\_\_\_\_  
 DRAWN BY E.A.A. INC. DATE \_\_\_\_\_  
 TRACED BY E.A.A. INC. DATE \_\_\_\_\_

REVISED LIGHTING DESIGN  
 PROJECT NH-EGC-019-4(28)  
 LIGHTING DRAWING NO. 4  
 SHEET NO. 140R OF 283