

LIGHTING ITEMS

ITEM 678.21 - ELECTRICAL CONDUIT (2" PVC SCHEDULE 40)

383+16 RT (S-9) - 384+27 RT (S-10), 117 LF
 384+79 LT (POLE NO. SB7) - 386+60 LT (POLE NO. SB9), 193 LF
 385+69 RT (POLE NO. SB8) - 387+00 RT, 137 LF

ITEM 678.23 - WIRED CONDUIT (2" PVC SCHEDULE 40)

381+00 LT - 381+61 LT (POLE NO. SB5), 67 LF
 381+00 RT - 382+46 RT (POLE NO. SB6), 152 LF
 381+61 LT (POLE NO. SB5) - 383+31 LT (CANTILEVER #1), 232 LF
 382+46 RT (POLE NO. SB6) - 383+16 (S-9), 79 LF
 383+93 RT (POLE NO. V1) - 384+27 (CANTILEVER #4), 40 LF
 384+27 RT (S-10) - 384+32 RT (STANCHION), 16 LF
 384+27 RT (S-10) - 385+69 (POLE NO. SB8), 151 LF
 384+22 LT (PED POLE) - 384+79 LT (POLE NO. SB7), 69 LF
 386+60 LT (POLE NO. SB9) - 387+00 LT, 46 LF

ITEM 678.23 - WIRED CONDUIT (2 1/2" PVC SCHEDULE 40)

384+32 RT (STANCHION) - 384+42 RT (POWER), 16 LF

ITEM 678.23 - WIRED CONDUIT (2" PVC SCHEDULE 80)

AT POWER DROP, ABOVE GROUND, 10 LF

POLE NO.	STATION	OFFSET	SIDE	LENGTH OF POLE	WALL THICK	BRK WAY	LUMINAIRE WATTS	LUMINAIRE TYPE	MOUNT HEIGHT	CONC. BASE	REMARKS	
SB5	381+61	47'	LT.	33'	8"	.156	YES	150	III	35'	20"x72"	TRUSS-TYPE SUPPORT ARM
SB6	382+46	33'	RT.	33'	8"	.156	YES	150	III	35'	20"x72"	TRUSS-TYPE SUPPORT ARM
C3	383+80	48'	LT.	8'								MOUNT TRUSS-TYPE SUPPORT ARM ON CANTILEVER #3
V1	383+93	55'	RT.	33'	8"	.156	YES	150	III	35'	20"x72"	TRUSS-TYPE SUPPORT ARM
C4	384+27	44'	RT.	12'								MOUNT TRUSS-TYPE SUPPORT ARM ON CANTILEVER #4
SB7	384+79	47'	LT.	33'	8"	.156	YES	150	III	35'	20"x72"	TRUSS-TYPE SUPPORT ARM
SB8	385+69	33'	RT.	33'	8"	.156	YES	150	III	35'	20"x72"	TRUSS-TYPE SUPPORT ARM
SB9	386+60	47'	LT.	33'	8"	.156	YES	150	III	35'	20"x72"	TRUSS-TYPE SUPPORT ARM

ITEM 678.30 - ELECTRICAL CONDUIT SLEEVE

381+00 LT - 381+25 LT, 25 LF (6")
 381+22 RT - 381+66 RT, 44 LF (8")
 382+57 RT - 382+84 RT, 27 LF (8")
 383+26 RT - 384+08 RT, 81 LF (12")
 384+89 LT - 385+52 LT, 63 LF (6")

INTERCONNECT ITEMS

ITEM 678.20 (MOD.) - INTERCONNECTING CABLE (2" PVC SCHEDULE 40)

381+00 RT - 381+15 RT (I-29), 15 LF
 381+15 RT (I-29) - 383+16 RT (S-9), 201 LF
 383+16 (S-9) - 384+27 RT (S-10), 117 LF
 384+27 RT (S-10) - 384+27 RT (CANTILEVER #4), 9 LF
 384+18 RT (CONTROLLER) - 384+27 RT (CANTILEVER #4), 13 LF
 384+18 (CONTROLLER) - 384+88 RT (I-30), 74 LF
 384+88 RT (I-30) - 387+00 RT, 212 LF

ITEM 678.26 - JUNCTION BOX

381+15, 34' RT. (I-29)
 384+88, 37' RT. (I-30)

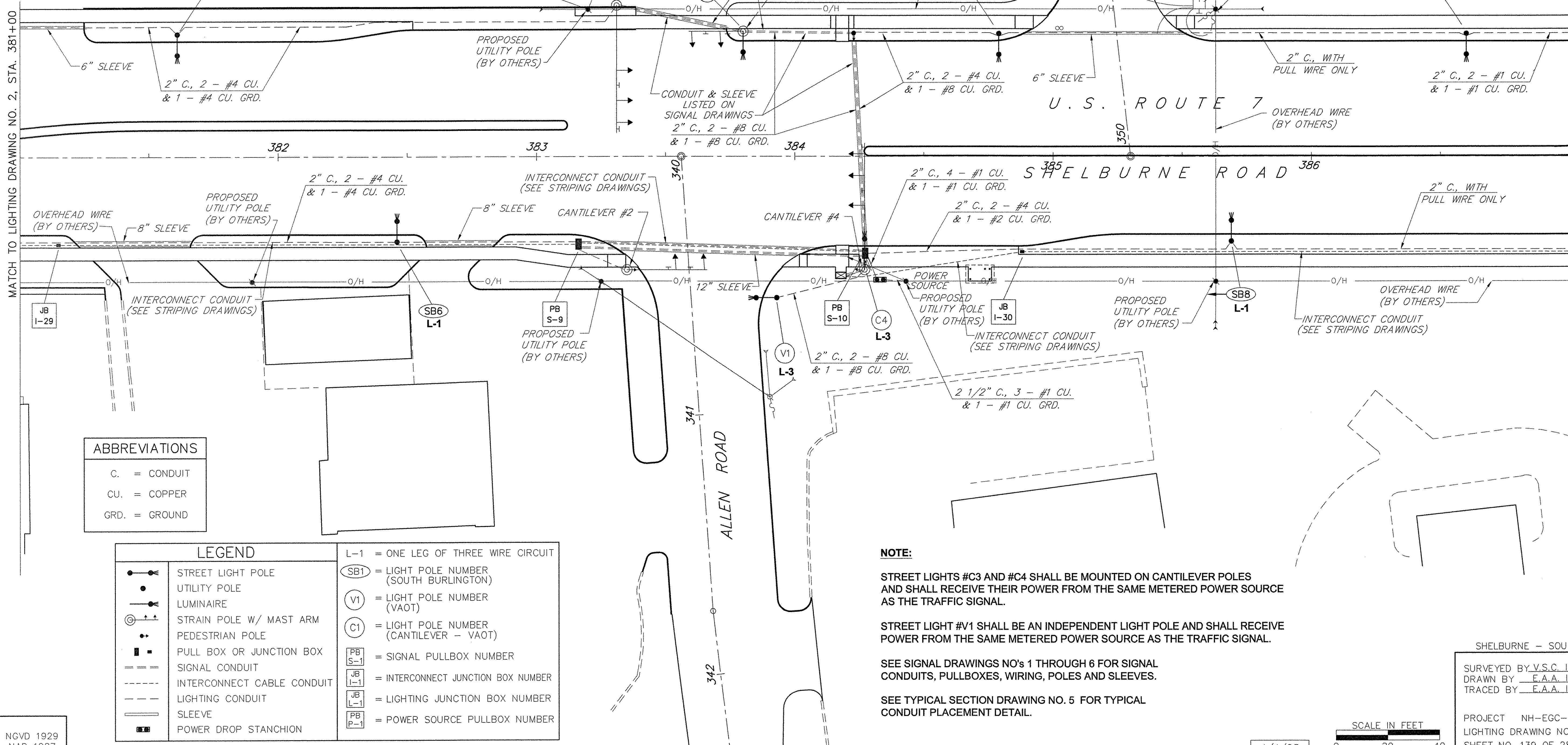
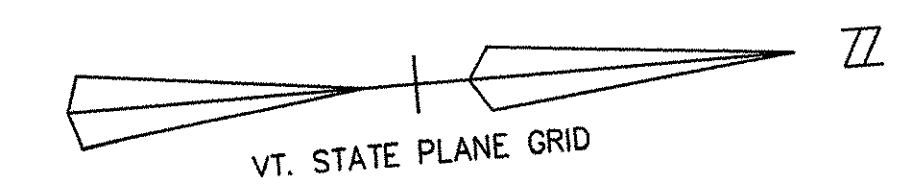

ABBREVIATIONS

C.	=	CONDUIT
CU.	=	COPPER
GRD.	=	GROUND

LEGEND

	STREET LIGHT POLE	L-1 = ONE LEG OF THREE WIRE CIRCUIT
	UTILITY POLE	(SB1) = LIGHT POLE NUMBER (SOUTH BURLINGTON)
	LUMINAIRE	(V1) = LIGHT POLE NUMBER (VAOT)
	STRAIN POLE W/ MAST ARM	(C1) = LIGHT POLE NUMBER (CANTILEVER - VAOT)
	PEDESTRIAN POLE	(PB S-1) = SIGNAL PULLBOX NUMBER
	PULL BOX OR JUNCTION BOX	(JB I-1) = INTERCONNECT JUNCTION BOX NUMBER
	SIGNAL CONDUIT	(JB L-1) = LIGHTING JUNCTION BOX NUMBER
	INTERCONNECT CABLE CONDUIT	(PB P-1) = POWER SOURCE PULLBOX NUMBER
	LIGHTING CONDUIT	
	SLEEVE	
	POWER DROP STANCHION	

NOTE:

STREET LIGHTS #C3 AND #C4 SHALL BE MOUNTED ON CANTILEVER POLES AND SHALL RECEIVE THEIR POWER FROM THE SAME METERED POWER SOURCE AS THE TRAFFIC SIGNAL.

STREET LIGHT #V1 SHALL BE AN INDEPENDENT LIGHT POLE AND SHALL RECEIVE POWER FROM THE SAME METERED POWER SOURCE AS THE TRAFFIC SIGNAL.

SEE SIGNAL DRAWINGS NO'S 1 THROUGH 6 FOR SIGNAL CONDUITS, PULLBOXES, WIRING, POLES AND SLEEVES.

SEE TYPICAL SECTION DRAWING NO. 5 FOR TYPICAL CONDUIT PLACEMENT DETAIL.

DATUM
 VERTICAL NGVD 1929
 HORIZONTAL NAD 1927

4/4/03
 SCALE IN FEET
 0 20 40

SHELburne - SOUTH BURLINGTON

SURVEYED BY V.S.C. INC. DATE _____
 DRAWN BY E.A.A. INC. DATE _____
 TRACED BY E.A.A. INC. DATE _____

PROJECT NH-EGC-019-4(28)
 LIGHTING DRAWING NO. 3
 SHEET NO. 139 OF 283