

ELEV. 1
SAFETY CURB

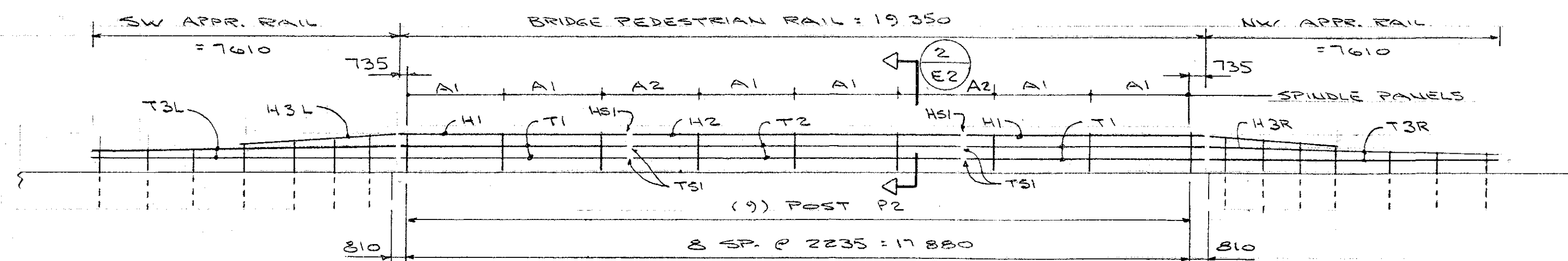

ELEV. 2
SIDEWALK

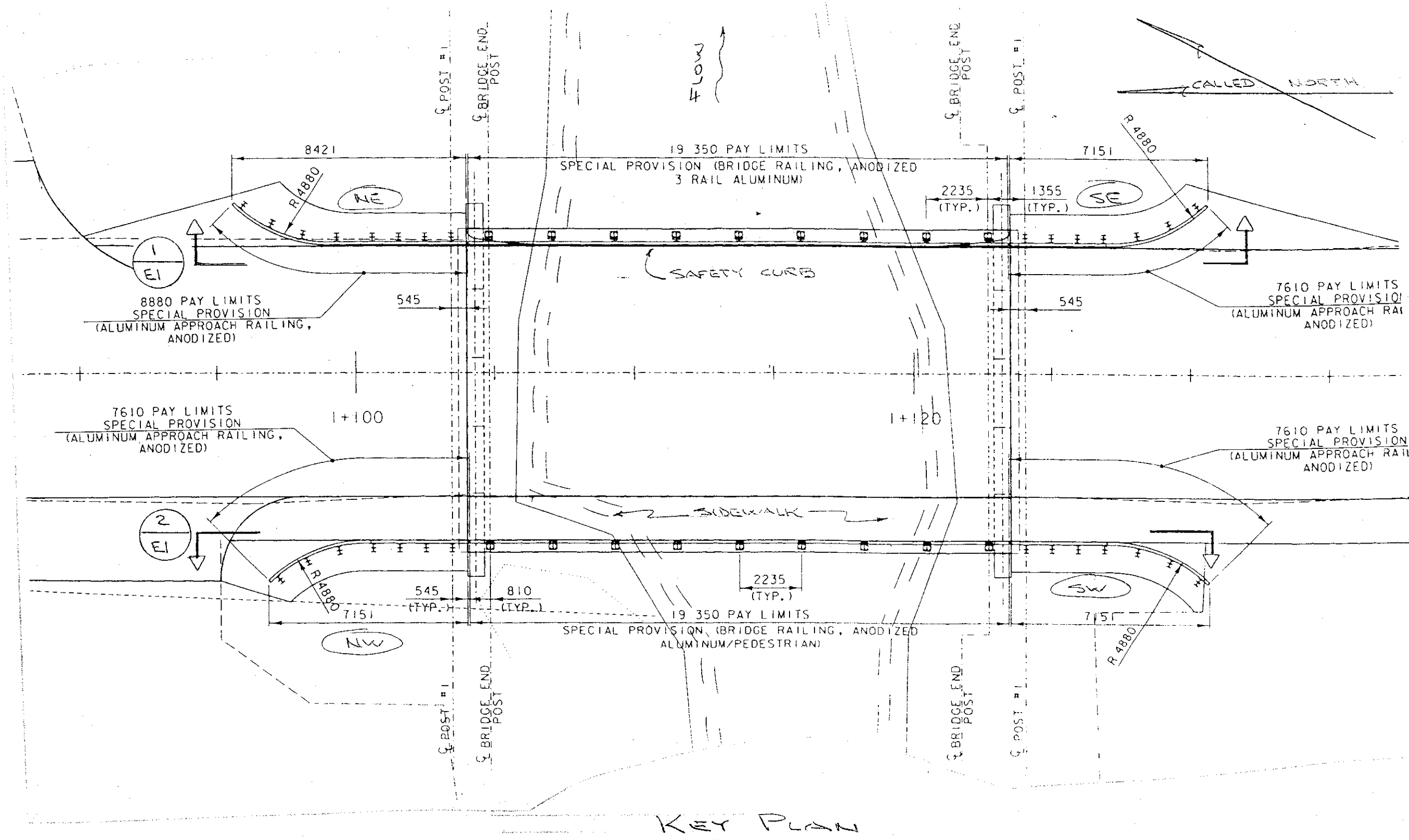

KEY PLAN

JOB # AB07010

QUAN	MK	DESCRIPTION	QUAN	MK	DESCRIPTION	HANDRAIL		
1	A11L	STANDOFF	1	11L	APPROACH POST	QUAN	MK	LGTH
1	A12L		1	12L		4	H1	6120
1	A13L		1	13L		2	H2	7070
1	A14L		1	14L		2	H3R	3572
1	A15L		1	15L		2	H3L	3580
1	A16L		1	16L		TRAFFIC RAIL		
1	A17L		1	17L		QUAN	MK	LGTH
1	A11R		1	11R		8	T1	6120
1	A12R		1	12R		4	T2	7070
1	A13R		1	13R		4	T3R	7604
1	A14R		1	14R		2	T3L	7604
1	A15R		1	15R		2	T4	7610
1	A16R		1	16R		2	T5	1244
1	A17R		1	17R				
1	A18R		1	18R				
1	A21L		1	A21L		18		ANCHOR BOLT ASSY
1	A22L		1	22L		90		M20 X 2.5 GALV HEX NUT
1	A23L		1	23L		90		M20 GALV. FLAT WASHER
1	A24L		1	24L		68		#4 CLAMP BAR
1	A25L		1	25L		188		#1 CLAMP BAR
1	A26L		1	26L		216		M13 X 2 X 20 S.S. HEX HD CAP SCREW
1	A27L		1	27L		376		M13 X 2 X 25 S.S. HEX HD CAP SCREW
1	A21R		1	21R		256		M13 X 2 X 38 S.S. HEX HD CAP SCREW
1	A22R		1	22R		256		M13 X 2 S.S. HEX NUT
1	A23R		1	23R		208		M13 S.S. FLAT WASHER
1	A24R		1	24R		348		M13 ALUM. FLAT WASHER
1	A25R		1	25R		208		"L" BOLT
1	A26R		1	26R		18		POST PAD
1	A27R		1	27R		80		M 6 X 1 X 19 S.S. SET SCREW
9	P10B		9	P1	BRIDGE POST			
8	TS1	TRAFFIC RAIL SPLICE	9	P2	BRIDGE POST			
2	TS2							
2	TS3		6	A1	SPLIDLE PANEL			
1	TS4		2	A2	SPLIDLE PANEL			
2	TS5							
2	TS6							
1	TS7							
4	HS1	HANDRAIL SPLICE						
2	HS2							
2	HS3							

Revised 10-21-01 CFS

DR. DATE: 9/24/09 FOR APPROVAL BY: [Signature]

DR. DATE: 9/4/09 FOR APPROVAL BY: [Signature]

ISSUE DATE DESCRIPTION BY

2 9/24/09 FOR APPROVAL B

1 9/4/09 FOR APPROVAL B

DR. DATE: 9-3-09 DWG. NO. BR-2965

CHK. DATE: 9-4-09

JOB NO. AB07010-1001 SHEET E1 OF 4

ALUM. BRIDGE & APPROACH RAILING

SURFACE PREP: NONE FINISH: BLACK ANODIZE

FOR: F.R. LAFAYETTE, INC.

VT. AGENCY OF TRANSPORTATION #BHF 030-2 (18)S BRIDGE #67

VT. 15' OVER COOPER BROOK

560 MAIN ST. HUDSON, MA (978) 568-8382