

CURVE DATA NO. D1	
Δ = 34° 19' 28.7"	
D = 163° 42' 08.0"	
R = 35.000	
T = 10.809	
L = 20.968	
E = 1.631	
2T-L = 0.650	

CURVE DATA NO. D2	
Δ = 34° 19' 28.7"	
D = 143° 14' 22.0"	
R = 40.000	
T = 12.353	
L = 23.963	
E = 1.864	
2T-L = 0.743	

CURVE DATA NO. D3	
Δ = 28° 32' 51.3"	
D = 143° 14' 22.0"	
R = 40.000	
T = 10.176	
L = 19.930	
E = 1.274	
2T-L = 0.422	

CURVE DATA NO. D4	
Δ = 28° 32' 51.3"	
D = 143° 14' 22.0"	
R = 40.000	
T = 10.176	
L = 19.930	
E = 1.274	
2T-L = 0.422	

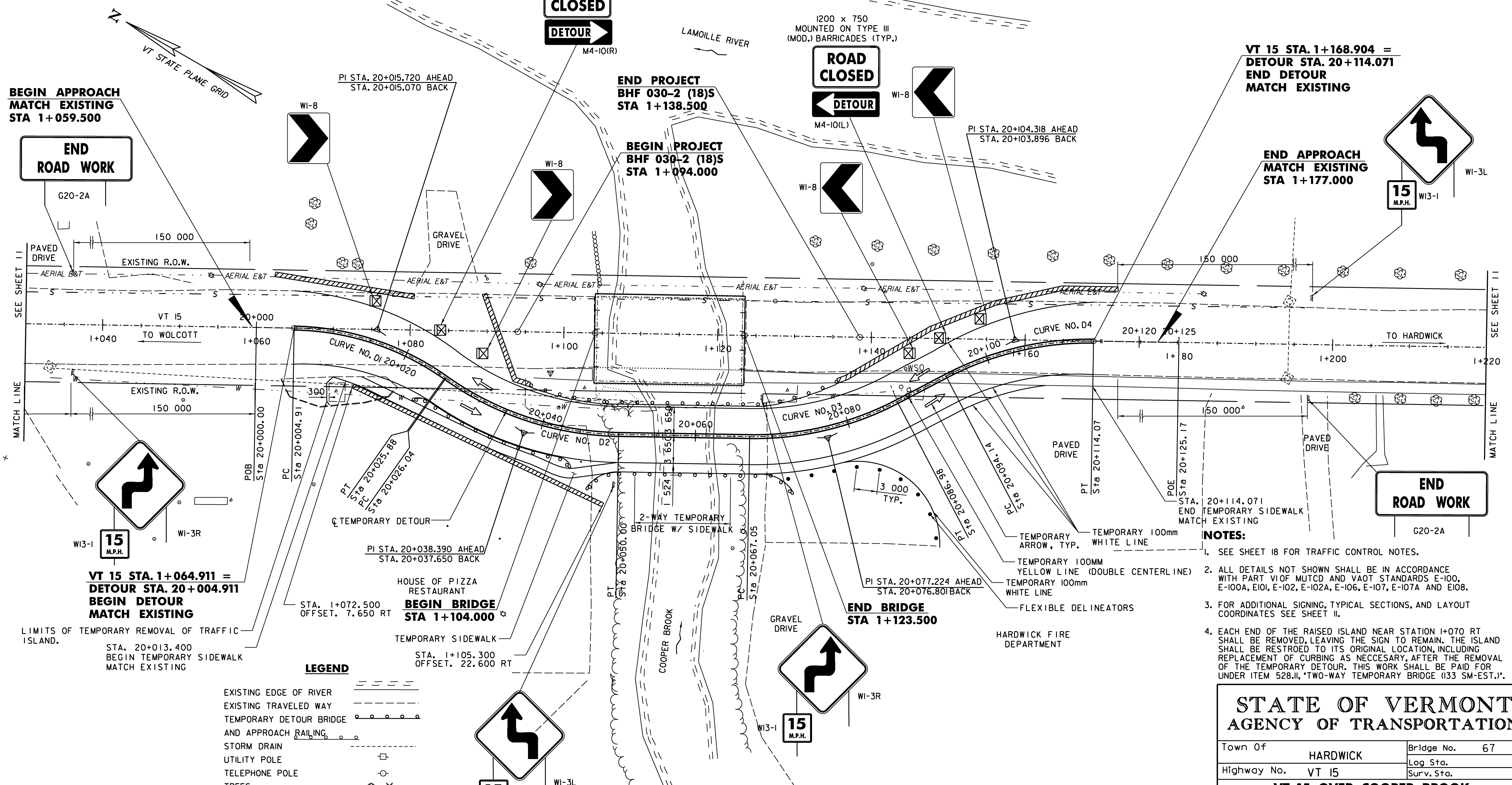

BEGIN APPROACH
MATCH EXISTING
STA 1+059.500

END
ROAD WORK

END PROJECT
BHF 030-2 (18)S
STA 1+138.500

BEGIN PROJECT
BHF 030-2 (18)S
STA 1+094.000

VT 15 STA. 1+168.904 =
DETOUR STA. 20+114.071
END DETOUR
MATCH EXISTING

END APPROACH
MATCH EXISTING
STA 1+177.000

END
ROAD WORK

- NOTES:**
- SEE SHEET 18 FOR TRAFFIC CONTROL NOTES.
 - ALL DETAILS NOT SHOWN SHALL BE IN ACCORDANCE WITH PART VI OF MUTCD AND VAOT STANDARDS E-100, E-100A, E101, E-102, E-102A, E-106, E-107, E-107A AND E108.
 - FOR ADDITIONAL SIGNING, TYPICAL SECTIONS, AND LAYOUT COORDINATES SEE SHEET 11.
 - EACH END OF THE RAISED ISLAND NEAR STATION 1+070 RT SHALL BE REMOVED, LEAVING THE SIGN TO REMAIN. THE ISLAND SHALL BE RESTORED TO ITS ORIGINAL LOCATION, INCLUDING REPLACEMENT OF CURBING AS NECESSARY, AFTER THE REMOVAL OF THE TEMPORARY DETOUR. THIS WORK SHALL BE PAID FOR UNDER ITEM 528.11, 'TWO-WAY TEMPORARY BRIDGE (133 SM-EST.)'.

LEGEND

- EXISTING EDGE OF RIVER
- EXISTING TRAVELED WAY
- TEMPORARY DETOUR BRIDGE AND APPROACH RAILING
- STORM DRAIN
- UTILITY POLE
- TELEPHONE POLE
- TREES
- TREE LINE
- OVERHEAD LINES
- WATER LINE
- EXISTING SIGN
- SEWER LINE
- TEMPORARY BARRIER
- TYPE III BARRICADES (MOD.)
- FLEXIBLE DELINEATOR

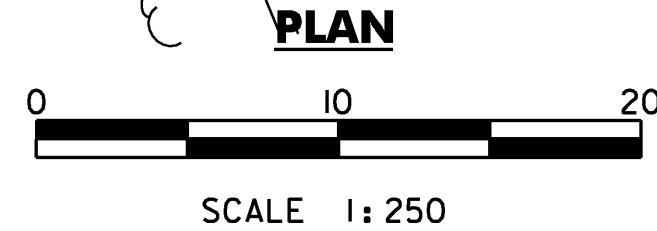

DATUM

VERTICAL	NAVD 88
HORIZONTAL	NAD 83/92

DuBois & King
INC.
engineering planning management development

STATE OF VERMONT AGENCY OF TRANSPORTATION	
Town Of	HARDWICK
Highway No.	VT 15
VT 15 OVER COOPER BROOK TRAFFIC CONTROL SHEET 1	
Designed By	A.P. GUYETTE
Checked By	E. P. DETRICK
Date	11/08
Drawn By	S.J. BIJOLLE
Bridge Design Supervisor	J.W. TUCKER
Date	11/08
PROJECT	HARDWICK
PROJECT NO.	BHF 030-2 (18) S
I.G.C. Info. DGN#SPEC#	
Bridge Sheet No.	Sheet 10 of 38