

VT. ROUTE 67A
MM 2.134 = STA. 3+434.340
BEGIN PROJECT STP 9646(I)S

VT. ROUTE 67A
MM 3.317 = STA. 5+338.194
END PROJECT STP 9646(I)S

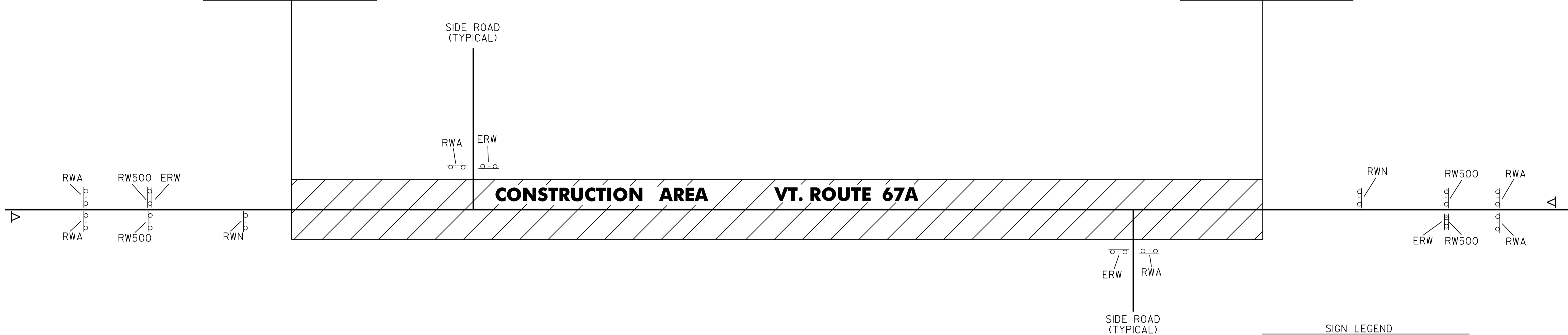

SIGN LEGEND

RWA	= ROAD WORK AHEAD
RW500	= ROAD WORK 500 FEET
ERW	= END ROAD WORK
RWN	= ROAD WORK NEXT 1 1/4 MILES
△	= VARIABLE MESSAGE BOARD

VERMONT ROUTE 67A			
LIST OF TOWN HIGHWAYS FOR CONSTRUCTION SIGNS			
TOWN HIGHWAY NUMBER	ROAD WORK AHEAD	END ROAD WORK	OTHER
BEGIN PROJECT	2	1	2-RW500 1-RWN 1-VAR. MESSAGE BOARD
RIVER ROAD	1	1	
HILLSIDE STREET	1	1	
SWIFT ROAD	1	1	
LEVER ROAD	1	1	
WEST ROAD	1	1	
PROSPECT STREET	1	1	
SAGE STREET	1	1	
END PROJECT	2	1	2-RW500 1-RWN 1-VAR. MESSAGE BOARD
TOTAL	11	9	

CONSTRUCTION APPROACH SIGNING

NOTES:

- SEE VAOT STD. E-100 FOR ADDITIONAL SIGN PLACEMENT.
- CONSTRUCTION ZONE SIGN LAYOUT SHALL BE IN ACCORDANCE WITH SECTION 6 OF THE LATEST EDITION OF THE MANUAL ON UNIFORM TRAFFIC CONTROL DEVICES (MUTCD).
- CONSTRUCTION SIGNS SHALL BE IN NEW OR LIKE NEW CONDITION PER VAOT STANDARDS.
- DIAMOND SHAPED SIGNS SHALL BE 4' X 4' WITH BLACK LEGEND ON FLUORESCENT ORANGE BACKGROUND.
- CONSTRUCTION ZONE SIGNS SHALL BE INSTALLED ON TWO POSTS EACH OR AS AN NCHRP 350 COMPLIANT SIGN/STAND SYSTEM.
- VARIABLE MESSAGE BOARDS SHALL BE PLACED AS DIRECTED BY THE RESIDENT ENGINEER.

NOTE:

THE RESIDENT ENGINEER AT HIS OR HER DISCRETION SHALL ELIMINATE CONSTRUCTION APPROACH SIGNS FOR DEAD END/NO OUTLET TOWN HIGHWAYS OR TOWN HIGHWAYS THAT CONNECT ON BOTH SIDES OF THE PROJECT.

DATUM	
VERTICAL	N/A
HORIZONTAL	NAD83 (1996)

CONSTRUCTION APPROACH SIGNING DETAIL SHEET	SURVEYED BY <u>L.R.S.C.</u> DATE <u>4/03</u>
	DRAWN BY <u>C.A.K.</u> DATE <u>3/06</u>
	SQUAD LEADER <u>D.E.G.</u>
	DESIGN FILE NO. <u>/pave/95dl04/pdl04.dgn</u>
	IPARM FILE <u>pdl04cas.i</u> DATE <u>20-AUG-2010 12:</u>
	PROJ. NAME <u>NORTH BENNINGTON</u>
	PROJ. NO. <u>STP 9646(I)S</u>
	SHEET <u>115</u> OF <u>151</u> SHEETS