

646.40 DURABLE 100 mm WHITE LINE (THERMOPLASTIC)  
(ALL LINES WILL INCLUDE EDGE LINE BREAKS AND RADIUS FOR TOWN HIGHWAYS)  
VT. ROUTE 67A:  
STA. 4+840.0 - STA. 4+990.0 LT & RT

646.4I DURABLE 100 mm YELLOW LINE (THERMOPLASTIC)  
(ALL LINES WILL INCLUDE C/L BREAKS FOR TOWN HIGHWAYS) S=SOLID, D=DASHED  
VT. ROUTE 67A:  
STA. 4+840.0 - STA. 4+990.0 LT CL RT  
S - S

646.60 TEMPORARY 100 mm WHITE LINE (PAINT)  
(ALL LINES WILL INCLUDE EDGE LINE BREAKS AND RADIUS FOR TOWN HIGHWAYS)  
VT. ROUTE 67A:  
STA. 4+840.0 - STA. 4+990.0 LT & RT

646.6I TEMPORARY 100 mm YELLOW LINE (PAINT)  
(ALL LINES WILL INCLUDE C/L BREAKS FOR TOWN HIGHWAYS) S=SOLID, D=DASHED  
VT. ROUTE 67A:  
STA. 4+840.0 - STA. 4+990.0 LT CL RT  
S - S

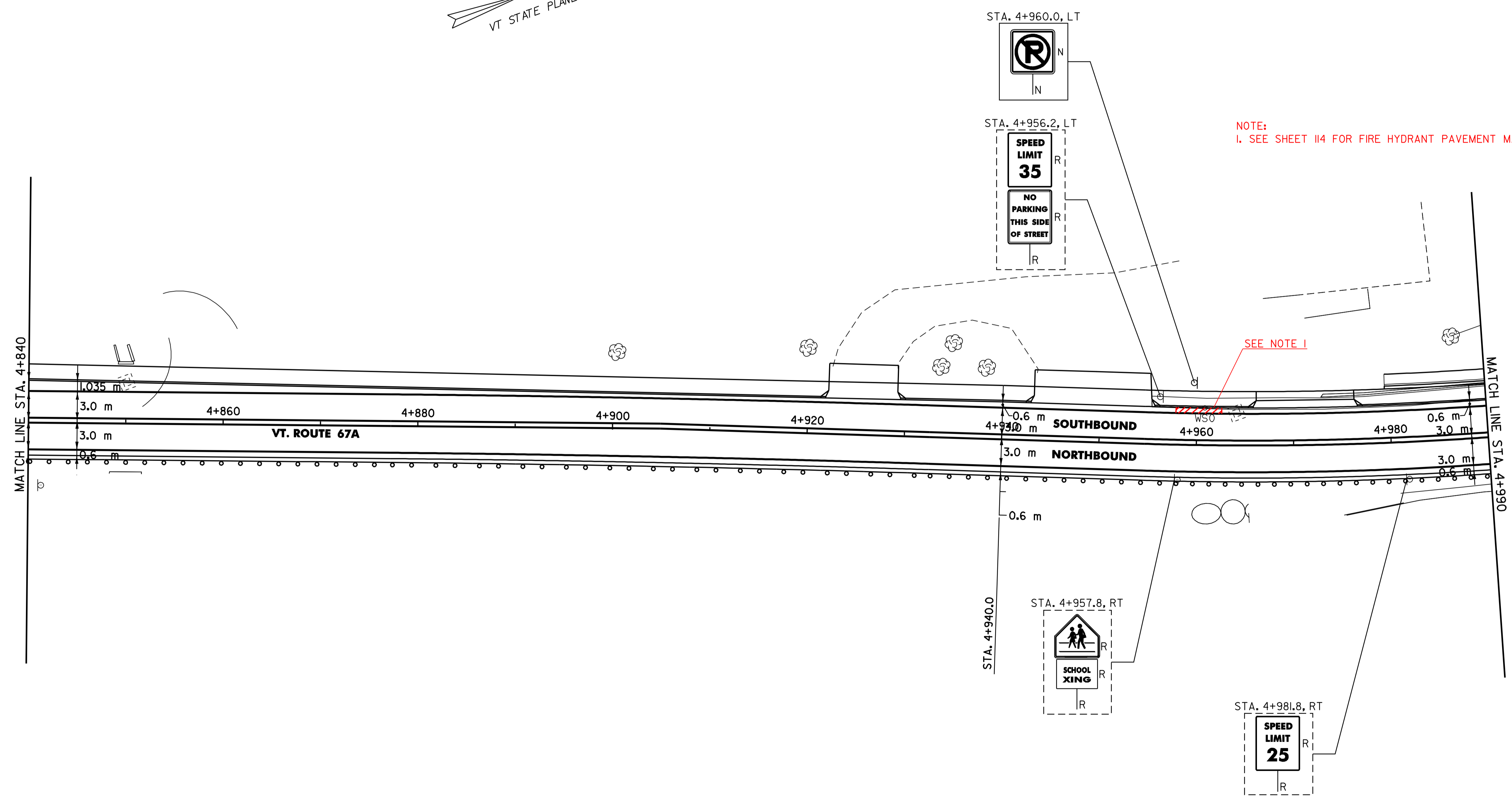
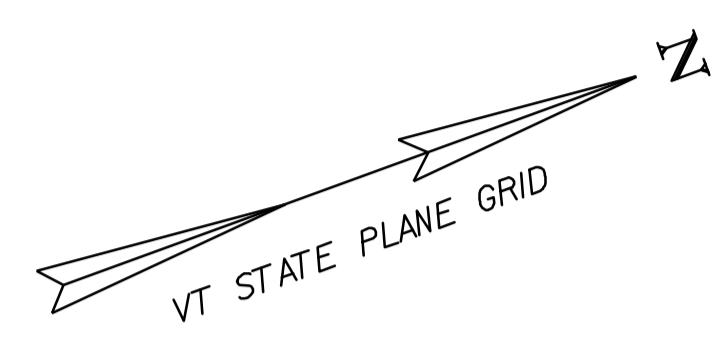

NOTE:  
1. SEE SHEET I14 FOR FIRE HYDRANT PAVEMENT MARKING DETAIL.

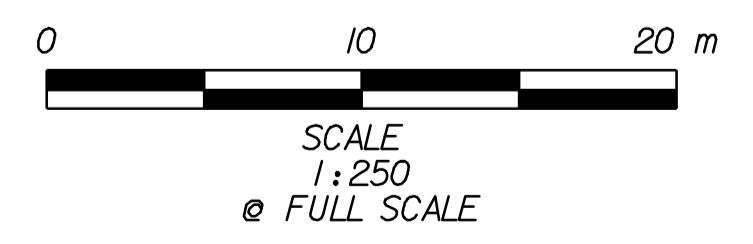

SIGN LEGEND  
R= REMOVE  
S= SALVAGE  
N= NEW  
RET= RETAIN  
B-B= BACK TO BACK  
EXISTING= - - - - -  
NEW= \_\_\_\_\_

<h2>SIGNING &amp; STRIPING PLAN SHEET #10</h2>	SURVEYED BY <u>L.R.S.C.</u> DATE <u>4/03</u>
	DRAWN BY <u>C.A.K.</u> DATE <u>3/06</u>
	SQUAD LEADER <u>D.E.G.</u>
	DESIGN FILE NO. <u>/pave/95d104/pd104.dgn</u>
	IPARM FILE <u>pd104sspsi0.1</u> DATE <u>20-AUG-2010 12:30</u>
PROJ. NAME <u>NORTH BENNINGTON</u>	
PROJ. NO. <u>STP 9646(I)S</u>	
SHEET <u>106</u> OF <u>151</u> SHEETS	

DATUM  
VERTICAL N/A  
HORIZONTAL NAD83 (1996)