

**620.70 SNOW FENCE (MOD. - PDF)**

- STA. 4+840 - STA. 4+923 LT (83 m)
- STA. 4+840 - STA. 4+990 RT (152 m)
- STA. 4+930 - STA. 4+943 LT (13 m)
- STA. 4+955 - STA. 4+990 LT (35 m)

**649.51 GEOTEXTILE FOR SILT FENCE**

- STA. 4+840 - STA. 4+921LT (81 m)
- STA. 4+840 - STA. 4+970 RT (152 m)
- STA. 4+930 - STA. 4+943 LT (13 m)
- STA. 4+955 - STA. 4+990 LT (35 m)

**613.10 STONE FILL, TYPE I (MOD. - INLET PROTECTION)**

- STA. 4+850 LT
- STA. 4+850 LT
- STA. 4+964 LT

**613.10 STONE FILL, TYPE I (MOD. - CHECK DAMS)**

- STA. 4+850 LT

**LEGEND**

- PDF — PROJECT DEMARCATION FENCE
- SILT FENCE
- ▣ CULVERT INLET PROTECTION
- ▣ DRAINAGE STRUCTURE PROTECTION
- ▷ CHECK DAM - STONE

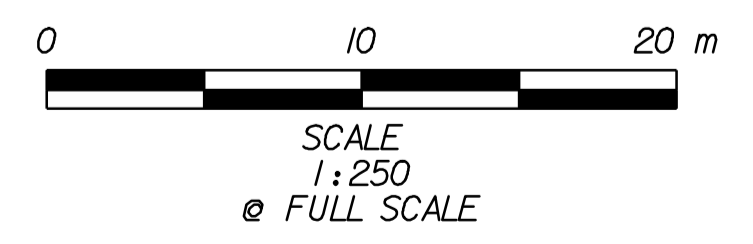
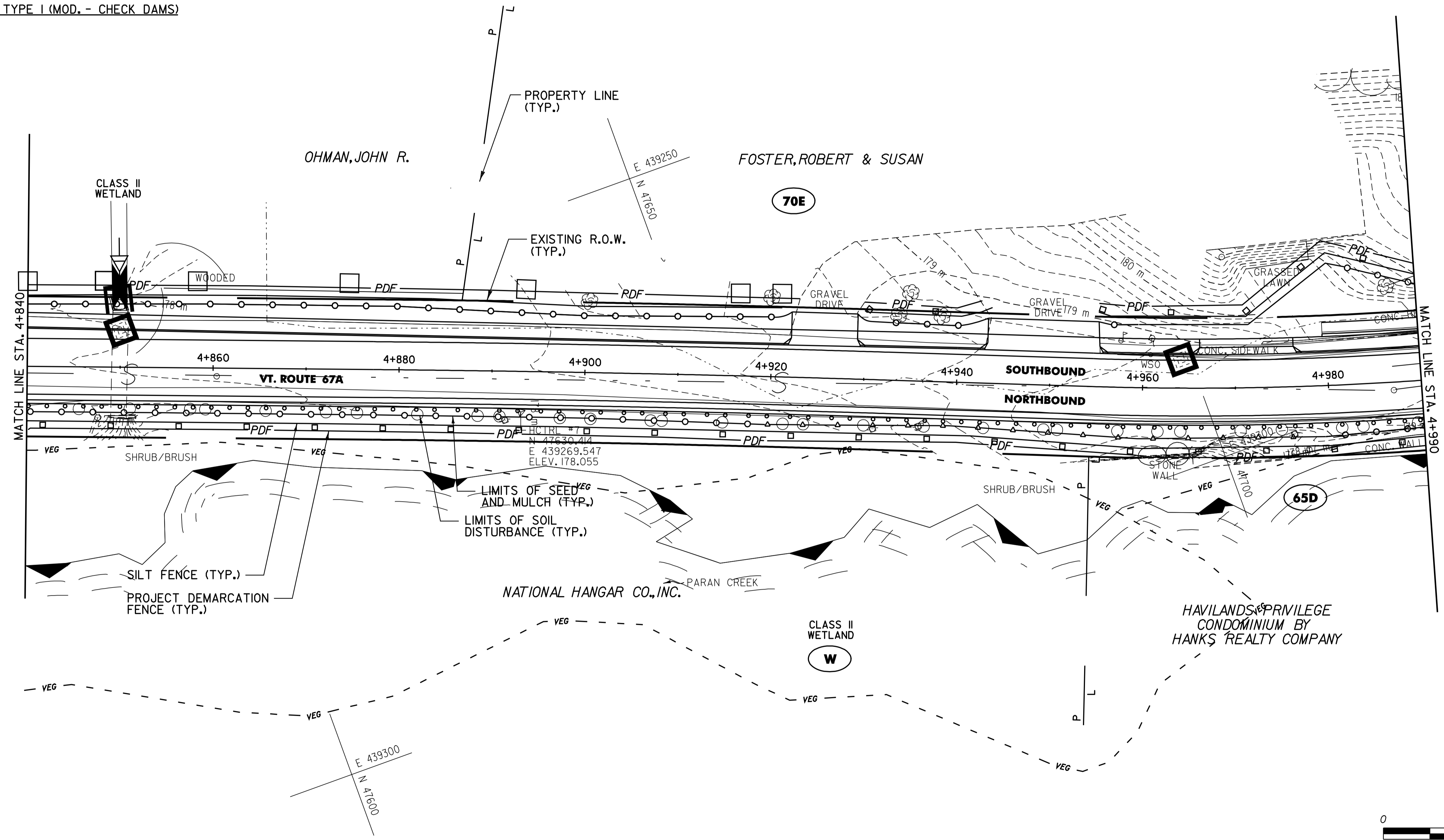
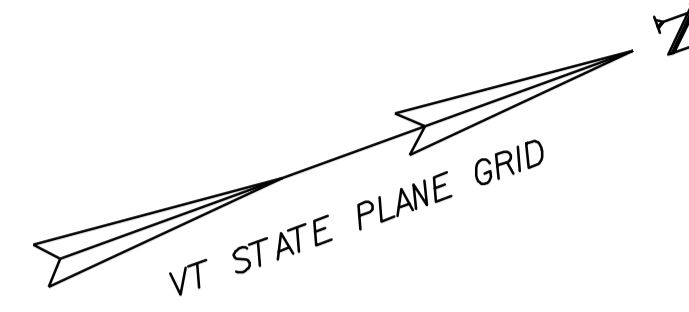

DATUM	
VERTICAL	N/A
HORIZONTAL	NAD83 (1996)

**LEGEND**

- XXX MAP UNIT TYPE (SEE SHEET 47 FOR DETAILS)
- SOIL LINE BOUNDARY
- WETLAND / RIPARIAN BOUNDARY
- WETLAND BUFFER
- RIPARIAN BUFFER

**EROSION PREVENTION & SEDIMENT CONTROL PLAN #10**

SURVEYED BY	L.R.S.C.	DATE	4/03
DRAWN BY	C.A.K.	DATE	3/06
SQUAD LEADER	D.E.G.		
DESIGN FILE NO.	/pave/95d104/pd104.dgn		
IPARM FILE	pd104epsopl0.i	DATE PLOTTED	30-AUG-2010 12:00
PROJ. NAME	NORTH BENNINGTON		
PROJ. NO.	STP 9646(1)S		
SHEET 74	OF 151	SHEETS	