

616.28 CAST-IN-PLACE CONCRETE CURB, TYPE B

VT. ROUTE 67A:  
 STA. 4+040.9 - STA. 4+059.3 LT (18.4 m)  
 STA. 4+069.1 - STA. 4+086.7 LT (17.6 m)  
 STA. 4+091.8 - STA. 4+122.8 LT (31.0 m)  
 STA. 4+127.3 - STA. 4+134.6 LT (7.3 m)  
 STA. 4+139.4 - STA. 4+180.9 LT (41.5 m)  
 STA. 4+185.5 - STA. 4+187.2 LT (1.7 m)

618.10 PORTLAND CEMENT CONCRETE SIDEWALK, 125 mm

VT. ROUTE 67A:  
 STA. 4+040.0 - STA. 4+187.2 LT (225.2 m<sup>2</sup>)

CONSTRUCT DRIVEWAY

VT. ROUTE 67A:  
 STA. 4+063.819 LT  
 STA. 4+088.913 LT  
 STA. 4+124.655 LT  
 STA. 4+136.642 LT  
 STA. 4+182.803 LT

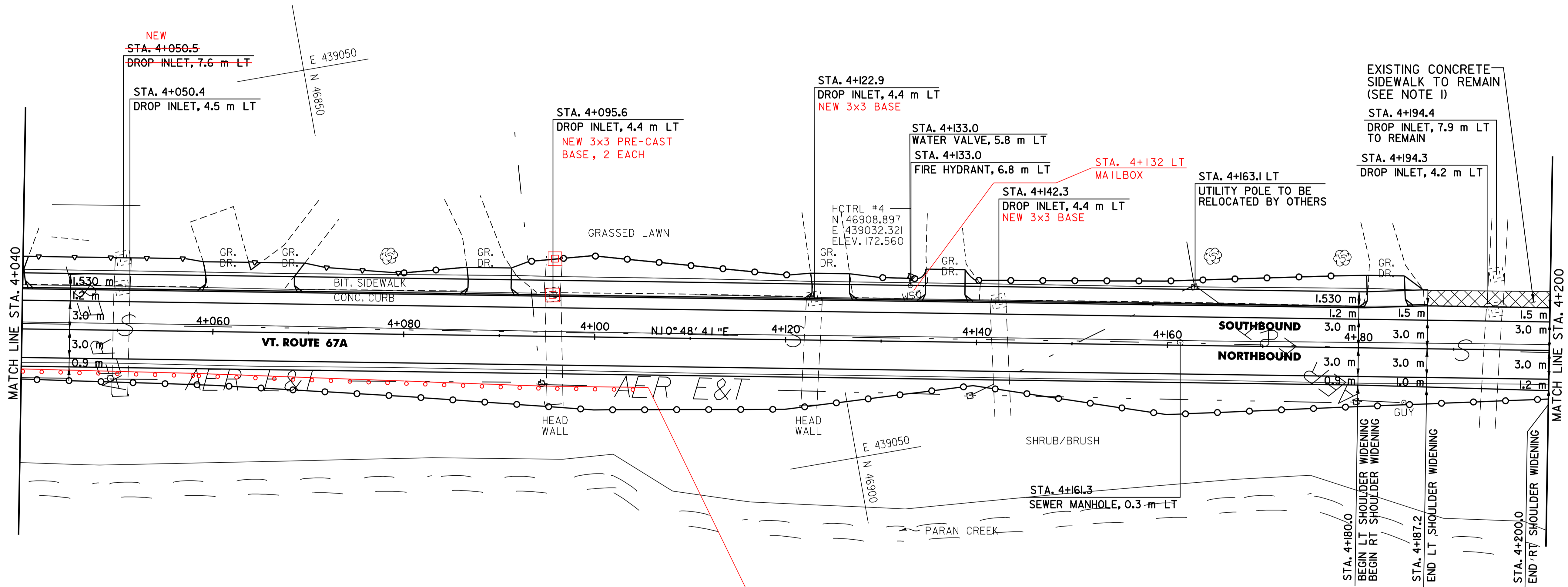
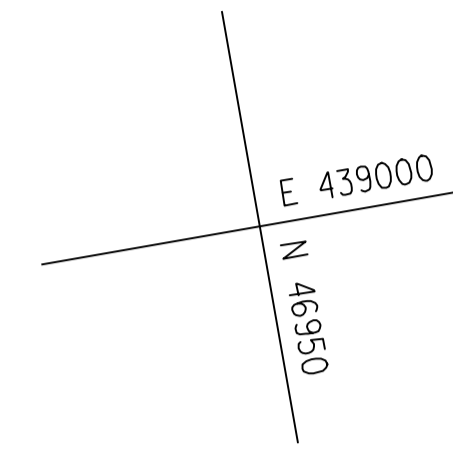
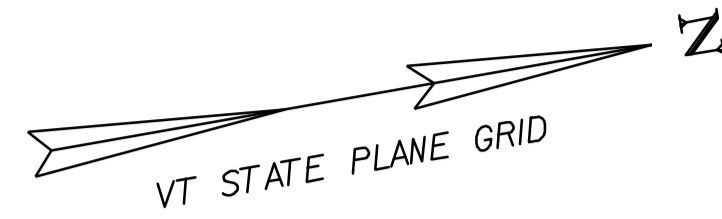

NEW STEEL BEAM GUARDRAIL AND  
 2 MANUFACTURED TERMINAL END SECTIONS  
 STA. 3+999 TO STA. 4+106 O/S RT

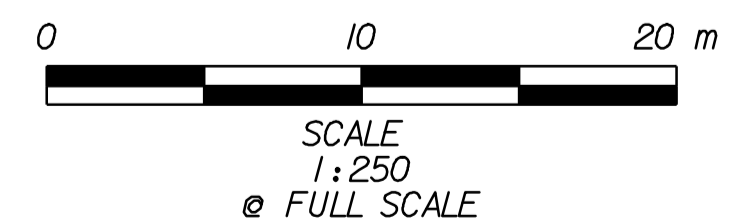

A. O. B. E. TO REHAB DI

~~604.40 CHANGE ELEVATION OF DI, CB OR MH~~

VT. ROUTE 67A:

~~STA. 4+050.5 LT~~

604.412 REHABILITATION OF DI, CB OR MH, CLASS I

VT. ROUTE 67A:  
 STA. 4+050.4 LT  
 STA. 4+095.6 LT  
 STA. 4+122.9 LT  
 STA. 4+142.3 LT  
 STA. 4+194.3 LT

604.42 CHANGE ELEVATION OF SEWER MANHOLE

VT. ROUTE 67A:

STA. 4+161.3 LT

629.20 ADJUST ELEVATION OF VALVE BOX

VT. ROUTE 67A:  
 STA. 4+133.0 LT

629.29 RELOCATE HYDRANT

VT. ROUTE 67A:  
 STA. 4+133.0 LT

NOTE:

1. THE EXISTING CONCRETE SIDEWALK LOCATED IN FRONT OF  
 KRONE OPTICAL STA. 4+187.2 TO STA. 4+543.4 LT IS TO  
 REMAIN.

**PLAN  
 SHEET  
 #5**

SURVEYED BY L.R.S.C. DATE 4/03  
 DRAWN BY C.A.K. DATE 3/06  
 SQUAD LEADER D.E.G.  
 DESIGN FILE NO. /pave/95dl04/pdl04.dgn  
 IPARM FILE pdl04i05.1 DATE PLOTTED 20-AUG-2010 12:  
 PROJ. NAME NORTH BENNINGTON  
 PROJ. NO. STP 9646(IIS)  
 SHEET 37 OF 151 SHEETS

DATUM	
VERTICAL	N/A
HORIZONTAL	NAD83 (1996)