

616.28 CAST-IN-PLACE CONCRETE CURB, TYPE B

VT. ROUTE 67A:
 STA. 3+560.0 - STA. 3+565.7 LT (5.7 m)
 STA. 3+570.6 - STA. 3+581.1 LT (10.5 m)
 STA. 3+588.9 - STA. 3+630.5 LT (41.6 m)
 STA. 3+634.7 - STA. 3+692.9 LT (58.8 m)
 STA. 3+698.1 - STA. 3+720.0 LT (21.9 m)

616.41 REMOVAL OF EXISTING CURB

VT. ROUTE 67A:
 STA. 3+617.0 - STA. 3+720.0 RT (103.0 m)

618.30 DETECTABLE WARNING SURFACE

VT. ROUTE 67A:
 STA. 3+560.0 - STA. 3+720.0 LT (244.8 m²)

CONSTRUCT DRIVEWAY

VT. ROUTE 67A:
 STA. 3+567.925 LT
 STA. 3+584.765 LT
 STA. 3+604.095 RT
 STA. 3+632.176 LT
 STA. 3+695.269 LT

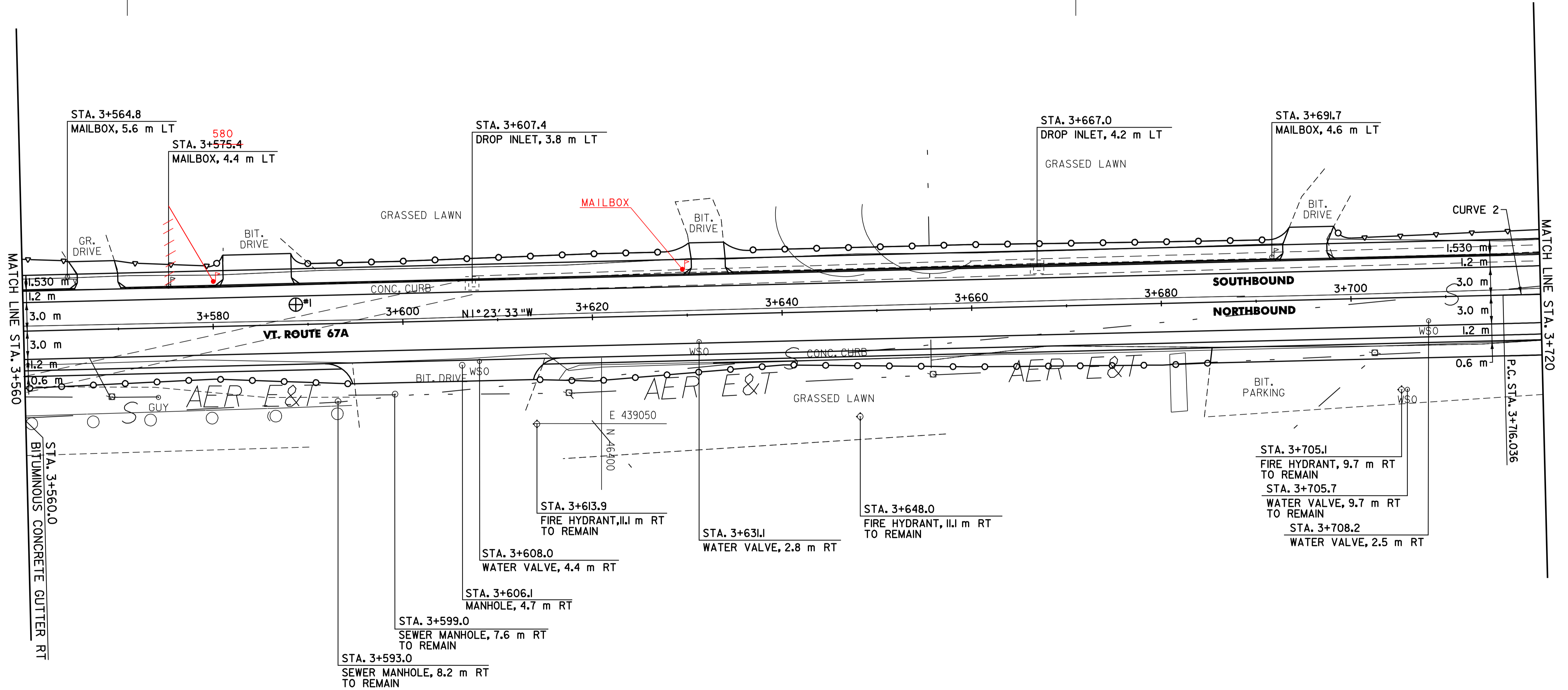
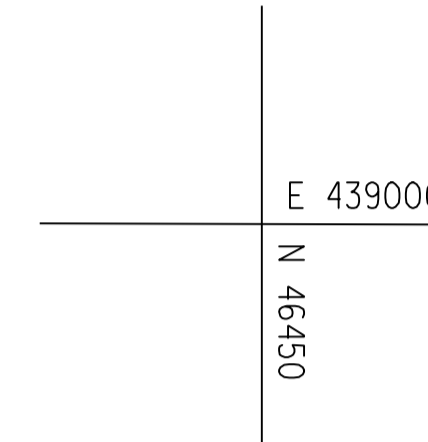
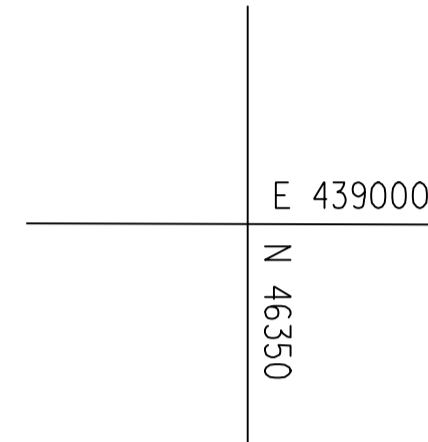

CURVE 2

P.C. = STA. 3+716.036
P.T. = STA. 3+784.312
Δ = 08° - 41' - 35" LT
R = 450.000 m
T = 34.203 m
L = 68.275 m
E = 1.298 m
Emax = NA

604.412 REHABILITATION OF DI, CB OR MH, CLASS J

VT. ROUTE 67A:
 STA. 3+606.1 RT
 STA. 3+607.4 LT
 STA. 3+667.0 LT

616.47 BITUMINOUS CONCRETE GUTTER & TRAFFIC ISLANDS

VT. ROUTE 67A
 STA. 3+560.0 - STA. 3+720.0 RT (20.3 +)

617.10 RELOCATE MAILBOX, SINGLE SUPPORT

VT. ROUTE 67A:
 STA. 3+564.8 LT
 STA. 3+575.4 LT **STA. 3+580 LT**
 STA. 3+691.7 LT

629.20 ADJUST ELEVATION OF VALVE BOX

VT. ROUTE 67A:
 STA. 3+608.0 RT
 STA. 3+631.1 RT
 STA. 3+708.2 RT

PAVEMENT CORES = ⊕

#	TOTAL DEPTH (mm)	PCC	COMMENTS
1	115	YES	

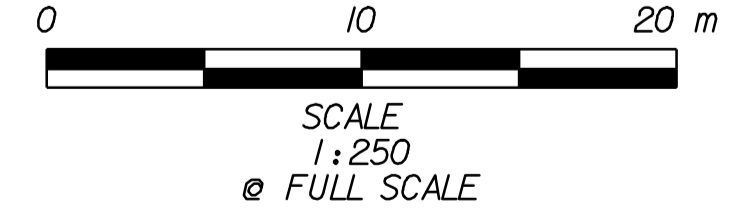

DATUM

VERTICAL	N/A
HORIZONTAL	NAD83 (1996)

PLAN SHEET #2

SURVEYED BY L.R.S.C. DATE 4/03
 DRAWN BY C.A.K. DATE 3/06
 SQUAD LEADER D.E.G.

DESIGN FILE NO. /pave/95d104/pd104.dgn
 IPARM FILE pd104102.1 DATE PLOTTED 20-AUG-2010 12:

PROJ. NAME NORTH BENNINGTON
 PROJ. NO. STP 9646(1)S
 SHEET 34 OF 151 SHEETS