

DURABLE LETTER OR SYMBOL

STA. 11+16	8' LT	ONLY
STA. 11+16	32' LT	ONLY
STA. 11+64	8' LT	ONLY
STA. 11+64	32' LT	ONLY
STA. 12+43	75' LT	ONLY
STA. 12+43	108' LT	ONLY (*)
STA. 12+78	23' RT	ONLY
STA. 12+78	55' RT	ONLY (*)
STA. 13+20	30' LT	ONLY
STA. 13+72	28' LT	ONLY
STA. 14+29	30' LT	ONLY

(\*) OPTIONAL

DURABLE 4" WHITE LINE

STA. 10+50	52.0' LT - 12+17	48.0' LT
STA. 10+50	5.0' LT - 12+03	1.8' LT
STA. 10+50	18.0' LT - 11+93	15.0' LT
STA. 10+50	28.5' LT - 11+93	26.4' LT
STA. 10+50	53.0' LT - 12+06	50.0' LT
STA. 12+03	1.8' LT - 12+33	49.0' RT
STA. 12+06	51.3' LT - 12+36	107.0' LT
STA. 12+48	69.5' LT - 12+48	107.0' LT
STA. 12+73	15.0' RT - 12+73	49.0' RT
STA. 12+75	107.0' LT - 13+05	47.0' LT
STA. 12+84	48.5' RT - 13+15	12.5' LT
STA. 13+05	47.0' LT - 16+75	29.0' LT
STA. 13+13	35.8' LT - 14+31	33.5' LT
STA. 13+15	12.5' LT - 15+00	9.0' LT
STA. 14+31	33.5' LT - 14+98	28.5' LT
STA. 15+00	9.0' LT - 16+75	27.0' RT

(DOTTED)

13+12.5 LT - 16+00.0 LT

CONSTRUCT TRAFFIC CONTROL ISLAND  
(SEE ISLAND LAYOUT DETAIL SHEET)

DURABLE 8" YELLOW LINE

STA. 12+54	13' RT - 28' RT (DIAGONAL)
STA. 16+00 - 16+75	(DIAGONAL)

DURABLE 4" YELLOW LINE (DOUBLE)

STA. 10+50	40.0' LT - 11+93	37.8' LT
STA. 12+60	69.0' LT - 107.0' LT	
STA. 12+58	13.0' RT - 12+68	31.0' RT (ISLAND)
STA. 15+99	21.8' LT - 16+75	16.6' LT
STA. 15+99	12.1' LT - 16+75	10.6' LT

TEMPORARY MARKING

TEMPORARY 4" YELLOW DOUBLE LINE  
TEMPORARY 4" WHITE LINE  
TEMPORARY LETTER OR SYMBOL → 13+72 LT ONLY  
TEMPORARY 8" YELLOW DIAGONAL LINE → 14+29 LT ✓

NOTE: TO FOLLOW SAME STATIONING AS DURABLE MARKING

DURABLE 24" STOP BAR

STA. 11+93	1.9' LT - 11+93	38.0' LT
STA. 12+33	12+61 LT	
STA. 12+60	12+84 RT	
STA. 13+11	22.5' LT - 13+12	47.0' LT

DURABLE 4" YELLOW LINE

STA. 13+12	20.7' LT - 3' RADIUS	
STA. 13+14	17.6' LT - 15+99	107.0' LT
STA. 13+14	23.6' LT - 14+27	21.4' LT
STA. 14+27	21.4' LT - 14+97	28.8' LT
STA. 14+97	28.8' LT - 15+99	21.8' LT

PAINTED ISLAND

STA. 13+12 LT - 16+00 LT

VERTICAL GRANITE CURB

11+50 RT - SHOPPING CENTER DR.  
SHOPPING CENTER DR. - 13+34 RT

REMOVAL OF EXISTING SIGNAL SYSTEM - 1

(SPANWIRE, SIGNAL HEADS AND THE CONTROLLER ARE TO BE REMOVED, THE POLES AND VERIZON WIRE TO BE RETAINED) (LUMINAIRES OWNED BY GREEN MTN. POWER ARE TO BE REMOVED)

NOTE:  
COLD PLANING LIMITS ARE THE EDGES OF THE ROADWAY (US 7) AND THE LIMITS, AS SHOWN FOR THE MOBIL AND HIGHGATE COMMONS DRIVES.

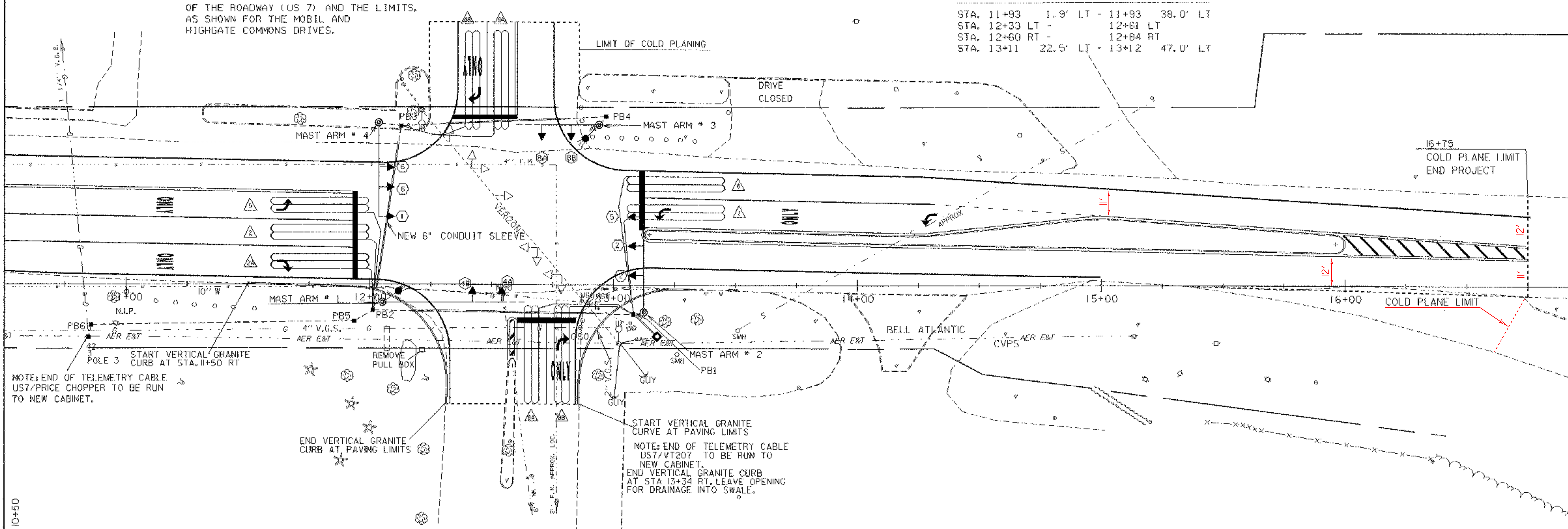

10+50

10+50

NOTE: END OF TELEMETRY CABLE US7/PRICE CHOPPER TO BE RUN TO NEW CABINET.

END VERTICAL GRANITE CURB AT PAVING LIMITS

NOTE: END OF TELEMETRY CABLE US7/VT207 TO BE RUN TO NEW CABINET. END VERTICAL GRANITE CURB AT STA 13+34 RT. LEAVE OPENING FOR DRAINAGE INTO SWALE.

EXISTING	NEW	LEGEND
○	○	UTILITY POLE
○	○	LUMINAIRE
○	○	STRAIN POLE
○	○	CONTROL CABINET
○	○	PULLBOX/ADDITION BOX
○	○	SIGNAL HEAD
○	○	CONDUIT
○	○	VEHICLE LOSS
○	○	PEDESTAL POLE
○	○	STATIONING
○	○	MARKER

NOTE: EXISTING LUMINAIRES ON EXISTING STRAIN POLES ARE TO BE REMOVED BY CVPS (CENTRAL VERMONT PUBLIC SERVICE)  
NOTE: BACK PLATES TO BE INSTALLED ON ALL SIGNAL HEADS

# LAYOUT AND PAVEMENT MARKING SHEET

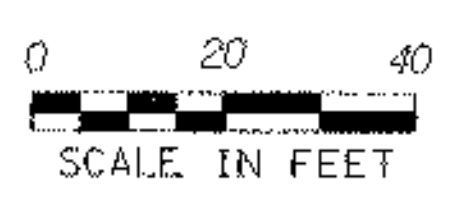

PROJECT NAME:	ST ALBANS	PLOT DATE:	09-JUL-2003
PROJECT NUMBER:	STPG SGNL (7)S	DRAWN BY:	
FILE NAME:	795cl88/ref=mul.sav,1.e	CHECKED BY:	
DESIGNED BY:	jfg	SHEET	10 OF 19
+cl88pm2.1			