

TEMPORARY AND DURABLE 100mm WHITE LINE

STA 7+400	TO	7+467	SOLID LT
STA 7+400	TO	7+590	SOLID RT
STA 7+491	TO	8+600	SOLID LT
STA 7+614	TO	8+600	SOLID RT

TEMPORARY AND DURABLE 100mm YELLOW LINE

STA 7+400	TO	7+473	SOLID LT & RT
STA 7+479	TO	7+596	DOUBLE SOLID LT (S.A. 2)
STA 7+485	TO	7+596	SOLID LT & RT
STA 7+608	TO	8+103	SOLID LT & RT
STA 8+103	TO	8+336	SOLID LT, DASHED RT
STA 8+336	TO	8+352	DASHED
STA 8+352	TO	8+578	DASHED LT, SOLID RT
STA 8+578	TO	8+600	SOLID LT & RT

TEMPORARY AND DURABLE 600 mm STOP BAR

STA 7+479	LT (S.A. 2)
-----------	-------------

TEMPORARY AND DURABLE LETTER OR SYMBOL

STA 7+479	LT "STOP" (S.A. 2)
-----------	--------------------

PAVEMENT CORES - ⊗

#	STA	TOTAL DEPTH (MM)	PCC
10	7+701 RT	159	NO
11	8+291 LT	171	NO

DATUM
VERTICAL _____
HORIZONTAL _____

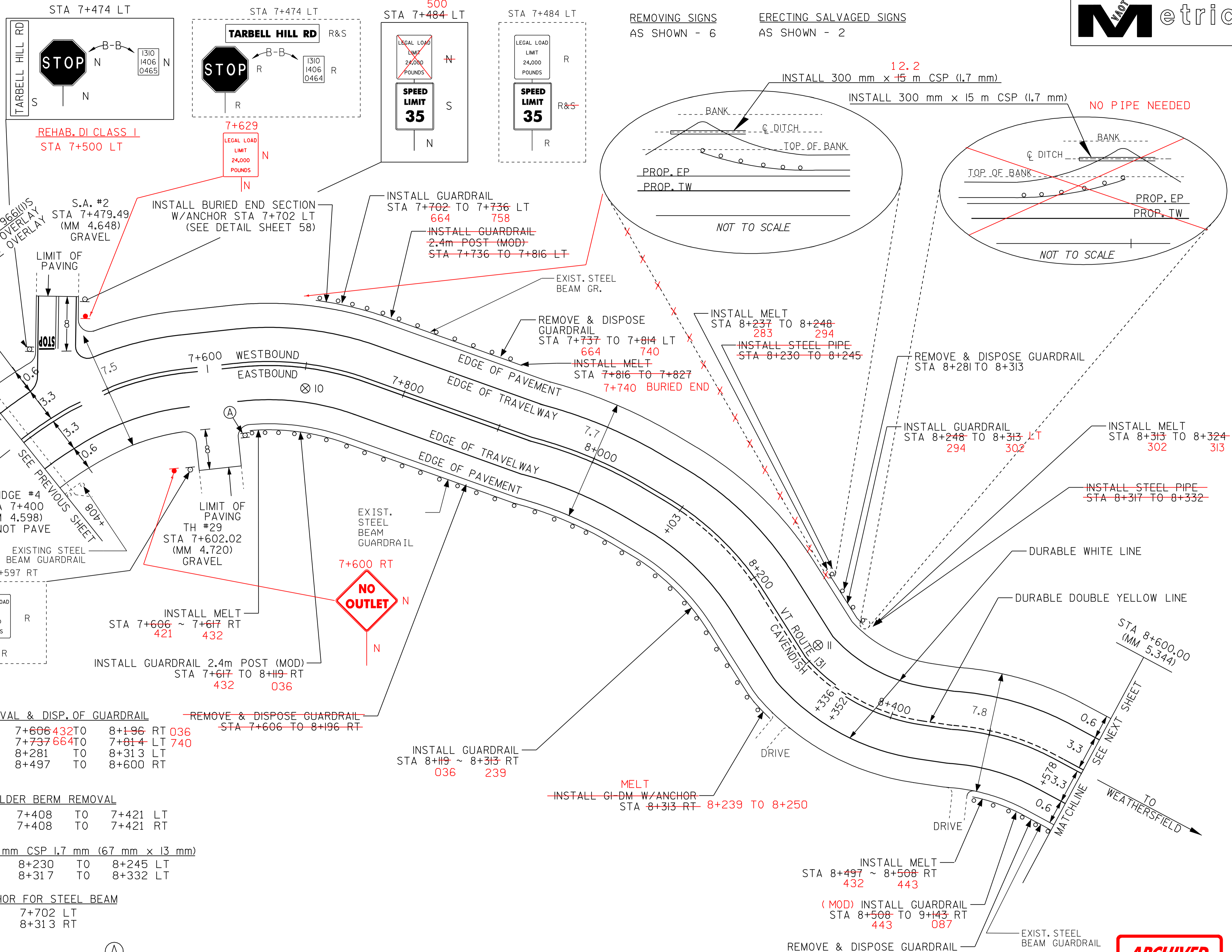

STEEL BEAM GUARDRAIL (2.4m POSTS) (MOD)

STA 7+617	432	TO	8+119	RT	036
STA 7+736		TO	7+816	LT	

STEEL BEAM GUARDRAIL

STA 7+702	664	TO	7+736	LT	758
STA 8+119	036	TO	8+313	RT	239
STA 8+248	294	TO	8+313	LT	302

MODIFIED ECCENTRIC LOADER TERMINAL

STA 7+617	LT	7+421	TO	7+432	RT
STA 7+816	LT	8+253	TO	8+294	RT
STA 8+248	LT	8+302	TO	8+313	LT
STA 8+313	LT	8+432	TO	8+443	RT

REMOVAL & DISP. OF GUARDRAIL

STA 7+606	432	TO	8+196	RT	036
STA 7+737	664	TO	7+814	LT	740
STA 8+281		TO	8+313	LT	
STA 8+497		TO	8+600	RT	

SHOULDER BERM REMOVAL

STA 7+408	TO	7+421	LT
STA 7+408	TO	7+421	RT

300 mm CSP 1.7 mm (67 mm x 13 mm)

STA 8+230	TO	8+245	LT
STA 8+317	TO	8+332	LT

ANCHOR FOR STEEL BEAM

STA 7+702	LT
STA 8+313	RT

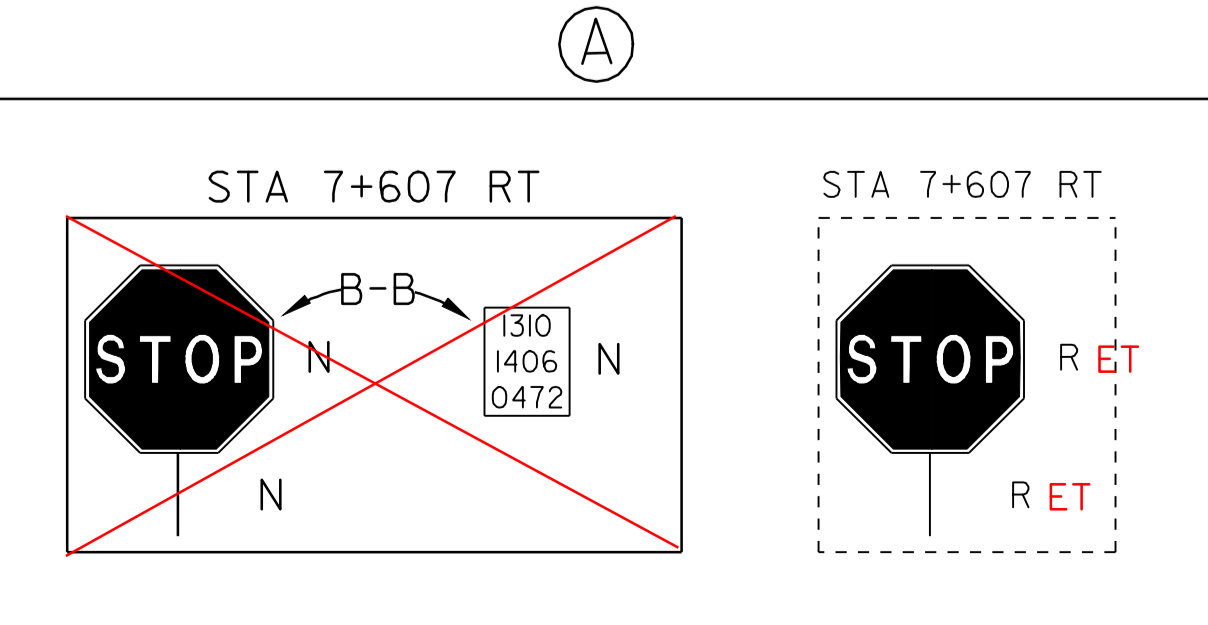

NOT TO SCALE

- LEGEND
- R = REMOVE EXISTING
 - S = SALVAGE
 - R&S = REMOVE AND SALVAGE
 - N = NEW
 - RET = RETAIN
 - B-B = BACK TO BACK
 - = NEW RAIL
 - = EXISTING RAIL
 - ⊗ = BORING LOCATION

PAVING PROJECT LAYOUT

PROJECT:	CAVENDISH-WEATHERSFIELD	PROJECT NO.:	STP 9661(1) S
DESIGN FILE NAME:	/pave/95cl34/pcl34.dgn	PLOT DATE:	27-JAN-2006
IPARM FILE NAME:	_pcl34i07.i	SURVEY DATE:	06/97
SURVEYED BY:	CLD, Inc.	DRAWN BY:	JPC
SQUAD LEADER:	JAW	SHEET:	15 OF 32

NOTE: ALL DIMENSIONS IN METERS EXCEPT AS INDICATED

ARCHIVED IN DPR