

4' WHITE LINE
 FROM STA. TO STA.
 103+00.00 LT - 108+00.00 LT
 103+00.00 RT - 108+00.00 RT

4' YELLOW LINE (DOUBLE)
 FROM STA. TO STA.
 103+00.00 - 108+00.00

REMOVAL AND DISPOSAL OF GUARDRAIL
 FROM STA. TO STA.
 103+73.00 - 104+67.00 LT
 104+47.00 - 104+89.00 RT
 105+51.00 - 105+63.00 LT
 105+73.00 - 105+86.00 RT

TRANSPLANTING SHRUBS
 STA. OFFSET
 103+49.93 24.65 RT
 103+89.10 34.93 RT
 103+20 RT

ANCHOR FOR STEEL BEAM RAIL VT 12
 103+85.00 LT
 104+20.00 RT
 106+28.00 LT
 106+37.00 RT

CONSTRUCT DRIVE (GRAVEL)
 103+28.50 RT (WIDTH 12')

STEEL BEAM GUARDRAIL, GALVANIZED VT 12
 FROM STA. TO STA.
 103+80.00 - 104+28.79 LT
 104+15.42 - 104+39.78 RT
 106+07.58 - 106+28.22 LT
 106+18.50 - 106+42.30 RT

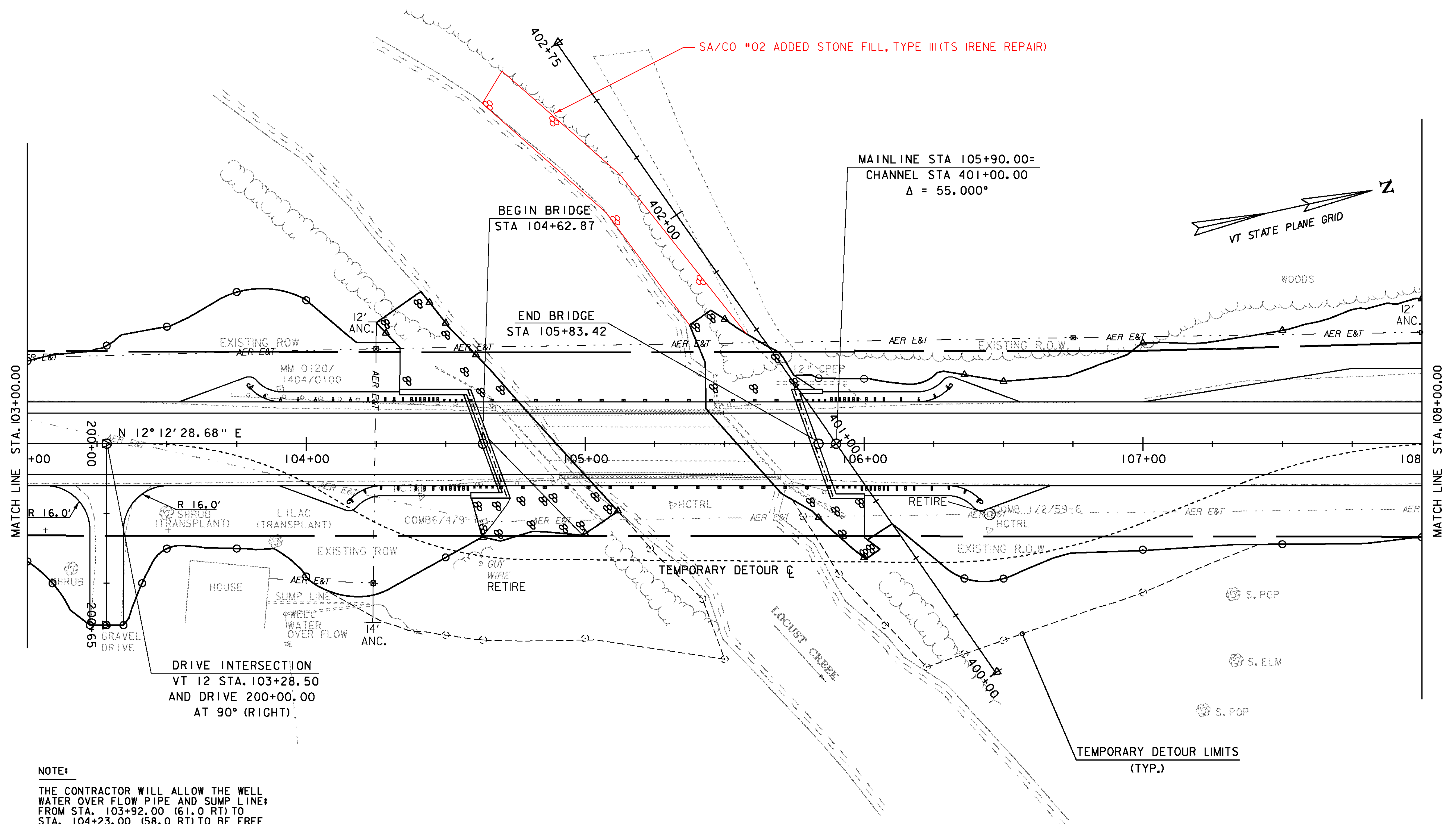

NOTE:
 THE CONTRACTOR WILL ALLOW THE WELL WATER OVER FLOW PIPE AND SUMP LINE; FROM STA. 103+92.00 (61.0 RT) TO STA. 104+23.00 (58.0 RT) TO BE FREE FLOWING AT ALL PHASES OF THE PROJECT. THIS INCLUDES THE PIPES OVER FLOW DITCH TO BE FREE OF OBSTRUCTIONS AT ALL TIMES. THE FLOW OF DITCH IS AS INDICATED.

DELINEATOR WITH STEEL POST
 STA. 103+88.00 LT 18'(GREEN)
 STA. 104+15.00 RT 18'(BLUE)
 STA. 106+25.00 LT 18'(BLUE)
 STA. 106+31.00 RT 18'(GREEN)

GUARDRAIL APPROACH SECTION,
 GALVANIZED NETC 2 RAIL
 FROM STA. TO STA.
 104+28.79 - 104+58.29 LT
 104+39.78 - 104+69.20 RT
 105+78.17 - 106+07.58 LT
 105+89.08 - 106+18.50 RT

BRIDGE RAILING, GALVANIZED NETC 2 RAIL
 FROM STA. TO STA.
 104+58.29 - 105+78.17 LT
 104+69.20 - 105+89.08 RT

EXISTING BRIDGE DATA
 SIMPLE SPAN WITH CONCRETE DECK
 YEAR BUILT: 1939
 CLEAR SPAN: 58 FT.
 VERTICAL CLEARANCE: 9.5 FT.
 WATERWAY OF FULL OPENING: 440 SQ. FT.
 EXISTING BRIDGE RAIL: TEMPORARY CONCRETE BARRIER

SCALE 1" = 20'-0"
 20 0 20

PROJECT NAME: BETHEL
 PROJECT NUMBER: BHF 0241 (30)

FILE NAME: sc002bdr.dgn
 PROJECT LEADER: M. EVANS-MONGEON
 DESIGNED BY: U. STANLEY
 LAYOUT SHEET 2

PLOT DATE: 31-AUG-2011
 DRAWN BY: G. ROKES
 CHECKED BY: U. STANLEY
 SHEET 12 OF 64