



**EROSION MATTING**  
 STA 1+244 - 1+282 LT

**CHANGING ELEV. OF DROP INLETS, CATCH BASINS OR MANHOLES**  
 STA 30+250 LT  
 STA 30+285 LT  
 STA 30+323 RT  
 STA 30+326 LT & RT  
 STA 30+337 LT & RT

**STONE FILL, TYPE I**  
 STA 1+255 LT  
 STA 1+270 LT  
 STA 1+295 LT  
 STA 1+310 LT

**STA 1+240.000  
 BEGIN TEMPORARY CROSSOVER**

**STA 1+428.000  
 END TEMPORARY CROSSOVER**

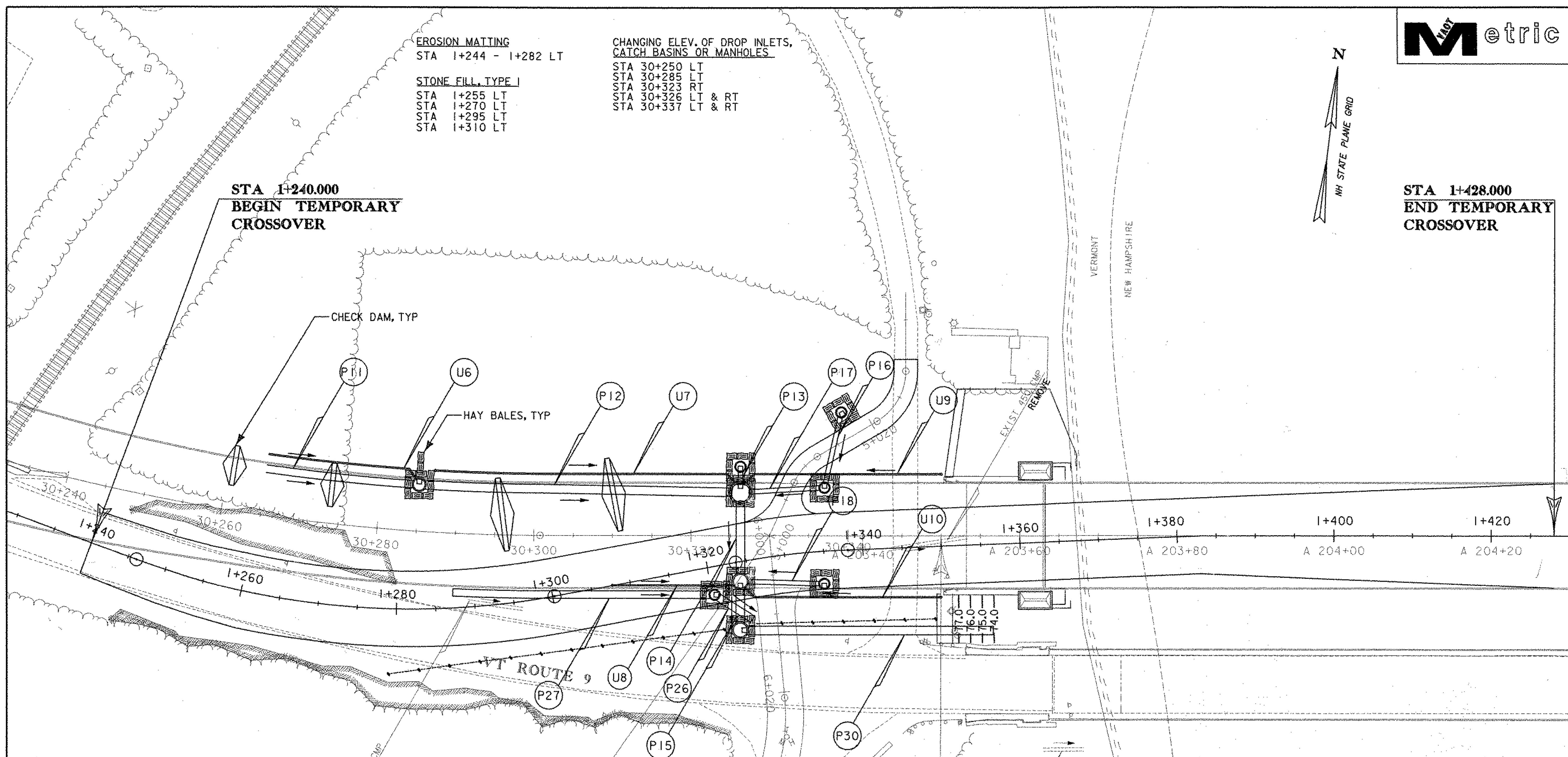

- (P11) STA. 30+265 LT TO STA. 30+285 LT  
 NEW 900 mm x 18.5 m PCCSP (2.01) OR CAAP (1.52)  
 CAP FOR FUTURE USE
- (P12) STA. 30+285 LT TO STA. 30+326 LT  
 NEW 900 mm x 39.3 m RCP (CLASS III) OR CPEP (SL)  
 NEW PRCCB AT INLET (1.5 m DIA.)  
 W/ CI GRATE TYPE D
- (P13) STA. 30+326 LT  
 NEW 450 mm x 1.5 m RCP (CLASS III) OR CPEP (SL)  
 OR PCCSP (1.63) OR CAAP (1.52)  
 NEW PRCCB AT INLET (1.2 m DIA.)  
 W/ CI GRATE TYPE A
- (P14) STA. 30+326 LT TO STA. 30+326 RT  
 NEW 900 mm x 9.2 m RCP (CLASS III) OR CPEP (SL)  
 NEW PRCCB AT INLET (2.1 m DIA.)  
 W/ CI GRATE TYPE D
- (P15) STA. 30+326 RT  
 NEW 900 mm x 4.8 m RCP (CLASS III) OR CPEP (SL)  
 NEW PRCCB AT INLET (1.8 m DIA.)  
 W/ CI GRATE TYPE D
- (P16) STA. 30+337 LT TO STA. 5+016 LT  
 NEW 450 mm x 8.8 m RCP (CLASS III) OR CPEP (SL)  
 OR PCCSP (1.63) OR CAAP (1.52)  
 NEW PRCCB AT INLET (1.2 m DIA.)  
 W/ CI GRATE TYPE A
- (P17) STA. 30+326 LT TO STA. 30+337 LT  
 NEW 450 mm x 9.0 m RCP (CLASS III) OR CPEP (SL)  
 OR PCCSP (1.63) OR CAAP (1.52)  
 NEW PRCCB AT INLET (1.2 m DIA.)  
 W/ CI GRATE TYPE D

- (P18) STA. 30+326 RT TO STA. 30+337 RT  
 NEW 450 mm x 9.2 m RCP (CLASS III) OR CPEP (SL)  
 OR PCCSP (1.63) OR CAAP (1.52)  
 NEW PRCCB AT INLET (1.2 m DIA.)  
 W/ CI GRATE TYPE D
- (P26) STA. 30+323 RT TO STA. 30+328 RT  
 NEW 750 mm x 5.4 m RCP (CLASS III) OR CPEP (SL)  
 CAP FOR FUTURE USE  
 NEW PRCMH AT INLET (1.5 m)  
 W/ CI COVER
- (P27) STA. 30+290 RT TO STA. 30+323 RT  
 NEW 750 mm x 32.8 m PCCSP (2.01) OR CAAP (1.52)  
 CAP FOR FUTURE USE
- (P30) STA. 30+326 RT TO STA. A203+57 RT  
 NEW 900 mm x 31.5 m RCP (CLASS III) OR CPEP (SL)  
 OUTLET ONTO STONE FILL BETWEEN ABUTMENTS  
 NEW PRCCB AT INLET (1.8 m DIA.)  
 W/ CI GRATE TYPE A  
 THE INTENT IS TO TEMPORARILY USE THE PRCCB INTENDED  
 FOR STA 30+326 RT AT THIS LOCATION

- (U6) STA. 30+265 LT TO STA. 30+285 LT  
 NEW 150 mm UD CAP FOR FUTURE USE
- (U7) STA. 30+287 LT TO STA. 30+326 LT  
 NEW 150 mm UD w/ FLUSHING BASIN AT STA 30+287
- (U8) STA. 30+310 RT TO STA. 30+326 RT  
 NEW 150 mm UD w/ FLUSHING BASIN AT STA 30+310
- (U9) STA. 30+326 LT TO STA. A203+50 LT  
 NEW 150 mm UD w/ FLUSHING BASIN AT STA A203+50
- (U10) STA. 30+326 RT TO STA. A203+50 RT  
 NEW 150 mm UD w/ FLUSHING BASIN AT STA A203+50

STA A203+50.000  
 END PROJECT  
 NH 010-2(2)  
 BEGIN NH PROJECT 11999

**DRAINAGE & EROSION CONTROL PLAN**

PROJECT NAME: BRATTLEBORO	PROJECT NUMBER: NH 010-2(2)
FILE NAME: ... \zb270drn.dgn	PLOT DATE: 03/31/2003
PROJECT LEADER: WRH	DRAWN BY: PTS
DESIGNED BY:	CHECKED BY: JAW
CLD REF NO. 02-0439	SHEET 9 OF 13

168 ROK