

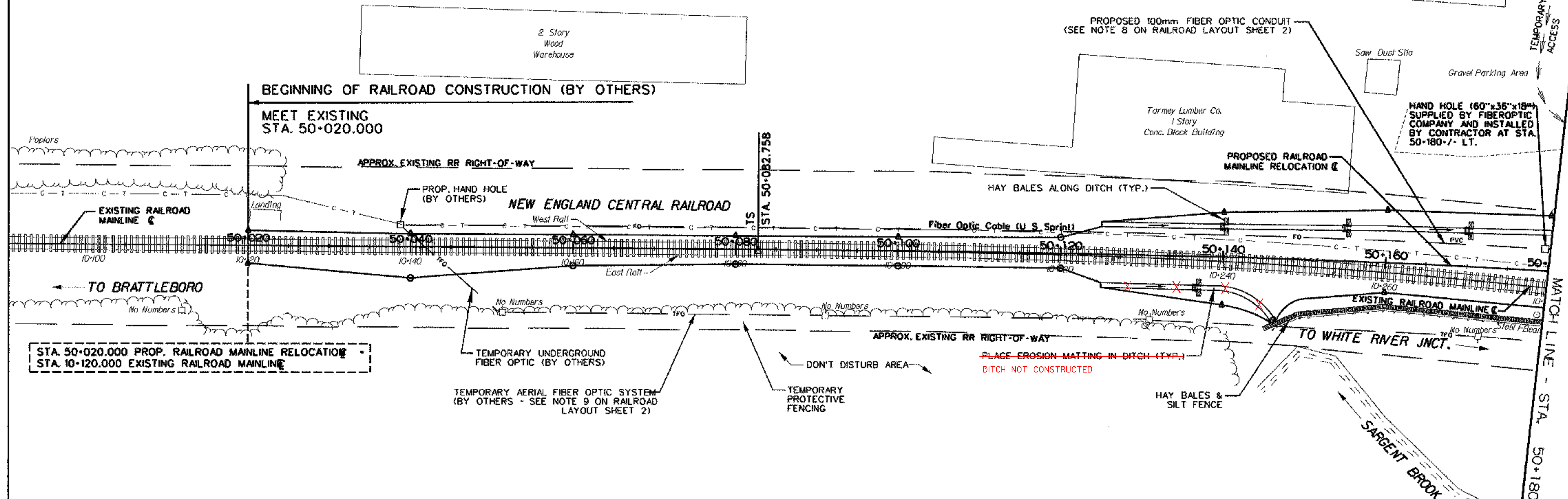

BRADFORD DRIVE
TEMPORARY CONSTRUCTION ACCESS (Private)



STA. 50+020.000 PROP. RAILROAD MAINLINE RELOCATION
STA. 10+120.000 EXISTING RAILROAD MAINLINE

EROSION MATTING
50+125 LT. TO 50+180 LT.
50+125 RT. TO 50+146 RT.

FIBER OPTIC CONDUIT
50+040 LT. TO 50+180 LT. WITH HAND HOLE AT STA. 50+180 LT.

TRACK REHABILITATION AND RELOCATION (BY OTHERS)
50+020 TO 50+180

- NOTES:**
1. FOR GENERAL NOTES, REFER TO SHEETS 6 AND 7.
 2. BOND WIRE BETWEEN RAILS AT APPROX. STA. 50+051 PROP. RAILROAD MAINLINE RELOCATION, C.
 3. SEE VAOT STANDARD DRAWINGS T-1M AND T-2M FOR TEMPORARY EROSION CONTROL DETAILS.



PROJECT NAME:	BRATTLEBORO	PLOT DATE:	10-02-2002
PROJECT NUMBER:	NH 010-2(2)	DRAWN BY:	DHL/LB/LRD
FILE NAME:	zb270bdr.dgn	DESIGNED BY:	GJB
PROJECT LEADER:	JHR	CHECKED BY:	TEM
		SHEET	35 OF 145

RAILROAD LAYOUT SHEET 1