

THE ELLIS ROBERTSON CO., INC., AS LESSOR
 ROUNTREE MOTORS, INC., AS LESSEE

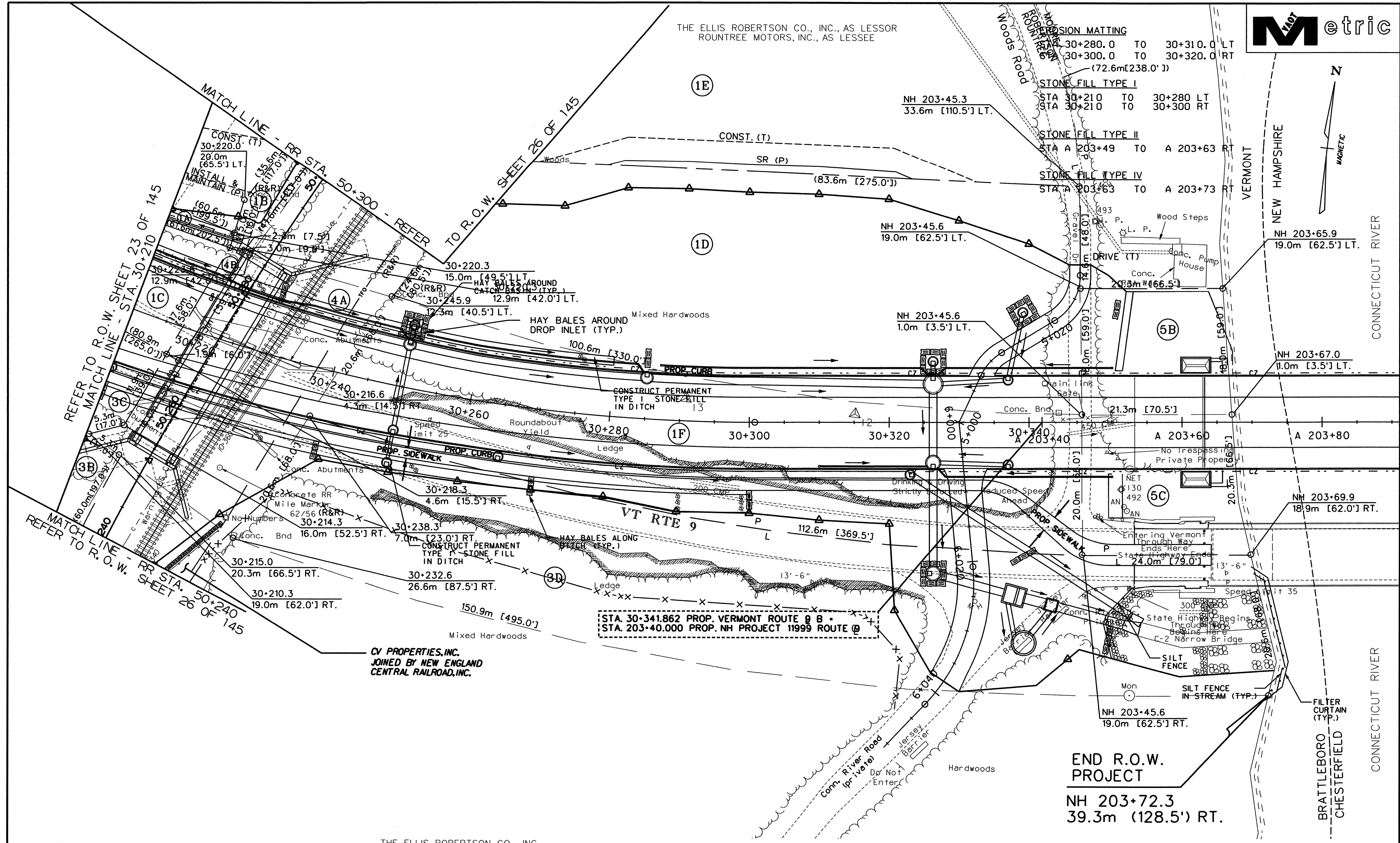

DATUM
 VERTICAL NGVD 1929
 HORIZONTAL NAD 1983

LINES SHOWN ON THIS PLAN AS EXISTING PROPERTY LINES (P/L) ARE BELIEVED TO BE ACCURATE BUT SHOULD NOT BE RELIED UPON FOR PURPOSES UNRELATED TO THE STATE OF VERMONT'S ACQUISITION OF LAND AND RIGHTS FOR THIS PROJECT.



GENERAL PLAN
 PROJECT NAME: BRATTLEBORO
 PROJECT NUMBER: NH 010-2(2)
 FILE NAME: ZB270BD3
 PROJECT LEADER: JHR
 DESIGNED BY: GJB
 R.O.W. LAYOUT SHEET 2
 PLOT DATE: 10-03-2002
 DRAWN BY: LB/LRD
 CHECKED BY: TEM/JHR
 SHEET 24 OF 145

THE ELLIS ROBERTSON CO., INC.

CV PROPERTIES, INC.
 JOINED BY NEW ENGLAND
 CENTRAL RAILROAD, INC.

END R.O.W. PROJECT
 NH 203+72.3
 39.3m (128.5') RT.