

Figure 6C-2. Types of Tapers and Buffer Spaces

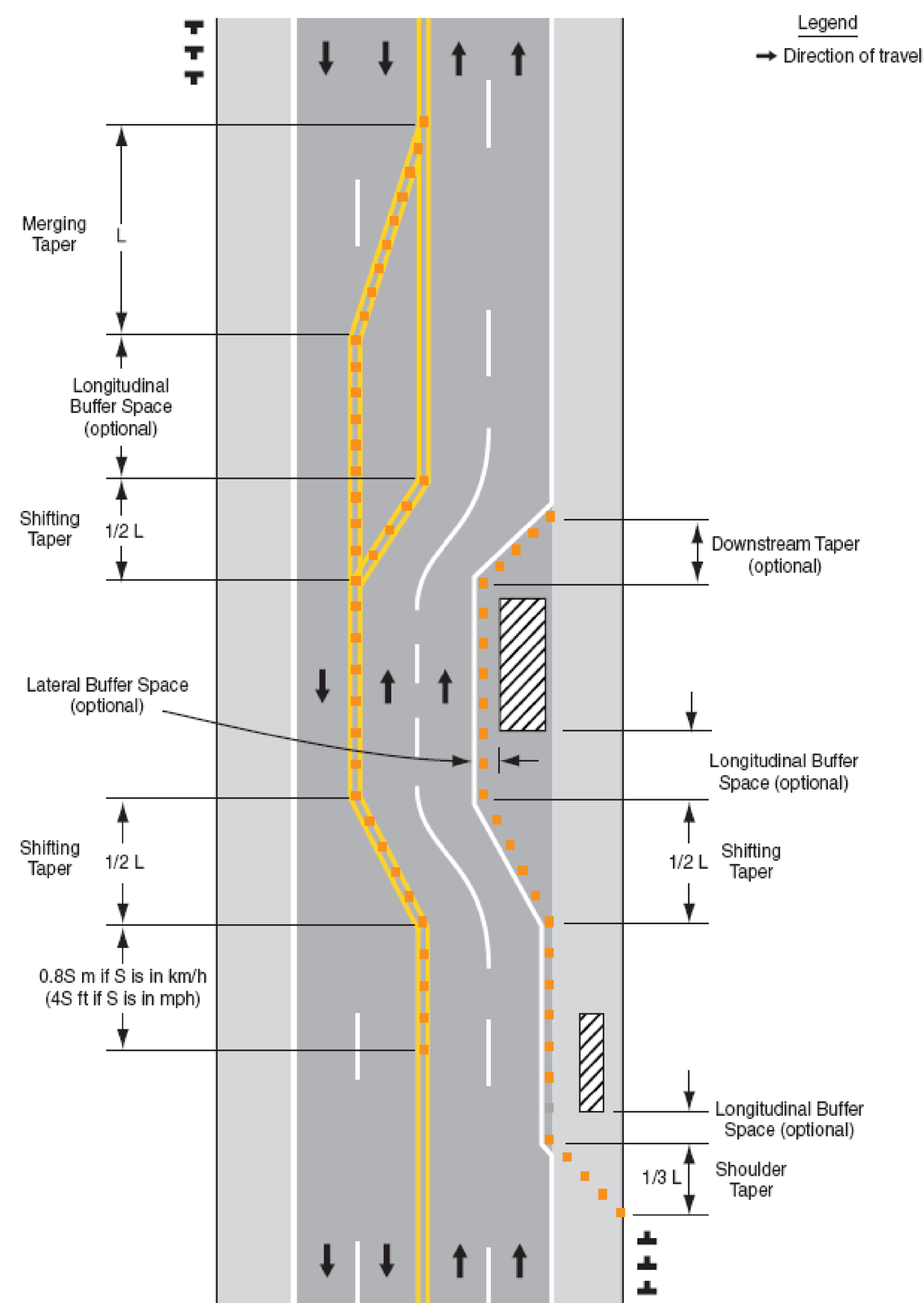

Table 6C-3. Taper Length Criteria for Temporary Traffic Control Zones

Type of Taper	Taper Length (L)*
Merging Taper	at least L
Shifting Taper	at least 0.5L
Shoulder Taper	at least 0.33L
One-Lane, Two-Way Traffic Taper	30 m (100 ft) maximum
Downstream Taper	30 m (100 ft) per lane

Table 6C-4. Formulas for Determining Taper Lengths

Speed Limit (S)	Taper Length (L) Meters	Speed Limit (S)	Taper Length (L) Feet
60 km/h or less	$L = \frac{WS^2}{155}$	40 mph or less	$L = \frac{WS^2}{60}$
70 km/h or more	$L = \frac{WS}{1.6}$	45 mph or more	$L = WS$

Where: L = taper length in meters (feet)  
W = width of offset in meters (feet)  
S = posted speed limit, or off-peak 85th-percentile speed prior to work starting, or the anticipated operating speed in km/h (mph)

**NOTES**

1. SEE SHEET 183 FOR THE MEANING OF THE LETTER CODES AND SYMBOLS USED IN THIS FIGURE.

**TRAFFIC CONTROL SHEET 2**

PROJECT NAME: ADDISON - NEW HAVEN  
PROJECT NUMBER: STP 9632(1)  
FILE NAME: p95B076.dgn  
PROJECT LEADER: CDL  
DESIGNED BY: SJL  
PLOT FILE: p95B076.184.1  
PLOT DATE: 3/13/2012  
DRAWN BY: SJL  
CHECKED BY: EPD  
SHEET 184 OF 186