

CURVE #27  
 DELTA = 1°39'42"  
 D = 0°42'58"  
 R = 8000.00'  
 T = 116.02'  
 L = 232.03'  
 NORMAL CROWN

STONE FILL, TYPE I  
 STA. d 129+75 - STA. d 130+85 RT

GRUBBING MATERIAL  
 STA. d 129+75 - STA. d 130+85 RT

GEOTEXTILE FOR SILT FENCE  
 STA. d 129+75 - STA. d 130+85 RT

GEOTEXTILE UNDER STONE FILL  
 STA. d 129+75 - STA. d 130+85 RT

DURABLE 4 INCH WHITE LINE (SEE OPTION ITEMS)  
 STA. d 126+25 - STA. d 131+75 (SOLID LT & RT)

TEMPORARY 4 INCH WHITE LINE, PAINT  
 STA. d 126+25 - STA. d 131+75 (SOLID LT & RT)

RELOCATE MAILBOX, SINGLE SUPPORT  
 STA. d 131+29 RT

DURABLE 4 INCH YELLOW LINE (SEE OPTION ITEMS)  
 STA. d 126+25 - STA. d 131+75 (SOLID LT & RT)

TEMPORARY 4 INCH YELLOW LINE, PAINT  
 STA. d 126+25 - STA. d 131+75 (SOLID LT & RT)

CURVE #28  
 DELTA = 3°12'28"  
 D = 1°05'29"  
 R = 5250.00'  
 T = 147.01'  
 L = 293.94'  
 BANKING 0.02 FT/FT  
 140' RUNOFF (45 MPH)  
 SEE SUPERELEVATION DIAGRAMS  
 FOR BANKING INFORMATION

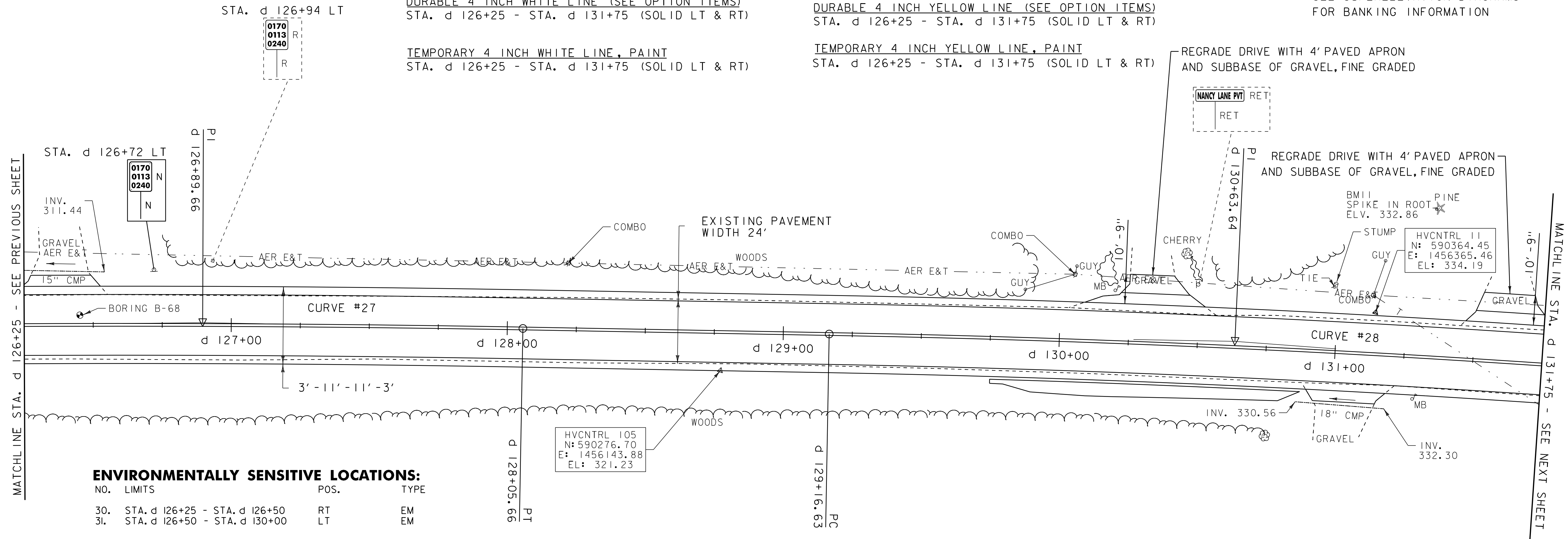
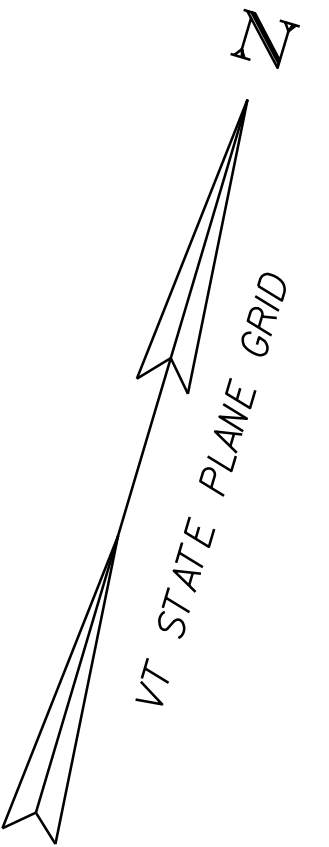

**ENVIRONMENTALLY SENSITIVE LOCATIONS:**

NO.	LIMITS	POS.	TYPE
30.	STA. d 126+25 - STA. d 126+50	RT	EM
31.	STA. d 126+50 - STA. d 130+00	LT	EM

KEY:  
 EM - EMERGENT WETLAND  
 FO - FORESTED WETLAND  
 SS - SCRUB-SHRUB WETLAND

**LEGEND**

- SIGN
- HYDRANT
- MANHOLE
- GATE VALVE
- GAS PIPELINE MARKER
- CATCH BASIN / DROP INLET
- CURB INLET
- ⊙ BORING LOCATION
- ⊙ MAILBOX
- ⊙ UTILITY POLE
- ⊙ FLUSHING BASIN

**SIGN LEGEND**

- R = REMOVE
- R&S = REMOVE AND SALVAGE
- RET = RETAIN
- S = SALVAGE
- N = NEW
- B-B = BACK TO BACK

DATUM  
 NAVD 88  
 NAD 83

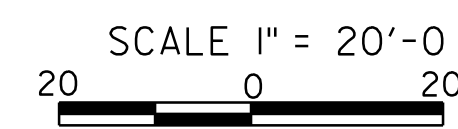

**PROJECT LAYOUT SHEET 59**

PROJECT NAME: ADDISON - NEW HAVEN

PROJECT NUMBER: STP 9632(1)

FILE NAME: p95B076.dgn  
 PROJECT LEADER: CDL  
 DESIGNED BY: SJL  
 PLOT FILE: p95B076\_82.1

PLOT DATE: 3/13/2012  
 DRAWN BY: SJL  
 CHECKED BY: EPD  
 SHEET 82 OF 186