

DURABLE 4 INCH WHITE LINE (SEE OPTION ITEMS)  
 STA. c 40+50 - STA. c 46+25 (SOLID LT & RT)

TEMPORARY 4 INCH WHITE LINE, PAINT  
 STA. c 40+50 - STA. c 46+25 (SOLID LT & RT)

DURABLE 4 INCH YELLOW LINE (SEE OPTION ITEMS)  
 STA. c 40+50 - STA. c 46+25 (SOLID LT & RT)

TEMPORARY 4 INCH YELLOW LINE, PAINT  
 STA. c 40+50 - STA. c 46+25 (SOLID LT & RT)

**NOTE:**  
 EXISTING BURIED FIBER OPTIC CABLES HAVE  
 BEEN ABANDONED WITHIN PROJECT LIMITS

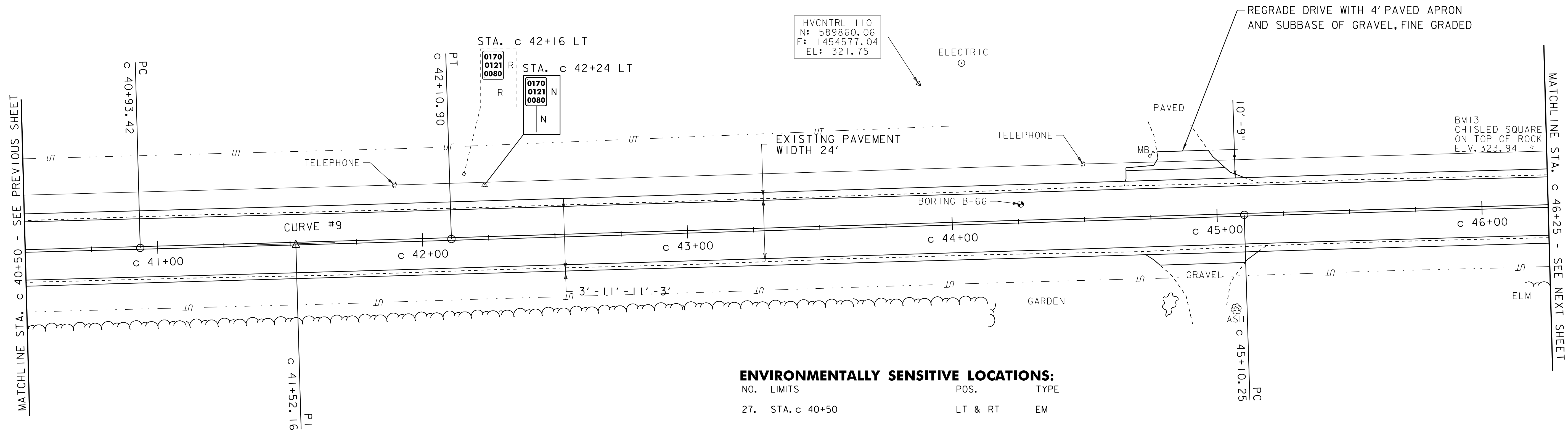
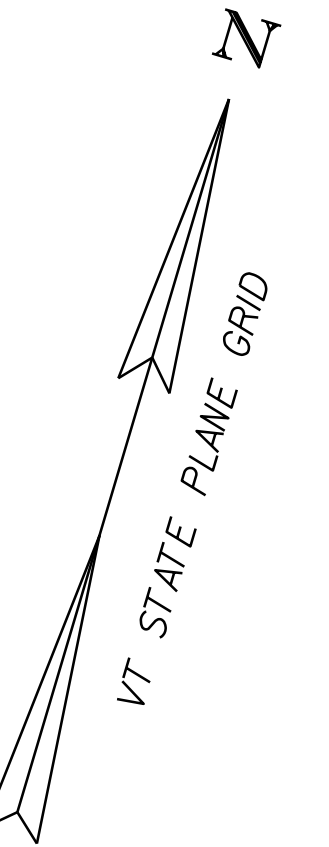

**ENVIRONMENTALLY SENSITIVE LOCATIONS:**

| NO. | LIMITS       | POS.    | TYPE |
|-----|--------------|---------|------|
| 27. | STA. c 40+50 | LT & RT | EM   |

**KEY:**  
 EM - EMERGENT WETLAND  
 FO - FORESTED WETLAND  
 SS - SCRUB-SHRUB WETLAND

**CURVE #9**  
 DELTA = 0° 13' 28"  
 D = 0° 11' 28"  
 R = 30000.00'  
 T = 58.74'  
 L = 117.48'  
 NORMAL CROWN

REMOVING SIGNS  
 AS SHOWN - 1

- LEGEND**
- SIGN
  - HYDRANT
  - MANHOLE
  - GATE VALVE
  - GAS PIPELINE MARKER
  - CATCH BASIN / DROP INLET
  - CURB INLET
  - BORING LOCATION
  - MAILBOX
  - UTILITY POLE
  - FLUSHING BASIN

- SIGN LEGEND**
- R = REMOVE
  - R&S = REMOVE AND SALVAGE
  - RET = RETAIN
  - S = SALVAGE
  - N = NEW
  - B-B = BACK TO BACK

DATUM  
 NAVD 88  
 NAD 83

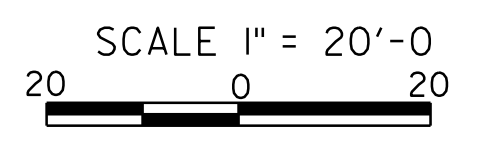

|                                |                                   |                      |
|--------------------------------|-----------------------------------|----------------------|
| <b>PROJECT LAYOUT SHEET 56</b> | PROJECT NAME: ADDISON - NEW HAVEN | PLOT DATE: 3/13/2012 |
|                                | PROJECT NUMBER: STP 9632(1)       | DRAWN BY: SJL        |
|                                | FILE NAME: p95B076.dgn            | CHECKED BY: EPD      |
|                                | DESIGNED BY: SJL                  | SHEET 79 OF 186      |
|                                | PLOT FILE: p95B076.79.i           |                      |