

DURABLE 4 INCH WHITE LINE (SEE OPTION ITEMS)  
 STA. c 34+50 - STA. c 40+50 (SOLID LT & RT)  
 (WITH EDGELINE BREAKS AT TH #1 & TH #17)  
 STA. c 37+30 LT (EDGELINES TH #1)  
 STA. c 37+30 RT (EDGELINES TH #17)  
 TEMPORARY 4 INCH WHITE LINE, PAINT  
 STA. c 34+50 - STA. c 40+50 (SOLID LT & RT)  
 (WITH EDGELINE BREAKS AT TH #1 & TH #17)  
 STA. c 37+30 LT (EDGELINES TH #1)  
 STA. c 37+30 RT (EDGELINES TH #17)

DURABLE 4 INCH YELLOW LINE (SEE OPTION ITEMS)  
 STA. c 34+50 - STA. c 40+50 (SOLID LT & RT)  
 (WITH CENTERLINE BREAKS AT TH #1 & TH #17)  
 STA. c 37+30 LT (CENTERLINE TH #1)  
 STA. c 37+30 RT (CENTERLINE TH #17)

TEMPORARY 4 INCH YELLOW LINE, PAINT  
 STA. c 34+50 - STA. c 40+50 (SOLID LT & RT)  
 (WITH CENTERLINE BREAKS AT TH #1 & TH #17)  
 STA. c 37+30 LT (CENTERLINE TH #1)  
 STA. c 37+30 RT (CENTERLINE TH #17)

CURVE #8  
 DELTA = 0°22'04"  
 D = 0°11'28"  
 R = 30000.00'  
 T = 96.31'  
 L = 192.61'  
 NORMAL CROWN

DURABLE 24 INCH STOP BAR (SEE OPTION ITEMS)  
 STA. c 37+06 - STA. c 37+32 LT (TH #1)  
 STA. c 37+31 - STA. c 37+52 RT (TH #17)  
 TEMPORARY 24 INCH STOP BAR, PAINT  
 STA. c 37+06 - STA. c 37+32 LT (TH #1)  
 STA. c 37+31 - STA. c 37+52 RT (TH #17)  
 DURABLE LETTER OR SYMBOL (SEE OPTION ITEMS)  
 STA. c 37+25 LT "STOP" (TH #1)  
 STA. c 37+37 RT "STOP" (TH #17)  
 TEMPORARY LETTER OR SYMBOL, PAINT  
 STA. c 37+25 LT "STOP" (TH #1)  
 STA. c 37+37 RT "STOP" (TH #17)

STONE FILL, TYPE I  
 STA. c 34+50 - STA. c 36+70 LT  
 GRUBBING MATERIAL  
 STA. c 34+50 - STA. c 36+70 LT  
 GEOTEXTILE FOR SILT FENCE  
 STA. c 34+50 - STA. c 36+70 LT  
 GEOTEXTILE UNDER STONE FILL  
 STA. c 34+50 - STA. c 36+70 LT

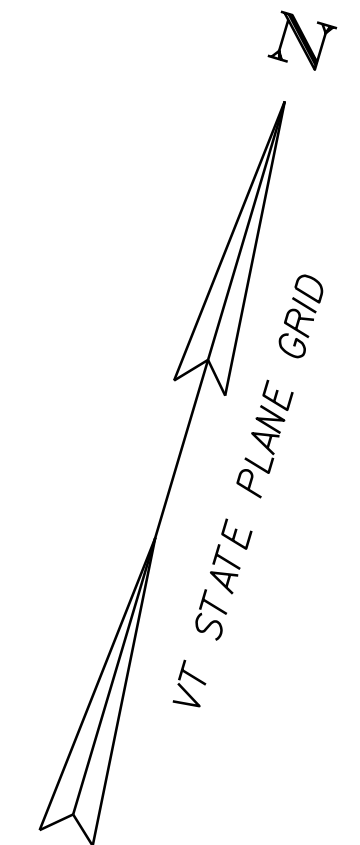

MATCHLINE STA. c 34+50 - SEE PREVIOUS SHEET

MATCHLINE STA. c 40+50 - SEE NEXT SHEET

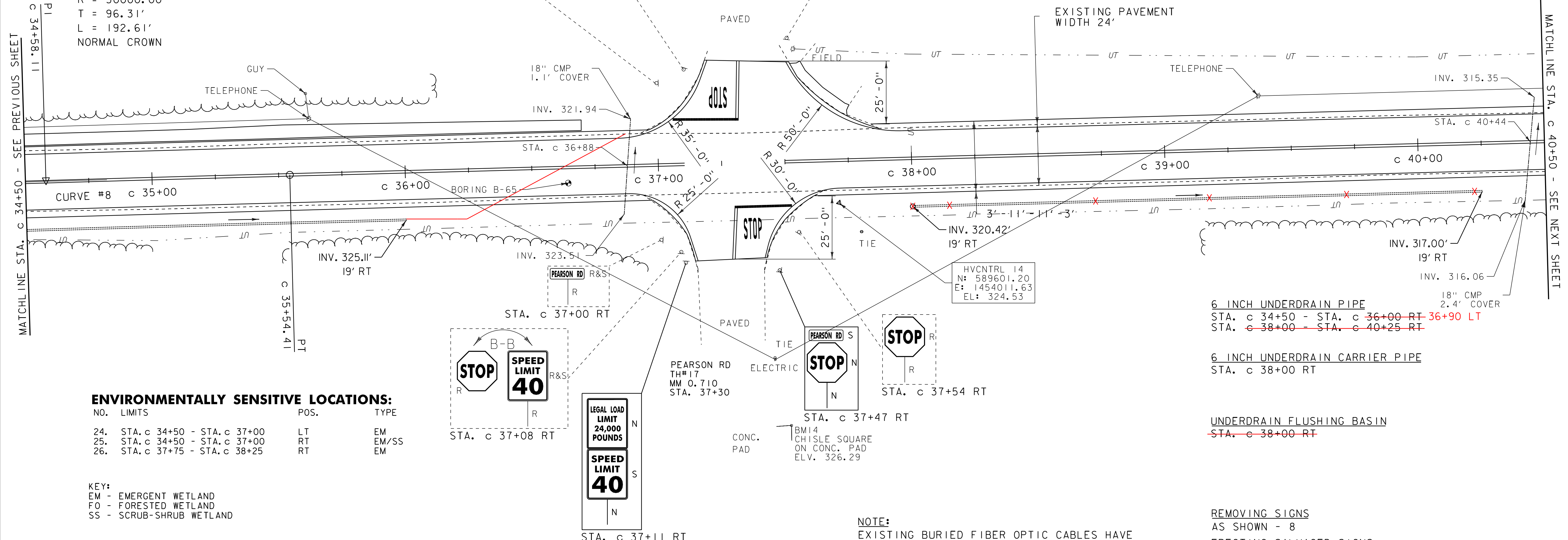

**ENVIRONMENTALLY SENSITIVE LOCATIONS:**

NO.	LIMITS	POS.	TYPE
24.	STA. c 34+50 - STA. c 37+00	LT	EM
25.	STA. c 34+50 - STA. c 37+00	RT	EM/SS
26.	STA. c 37+75 - STA. c 38+25	RT	EM

KEY:  
 EM - EMERGENT WETLAND  
 FO - FORESTED WETLAND  
 SS - SCRUB-SHRUB WETLAND

- LEGEND**
- SIGN
  - HYDRANT
  - MANHOLE
  - GATE VALVE
  - GAS PIPELINE MARKER
  - CATCH BASIN / DROP INLET
  - CURB INLET
  - BORING LOCATION
  - MAILBOX
  - UTILITY POLE
  - FLUSHING BASIN

- SIGN LEGEND**
- R = REMOVE
  - R&S = REMOVE AND SALVAGE
  - RET = RETAIN
  - S = SALVAGE
  - N = NEW
  - B-B = BACK TO BACK

**NOTE:**  
 EXISTING BURIED FIBER OPTIC CABLES HAVE BEEN ABANDONED WITHIN PROJECT LIMITS

6 INCH UNDERDRAIN PIPE  
 STA. c 34+50 - STA. c ~~36+00 RT~~ 36+90 LT  
 STA. c ~~38+00~~ - STA. c 40+25 RT

6 INCH UNDERDRAIN CARRIER PIPE  
 STA. c 38+00 RT

UNDERDRAIN FLUSHING BASIN  
~~STA. c 38+00 RT~~

REMOVING SIGNS  
 AS SHOWN - 8  
 ERECTING SALVAGED SIGNS  
 AS SHOWN - 3

DATUM

NAVD 88
NAD 83

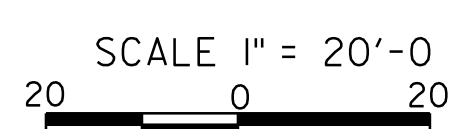

<b>PROJECT LAYOUT SHEET 55</b>	PROJECT NAME: ADDISON - NEW HAVEN
	PROJECT NUMBER: STP 9632(1)
FILE NAME: p95B076.dgn	PLOT DATE: 3/13/2012
PROJECT LEADER: CDL	DRAWN BY: SJL
DESIGNED BY: SJL	CHECKED BY: EPD
PLOT FILE: p95B076.78.1	SHEET 78 OF 186