

DURABLE 4 INCH WHITE LINE (SEE OPTION ITEMS)
 STA. a 9+50 - STA. a 11+34.06 (SOLID LT & RT)
 STA. b 0+00 - STA. b 3+75 (SOLID LT & RT)

TEMPORARY 4 INCH WHITE LINE, PAINT
 STA. a 9+50 - STA. a 11+34.06 (SOLID LT & RT)
 STA. b 0+00 - STA. b 3+75 (SOLID LT & RT)

DURABLE 4 INCH YELLOW LINE (SEE OPTION ITEMS)
 STA. a 9+50 - STA. a 11+34.06 (SOLID LT & RT)
 STA. b 0+00 - STA. b 3+75 (SOLID LT & RT)

TEMPORARY 4 INCH YELLOW LINE, PAINT
 STA. a 9+50 - STA. a 11+34.06 (SOLID LT & RT)
 STA. b 0+00 - STA. b 3+75 (SOLID LT & RT)

A 9+70 - A 10+32.5 RT
 A 10+20 - A 10+32.5 LT
 B 1+90.5
 B 1+90.5

STEEL BEAM GUARDRAIL, GALVANIZED W/8 FEET POSTS

~~STA. a 9+68 - STA. a 10+36.75 RT~~
~~STA. a 10+18 - STA. a 10+36.75 LT~~
~~STA. b 1+87.75 - STA. b 3+75 LT~~
~~STA. b 1+87.75 - STA. b 3+75 RT~~

ANCHOR FOR STEEL BEAM RAIL

~~STA. a 9+68.00 RT - A 9+70 RT~~
~~STA. a 10+18.00 LT - A 10+20 LT~~

STEEL BEAM GUARDRAIL/NESTED W/ 8' POST
 B 1+40.5 - B 1+53 LT

HD STEEL BEAM GUARDRAIL, GALVANIZED W/8 FEET POSTS

~~STA. a 10+36.75 - STA. a 10+68 LT~~
~~STA. a 10+36.75 - STA. a 10+68 RT~~
~~STA. b 1+56.50 - STA. b 1+87.75 LT~~
~~STA. b 1+56.50 - STA. b 1+87.75 RT~~
 A 10+32.5 - A 10+70 RT
 A 10+32.5 - A 10+70 LT
 B 1+53 - B 1+90.5 RT
 B 1+53 - B 1+90.5 LT
 STA. b 1+63 LT

REMOVAL AND DISPOSAL OF GUARDRAIL

STA. a 10+20 - STA. a 10+39 LT
 STA. a 9+70 - STA. a 10+39 RT
 STA. b 1+87.75 - STA. b 3+75 LT
 STA. b 1+87.75 - STA. b 3+75 RT

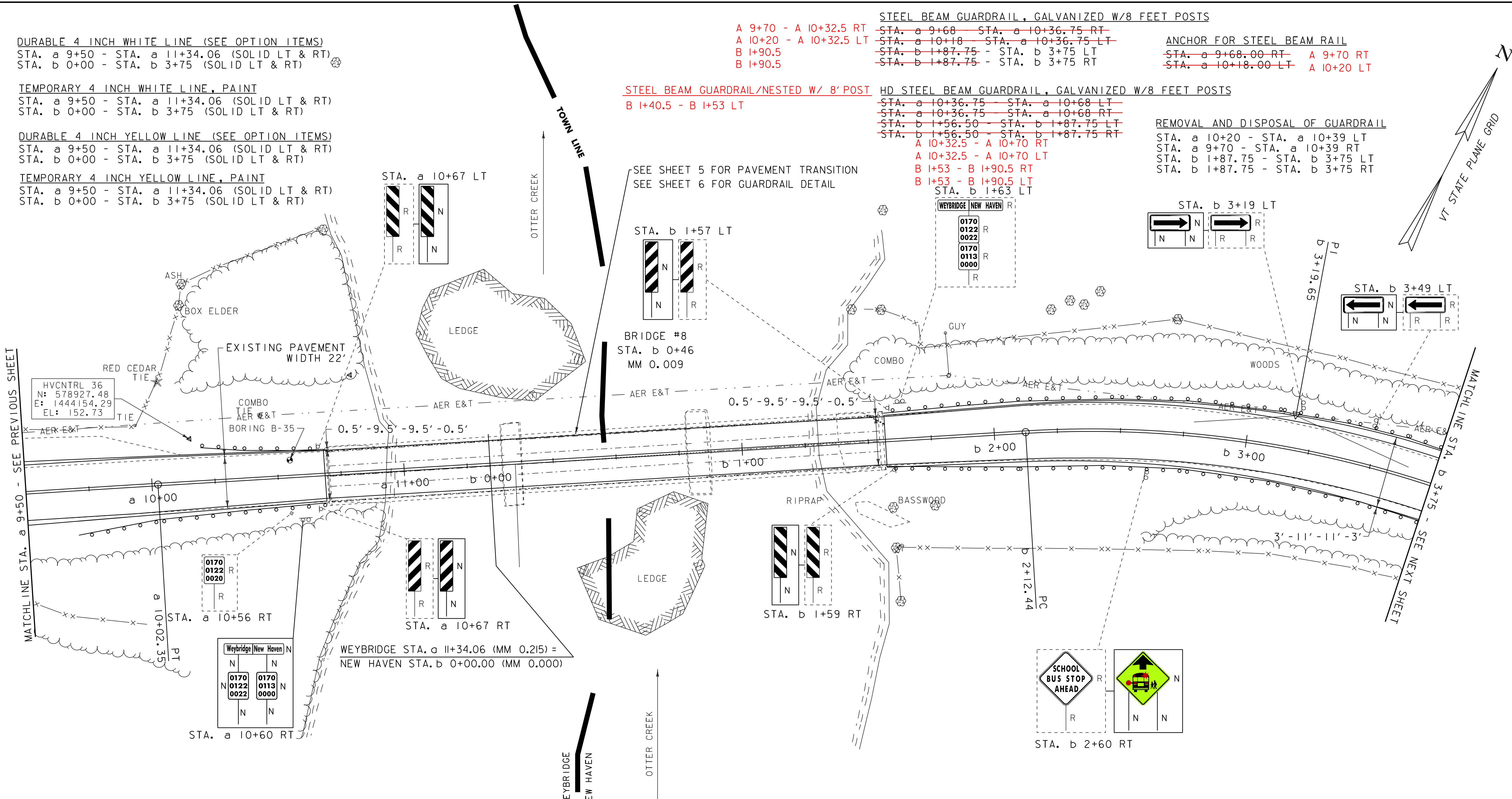

MATCHLINE STA. a 9+50 - SEE PREVIOUS SHEET

MATCHLINE STA. b 3+75 - SEE NEXT SHEET

DATUM	NAVD 88
	NAD 83

- LEGEND**
- SIGN
 - HYDRANT
 - MANHOLE
 - GATE VALVE
 - GAS PIPELINE MARKER
 - CATCH BASIN / DROP INLET
 - CURB INLET
 - BORING LOCATION
 - MAILBOX
 - UTILITY POLE
 - FLUSHING BASIN

- SIGN LEGEND**
- R = REMOVE
 - R&S = REMOVE AND SALVAGE
 - RET = RETAIN
 - S = SALVAGE
 - N = NEW
 - B-B = BACK TO BACK

ENVIRONMENTALLY SENSITIVE LOCATIONS:

NO.	LIMITS	POS.	TYPE
13.	STA. b 1+75 - STA. b 3+75	RT	EM
14.	STA. b 1+75 - STA. b 3+25	LT	EM

REMOVING SIGNS
 AS SHOWN - 11

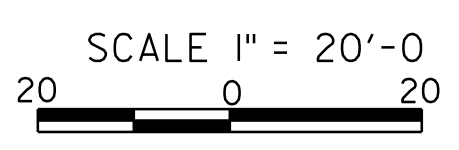

PROJECT LAYOUT SHEET 28	PROJECT NAME: ADDISON - NEW HAVEN
	PROJECT NUMBER: STP 9632(1)
FILE NAME: p95B076.dgn	PLOT DATE: 3/13/2012
PROJECT LEADER: CDL	DRAWN BY: SJL
DESIGNED BY: SJL	CHECKED BY: EPD
PLOT FILE: p95B076.51.i	SHEET 51 OF 186