

STONE FILL, TYPE I
 STA. 517+25 - STA. 518+25 LT
 STA. 520+25 - STA. 521+25 LT
 STA. 522+25 - STA. 522+75 LT

GRUBBING MATERIAL
 STA. 517+25 - STA. 518+25 LT
 STA. 520+25 - STA. 521+25 LT
 STA. 522+25 - STA. 522+75 LT

GEOTEXTILE FOR SILT FENCE
 STA. 517+25 - STA. 518+25 LT
 STA. 520+25 - STA. 521+25 LT
 STA. 522+25 - STA. 522+75 LT

GEOTEXTILE UNDER STONE FILL
 STA. 517+25 - STA. 518+25 LT
 STA. 520+25 - STA. 521+25 LT
 STA. 522+25 - STA. 522+75 LT

DURABLE 4 INCH WHITE LINE (SEE OPTION ITEMS)
 STA. 517+25 - STA. 522+75 (SOLID LT & RT)

TEMPORARY 4 INCH WHITE LINE, PAINT
 STA. 517+25 - STA. 522+75 (SOLID LT & RT)

STEEL BEAM GUARDRAIL, GALVANIZED W/8 FEET POSTS
 STA. 519+76.75 - STA. 521+20.5 RT
 STA. 520+51.25 - STA. 521+07.5 LT
 STA. 521+32.5 - STA. 522+75 LT
 STA. 521+45.5 - STA. 522+01.75 RT

STEEL BEAM GUARDRAIL, GALVANIZED W/8 FEET POSTS
 STA. 521+52.75 - STA. 522+75 LT
 GALVANIZED/NESTED W/8 FEET POSTS RT

STA. 521+20.5 - STA. 521+45.5 RT
 STA. 521+07.5 - STA. 521+32.5 LT

ANCHOR FOR STEEL BEAM RAIL
 STA. 519+76.75 RT
 STA. 520+51.25 LT
 STA. 522+01.75 RT

519+72 RT
 520+59 LT
 522+09.5 RT

DURABLE 4 INCH YELLOW LINE (SEE OPTION ITEMS)
 STA. 517+25 - STA. 522+75 (SOLID LT & RT)

TEMPORARY 4 INCH YELLOW LINE, PAINT
 STA. 517+25 - STA. 522+75 (SOLID LT & RT)

CURVE #8
 DELTA = 0° 17' 34"
 D = 0° 08' 36"
 R = 40000.00'
 T = 102.23'
 L = 204.46'
 NORMAL CROWN

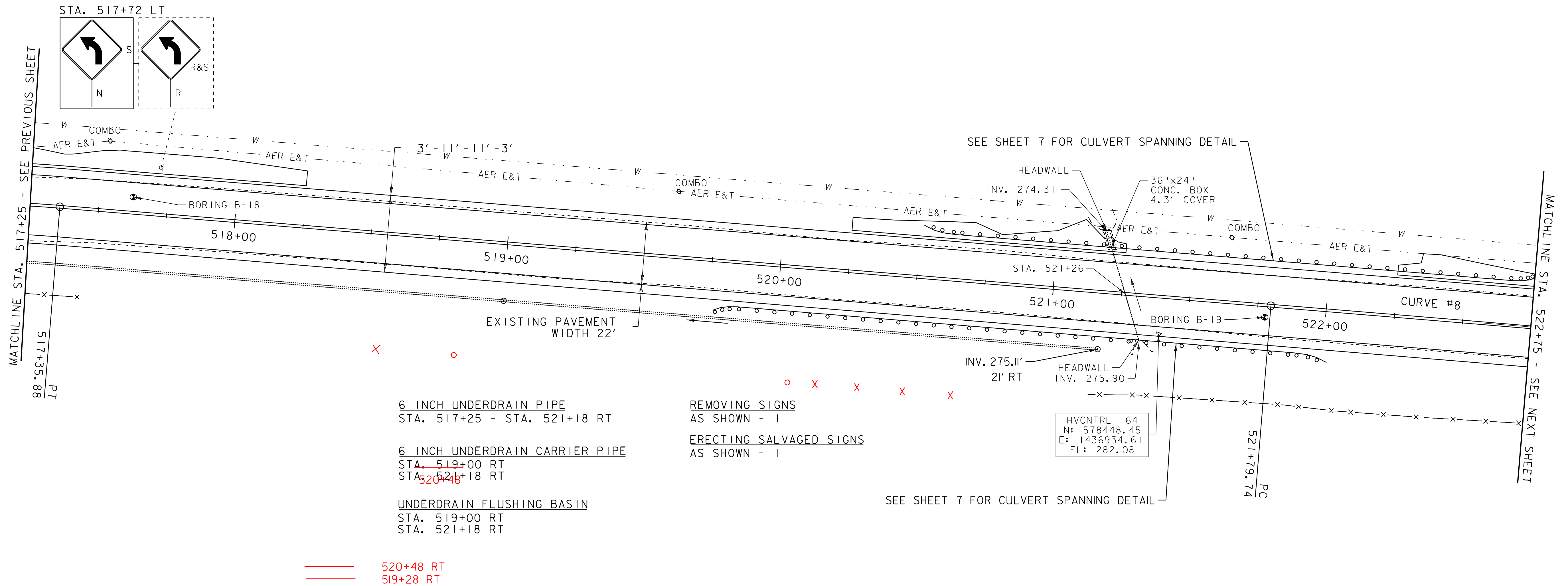
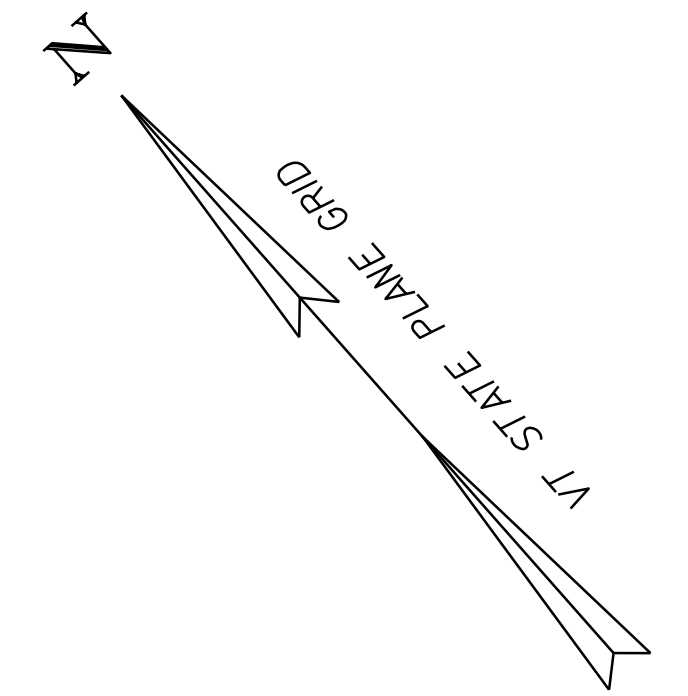

520+48 RT
 519+28 RT

- LEGEND**
- SIGN
 - HYDRANT
 - MANHOLE
 - GATE VALVE
 - GAS PIPELINE MARKER
 - CATCH BASIN / DROP INLET
 - = CURB INLET
 - BORING LOCATION
 - ⊕ MAILBOX
 - ⊕ UTILITY POLE
 - FLUSHING BASIN

- SIGN LEGEND**
- R = REMOVE
 - R&S = REMOVE AND SALVAGE
 - RET = RETAIN
 - S = SALVAGE
 - N = NEW
 - B-B = BACK TO BACK

DATUM
 NAVD 88
 NAD 83

SCALE 1" = 20'-0"
 20 0 20

PROJECT LAYOUT SHEET 14

PROJECT NAME: ADDISON - NEW HAVEN
 PROJECT NUMBER: STP 9632(1)

FILE NAME: p95B076.dgn
 PROJECT LEADER: CDL
 DESIGNED BY: SJL
 PLOT FILE: p95B076_37.1

PLOT DATE: 3/13/2012
 DRAWN BY: SJL
 CHECKED BY: EPD
 SHEET 37 OF 186