

THE FINAL CONFIGURATION OF THE ACCESS DRIVE SHALL BE LAID OUT IN THE FIELD AND SHALL GENERALLY FOLLOW THE EXISTING GROUND EXCEPT FILL SHALL BE ADDED TO PROVIDE A CONSTANT GRADE BETWEEN STATIONS 29+50 TO 31+50.

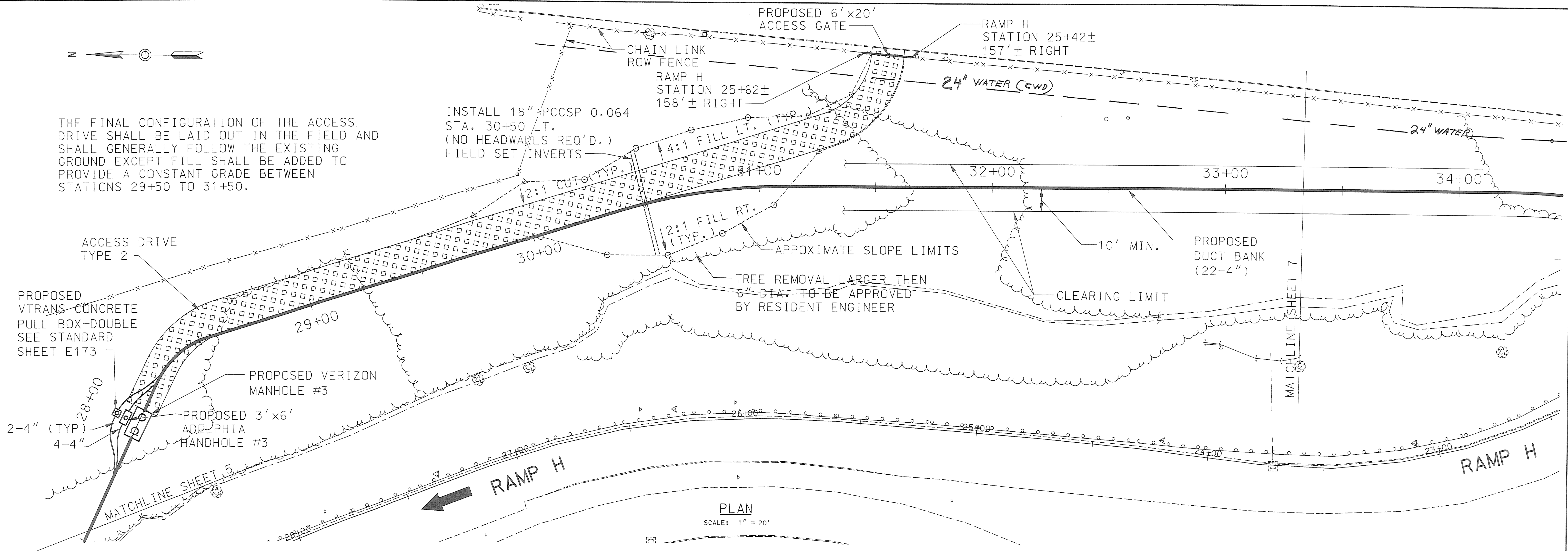

PLAN  
SCALE: 1" = 20'

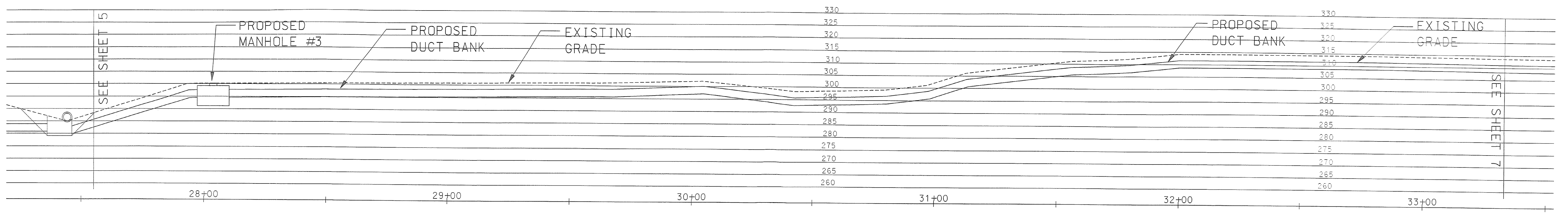

PROFILE  
SCALE: 1" = 20'

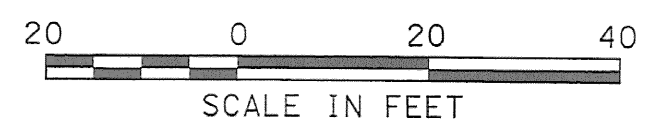

<b>STATE OF VERMONT AGENCY OF TRANSPORTATION</b>		
Town Of	SOUTH BURLINGTON	Bridge No. 68
Highway No.	U. S. 2	Log Sta.
		Surv. Sta.
U. S. 2 OVER I-89		
<b>TELECOMMUNICATIONS RELOCATION</b>		
Designed By	M. HAYES	Drawn By M. HAYES
Checked By	Date	Bridge Design Supervisor S. JOHNSON Date
PROJECT	SOUTH BURLINGTON	PROJECT NO. 1M DECK (36)
I.G.C. Info.	VTRANS-GEN	Date 10/31/01
Bridge Sheet No.	TD 7 OF 8	Sheet 59G of 75

VANASSE HANGEN BRUSTLIN, INC.