

DETAIL OF PARTIAL PARABOLIC CROWN OF SLAB

SHORT STRUCTURE

LONG STRUCTURE

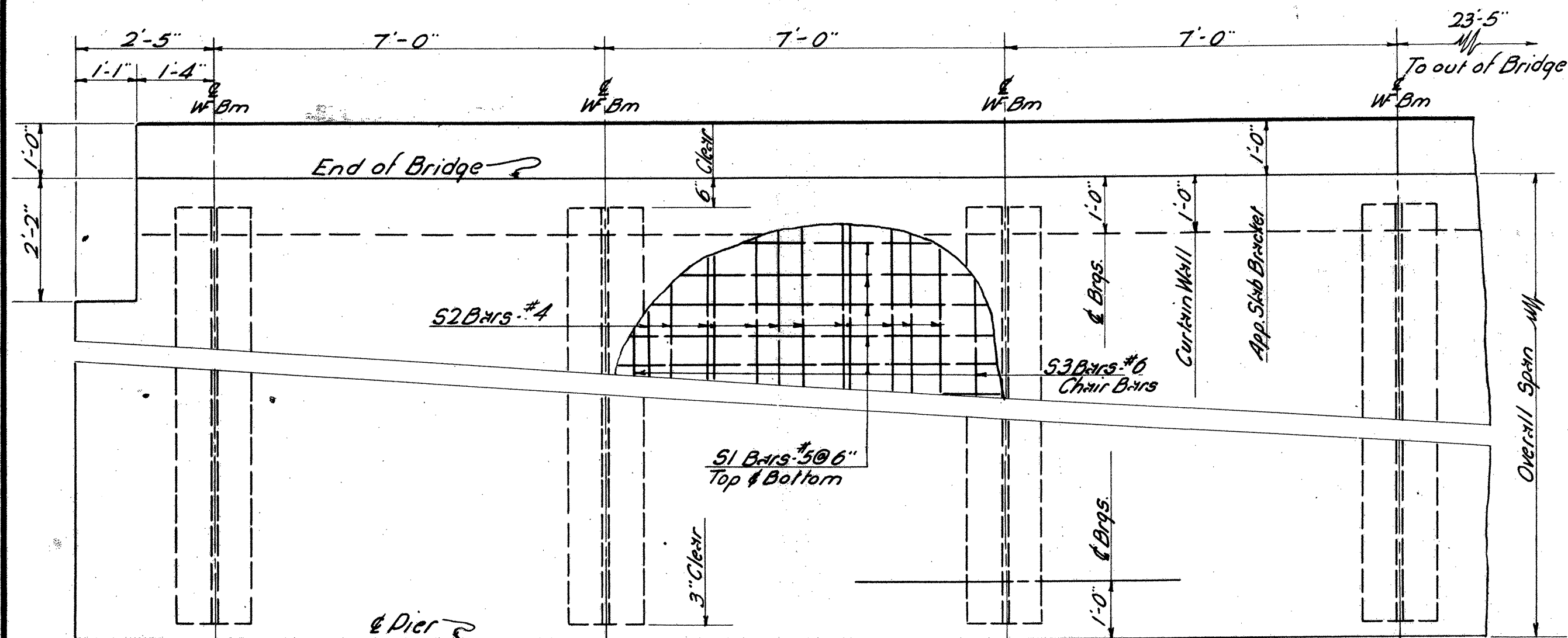

PARTIAL PLAN

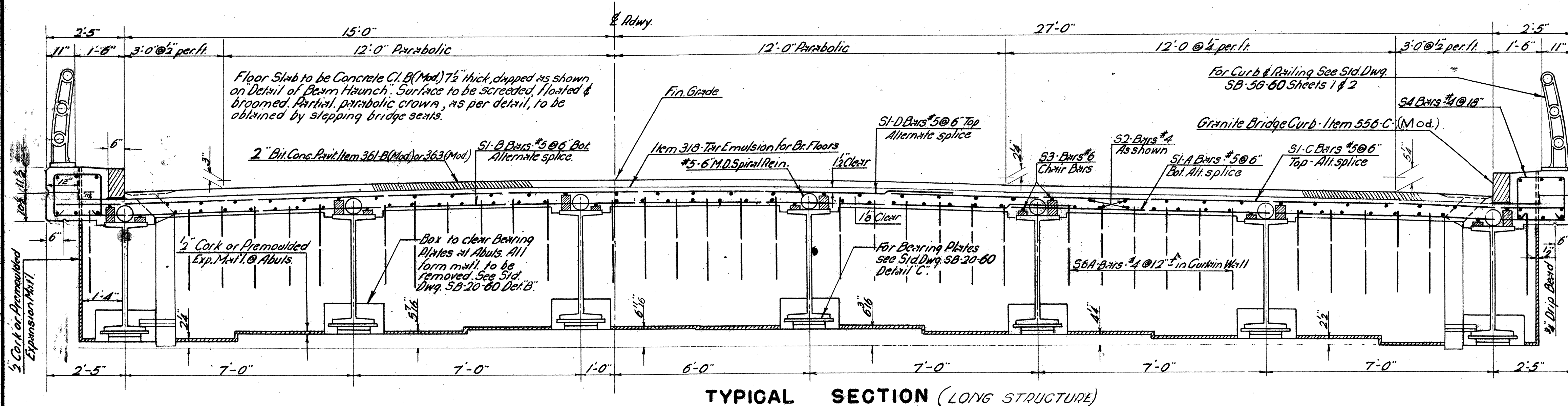

TYPICAL SECTION (LONG STRUCTURE)

TABLE OF QUANTITIES FOR SINGLE (SQUARE) SPAN

Span - Out to Out	99'-0"	94'-0"	89'-0"	84'-0"	79'-0"	74'-0"	69'-0"	64'-0"	59'-0"	54'-0"	49'-0"	44'-0"	39'-0"	34'-0"	
Span - ℓ to ℓ Bearings	97'-0"	92'-0"	87'-0"	82'-0"	77'-0"	72'-0"	67'-0"	62'-0"	57'-0"	52'-0"	47'-0"	42'-0"	37'-0"	32'-0"	
Length of Beams	98'-0"	93'-0"	88'-0"	83'-0"	78'-0"	73'-0"	68'-0"	63'-0"	58'-0"	53'-0"	48'-0"	43'-0"	38'-0"	33'-0"	
Size W Beams	36W300	36W300	36W300	36W245	36W194	36W170	36W160	36W150	36W150	36W150	36W150	36W150	36W150	33W130	30W116
Lqth. & Size Bot. Cover R	6'-0" x 18"	5'-0" x 18"	5'-0" x 18"	5'-0" x 18"	5'-0" x 18"	5'-0" x 18"	5'-0" x 18"	5'-0" x 18"	5'-0" x 18"	5'-0" x 18"	5'-0" x 18"	5'-0" x 18"	5'-0" x 18"	5'-0" x 18"	5'-0" x 18"
Lqth. & Size Top Cover R	6'-0" x 18"	5'-0" x 18"	5'-0" x 18"	5'-0" x 18"	5'-0" x 18"	5'-0" x 18"	5'-0" x 18"	5'-0" x 18"	5'-0" x 18"	5'-0" x 18"	5'-0" x 18"	5'-0" x 18"	5'-0" x 18"	5'-0" x 18"	5'-0" x 18"
Dead Load Deflection	3"	2 1/2"	2 1/2"	2 1/2"	1 7/8"	1 1/2"	1 1/2"	1"	7/8"	5/8"	1/2"	3/8"	1/2"	1/2"	
Diameter of Spiral Bars	3"	3"	3"	3"	3"	3"	3"	3"	3"	3"	3"	3"	3"	3"	
Mean Diameter of Spiral	3"	3"	3"	3"	3"	3"	3"	3"	3"	3"	3"	3"	3"	3"	
Spiral Pitch 0'-10" From Brng.	Double @ 5"	Double @ 5"	Double @ 6"	Double @ 5 1/2"	Double @ 5"	Double @ 5"	Double @ 5"	Double @ 5"	Double @ 5 1/2"	Double @ 5 1/2"	Double @ 5 1/2"	Double @ 5 1/2"	Double @ 5 1/2"	Double @ 5 1/2"	
" " 10'-20" or ℓ Span	Double @ 6 1/2"	Double @ 6 1/2"	Double @ 7"	Double @ 6 1/2"	Double @ 6"	Double @ 6 1/2"	Double @ 6 1/2"	Double @ 6 1/2"	Double @ 7"	Double @ 7 1/2"	Double @ 7 1/2"	Double @ 7 1/2"	Double @ 7 1/2"	Double @ 7 1/2"	
" " 20'-30" " " "	5 1/2"	5 1/2"	5 1/2"	5 1/2"	5 1/2"	5 1/2"	5 1/2"	5 1/2"	5 1/2"	5 1/2"	5 1/2"	5 1/2"	5 1/2"	5 1/2"	
" " 30'-40" " " "	5 1/2"	5 1/2"	5 1/2"	5 1/2"	5 1/2"	5 1/2"	5 1/2"	5 1/2"	5 1/2"	5 1/2"	5 1/2"	5 1/2"	5 1/2"	5 1/2"	
" " 40'- ℓ Span	7"	7"	8"	8"	8"	8"	8"	8"	8"	8"	8"	8"	8"	8"	
Lqth. of 3/4" Studs (Alt. to Spirals)	6 1/2"	6 1/2"	6 1/2"	6 1/2"	6 1/2"	6 1/2"	6 1/2"	6 1/2"	6 1/2"	6 1/2"	6 1/2"	6 1/2"	6 1/2"	6 1/2"	
Total Struct. Steel (lbs)	269,740	237,590	218,700	172,520	138,420	115,910	97,140	82,550	72,740	65,010	58,080	52,730	39,290	30,930	
Reinforcing Bars - S1-A	198	188	178	168	158	148	138	128	118	108	98	88	78	68	
" " S1-B	198	188	178	168	158	148	138	128	118	108	98	88	78	68	
" " S1-C	198	188	178	168	158	148	138	128	118	108	98	88	78	68	
" " S1-D	198	188	178	168	158	148	138	128	118	108	98	88	78	68	
" " S2	264	264	264	264	264	264	264	176	176	176	176	176	176	176	
" " S3	42	42	42	42	42	42	42	28	28	28	28	28	28	14	
" " S4	128	122	114	108	102	94	88	82	74	68	62	54	48	42	
" " S5	32	32	32	32	32	32	32	32	32	32	32	32	32	32	
" " S6A	76	76	76	76	76	76	76	76	76	76	76	76	76	76	
" " S7	62	62	62	62	62	62	62	62	62	62	62	62	62	62	
Total Weight Reinf. Bars (lbs)	30,140	28,710	27,290	25,840	24,400	22,280	21,530	19,900	18,460	17,030	15,600	14,160	12,710	11,080	
Approx. Weight Spiral Reinf. (lbs)	3,570	3,530	3,180	3,310	3,250	3,070	2,920	2,740	2,600	2,360	2,170	Non Composite	Non Composite	Non Composite	
Total Concrete Class B (Cu. yds)	151	144	137	131	124	117	110	103	95	89	82	75	67	59	
Total Weight Bitum. Conc. Pavt. (Tons)	59	56	53	50	47	44	41	38	35	32	29	26	23	20	
Tar Emulsion for Bridge Floors (Gals)	185	176	166	157	148	138	129	120	110	101	92	82	73	64	
Approx. Quantity 3/4" x 6 1/2" Studs	4,150	4,050	3,650	3,800	3,750	3,500	3,300	3,100	3,000	2,700	2,500	Non Composite	Non Composite	Non Composite	

REINFORCING STEEL SCHEDULE

Span	S2-#4	S3-#5	S6A-#4	S4-#4	S6A-#4
Span	Straight	Straight	B & D	T.L. = 5'-3"	T.L. Varies
Length	Length	Length	Total Length	B = 1'-6"	A = 5 G = 5"
34	33'-6"	33'-6"	2'-6"	D = 1'-6"	A G
39	20'-3"	20'-6"	2'-9"	C = 1'-5"	H = 3"
44	22'-9"	23'-0"	3'-0"		
49	25'-3"	25'-6"	3'-0"		
54	27'-9"	28'-0"	3'-0"		
59	30'-3"	30'-6"	3'-0"		
64	32'-9"	33'-0"	3'-0"		
69	24'-3"	24'-6"	3'-2"		
74	26'-0"	26'-3"	3'-2"		
79	27'-6"	28'-0"	3'-3"		
84	29'-3"	29'-6"	3'-3"		
89	31'-0"	31'-3"	3'-3"		
94	32'-6"	33'-0"	3'-4"		
99	34'-3"	34'-6"	3'-4"		

Revisions & Corrections
Revised July 1962

Drawn By: A.B.M. 6-17-60
Traced By: A.B.M. 6-17-60
Checked By: R.T.B. & R.S.H. July 1960
Correct: 13 July 1960
Approved: 13 July 1960

TYPICAL SECTION, PLAN VIEW, & QUANTITIES
42 FOOT ROADWAY W F BEAM BRIDGES
34-44 NON COMPOSITE, 49-99 COMPOSITE
FOR ADDITIONAL DETAILS SEE STANDARD SCB-D-60

DEPARTMENT OF HIGHWAY
STANDARD STRUCTURES
SCB-42-60
SOUTH BURLINGTON IM DECK (36)
FOR REFERENCE ONLY - BRIDGE 68
SHEET 72 OF 75