

**PIER NO. 1 CAP PLAN**  
SCALE: 1/4" = 1'-0"

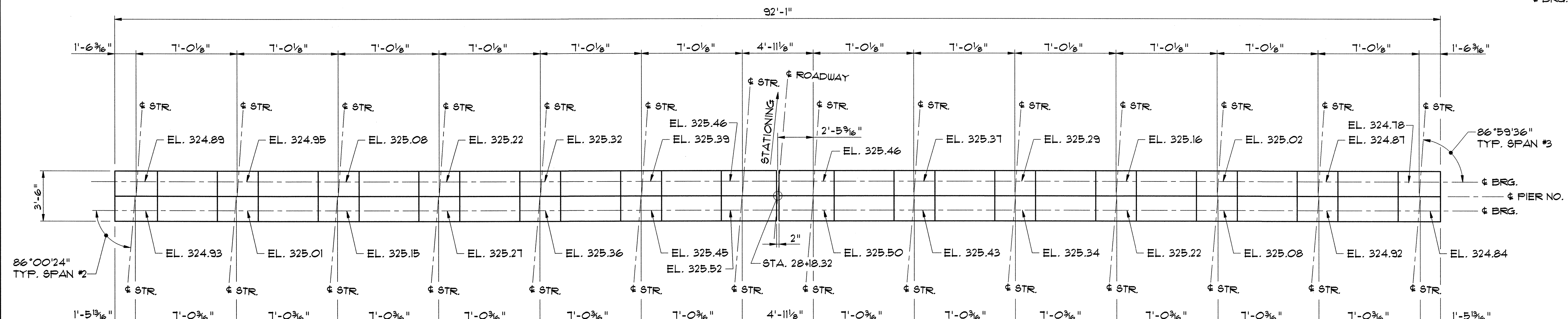

**PIER NO. 2 CAP PLAN**  
SCALE: 1/4" = 1'-0"

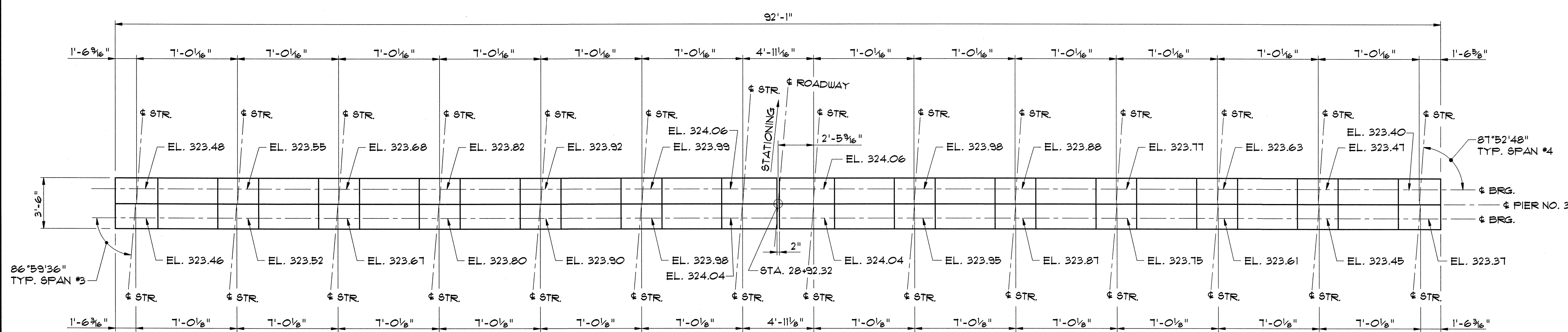

**PIER NO. 3 CAP PLAN**  
SCALE: 1/4" = 1'-0"

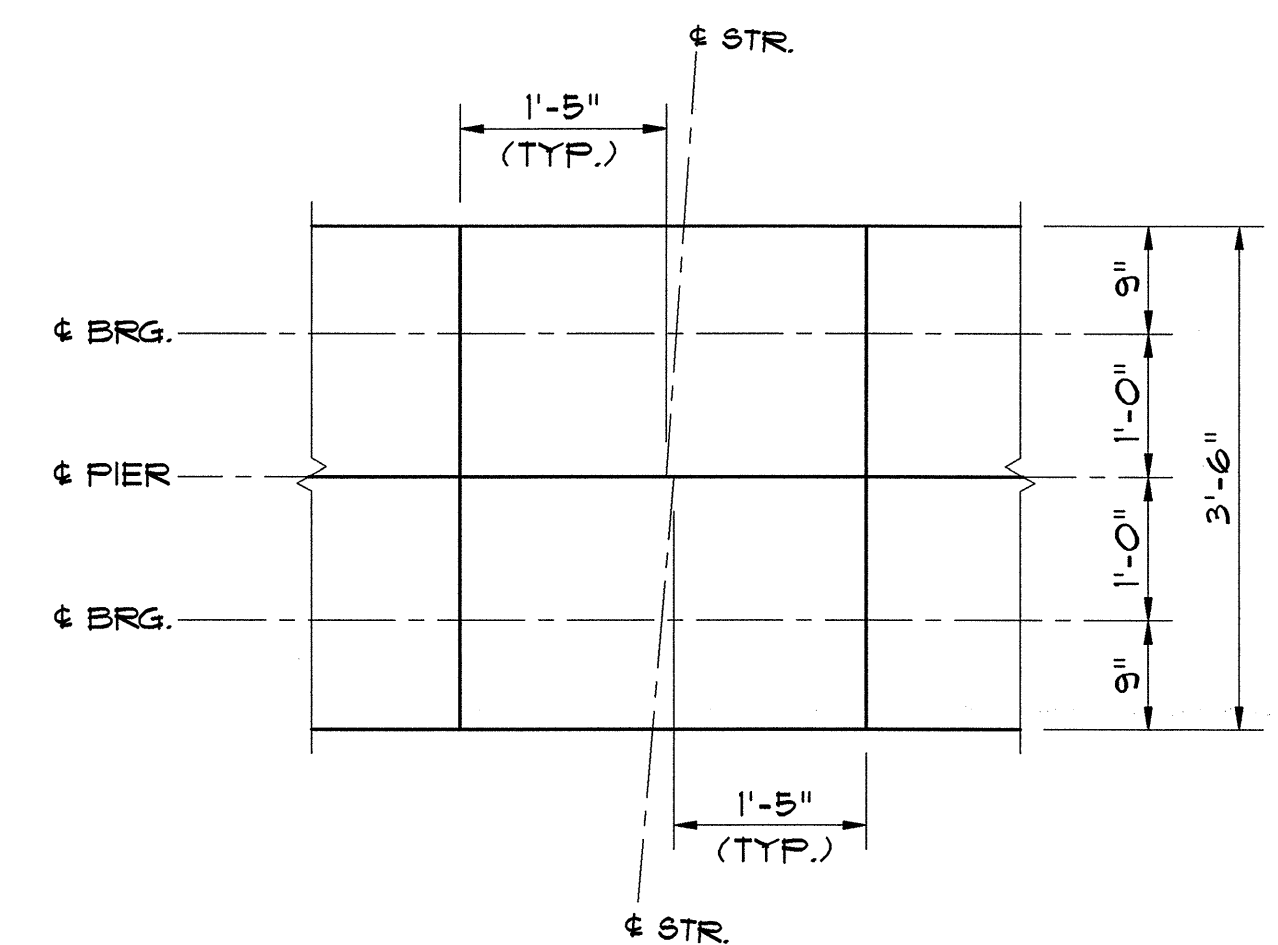

**DETAIL A**  
SCALE: 3/4" = 1'-0"

<b>STATE OF VERMONT AGENCY OF TRANSPORTATION</b>	
Town Of <b>SOUTH BURLINGTON</b>	Bridge No. <b>68</b>
Highway No. <b>U.S. 2</b>	Log Sta. Surv. Sta.
<b>U.S. 2 OVER I-89</b>	
<b>PIER CAP PLAN</b>	
Designed By <b>S.M. HODGDON</b>	Drawn By <b>B.J. MASSE</b>
Checked By <b>T.S. BRYANT</b>	Date <b>1/00</b> Bridge Design Supervisor
<b>C.D. BAKER</b>	Date <b>1/00</b>
PROJECT <b>SOUTH BURLINGTON</b>	PROJECT NO. <b>IM DECK (36)</b>
VHB Cad Drawing No. <b>50929FRPL</b>	Date <b>1/00</b>
Bridge Sheet No.	Sheet <b>30</b> of <b>75</b>

VANASSE HANGEN BRUSTLIN, INC.